



## Installation Instructions Trek Top 2-Door

Vehicle Application:  
Jeep® Wrangler 2-Door JL 2018-Current  
Part Number 56862

### Installation Tips

Before you begin installing your new Trek Top, please read all the instructions thoroughly.



### WARNING

Do not rely in any way on the components of this product to protect against injury or death in the event of an accident. Never operate the vehicle in excess of manufacturer's specifications.

Read and follow, precisely, all installation instructions provided when installing this product. Failure to do so may result in a poor fit and could place occupants of the vehicle in a potentially dangerous situation.



### WEAR SEAT BELTS AT ALL TIMES



### CAUTION

Safety glasses should be worn at all times when installing this product.

### Tools



Safety Glasses



T25 - T40 - T50  
Torx Drivers

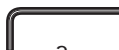

3mm - 4mm -  
5mm  
Hex Keys



Torque Wrench



8mm - 10mm  
Wrenches

- OR -



Socket  
Wrench



8mm - 10mm  
Sockets

### Installation Time



4 hours

### Skill Level



3 - Moderately Difficult

### Support

We're here to help! Go to:  
<https://www.bestop.com>  
and click on **Need Help?**



<https://www.bestop.com/video-library>



## Installation Instructions Trek Top 2-Door

Vehicle Application:  
Jeep® Wrangler 2-Door JL 2018-Current  
Part Number 56862

### Sugerencias de Instalación

**Antes de empezar a instalar esta unidad, lea atentamente todas las instrucciones.**

**Para un buen ajuste:**

Para facilitar la instalación, el producto debe instalarse a temperaturas superiores a 72 °F (22 °C).

Por debajo de esta temperatura, la tela puede encogerse una pulgada o más, lo que dificultaría su ajuste al vehículo.

Es normal que la tela se contraiga o arrugue cuando está guardada en la caja de empaque. A los pocos días después de la instalación, la tela se relajará y las arrugas desaparecerán.



#### ADVERTENCIA

Este producto se diseñó principalmente para mejorar la apariencia del vehículo y proteger a los ocupantes de las condiciones climáticas comunes. De ninguna manera piense que los componentes de este producto pueden servir como medio de contención para los ocupantes del vehículo o que pueden protegerlos contra lesiones o la muerte en caso de accidente. Este producto no protegerá a los ocupantes contra caídas de objetos. Nunca conduzca este vehículo fuera de las especificaciones del fabricante.

#### USE LOS CINTURONES DE SEGURIDAD EN TODO MOMENTO

Lea y siga con precisión todas las instrucciones de instalación que se proporcionan para instalar este producto. Si no lo hace, podría producirse un mal ajuste que colocaría a los ocupantes del vehículo en una situación potencialmente peligrosa.



#### PRECAUCIÓN

Debe usar gafas protectoras en todo momento durante la instalación de este producto.

### Conseils pour l'installation

**Lire toutes les instructions au complet avant de commencer l'installation de cet assemblage.**

**Pour un ajustement sans problème :**

Afin de faciliter l'installation, ce produit doit être installé à des températures au-dessus de 72 °F (22 °C).

Sous cette température, le tissu peut rétrécir d'un pouce (2,5 cm) ou plus, ce qui rendra l'ajustement sur le véhicule difficile.

Il est normal que le tissu rétrécisse et plisse pendant qu'il est dans la boîte d'expédition. En quelques jours après l'installation, le tissu se détendra et les plis disparaîtront.



#### AVERTISSEMENT

Ce produit est conçu principalement pour améliorer l'apparence du véhicule et pour protéger les occupants des conditions météorologiques usuelles. Ne jamais se fier aux composants de ce produit pour se protéger de blessures ou de la mort en cas d'accident. Ce produit ne protégera pas les occupants des chutes d'objets. Ne jamais utiliser le véhicule au-delà des caractéristiques techniques indiquées par le fabricant.

#### PORTER UNE CEINTURE DE SÉCURITÉ EN TOUT TEMPS

Lire et suivre, très fidèlement, toutes les instructions d'installation fournies lors de l'installation de ce produit. Ne pas suivre cette consigne peut causer une installation inadéquate et mettre les occupants du véhicule dans une situation potentiellement dangereuse.



#### MISE EN GARDE

Des lunettes de sécurité doivent être portées en tout temps lors de l'installation de ce produit.



## Parts Kit #576.93P

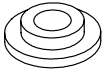

Plastic Bushing  
#473.40  
Qty. 16



M6 Nylon Lock Nut  
#494.01  
Qty. 4



M6 Flat Washer  
#515.81  
Qty. 4



M5 Nylon Lock Nut  
#526.76  
Qty. 8



M5 Flat Washer  
#565.90  
Qty. 16



M5x0.8x25  
Button Head  
Socket Cap Screw  
#579.60  
Qty. 8  
3mm Hex Socket

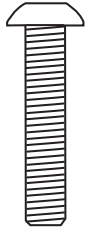

M6x1x15  
Button Head  
Socket Cap Screw  
#517.63  
Qty. 4  
4mm Hex Socket

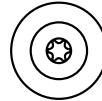
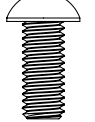

M8x1.25x38  
Button Head  
Socket Cap Screw  
#532.17  
Qty. 2  
T50 Torx

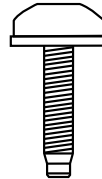

M8x1.25x80  
Screw  
#532.23  
Qty. 4  
T40 Torx

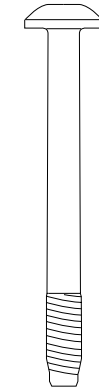

M6x20mm  
Flanged Button Head  
Screw  
#517.48  
Qty. 4  
4mm Hex Socket



M5x0.8x12  
Flanged Button  
Head Cap Screw  
#531.49  
Qty. 4  
T25 Torx

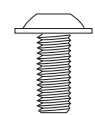

M8x1.25x20mm  
Flanged Button Head  
Cap Screw  
#573.09  
Qty. 12  
T40 Torx

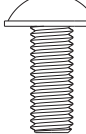

Loctite Capsule  
Part #309.83  
Qty. 1

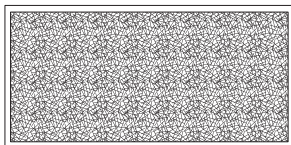

2.5"x2" Hook-&-Loop Strip  
#592.35  
Qty. 6

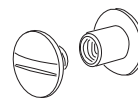

Screw, Binding Barrel  
Part #599.01  
Qty. 2

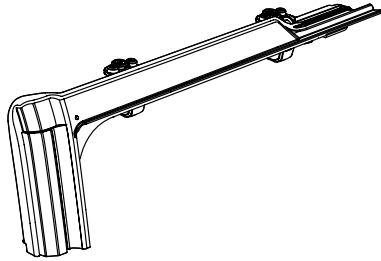

Upper Door Rail  
Part #577.06 - Right  
Qty. 1

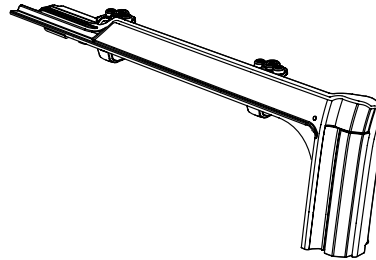

Upper Door Rail  
Part #577.07 - Left  
Qty. 1



Lower Door Rail  
Part #577.08 - Right  
Qty. 1

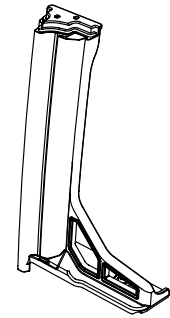

Lower Door Rail  
Part #577.09 - Left  
Qty. 1

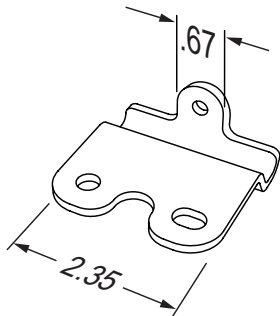

Side Bow Pivot Bracket  
Part #579.96  
Qty. 2

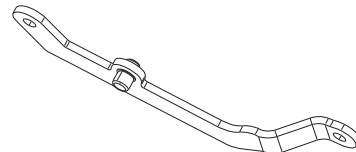

#2 Bow Link Assembly  
Part #578.67 - Left  
Qty. 1

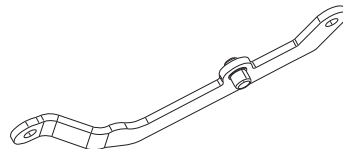

#2 Bow Link Assembly  
Part #578.66 - Right  
Qty. 1

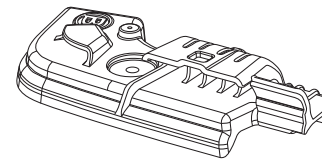

Tailgate Bar Retainer  
Part #575.39 - Left  
Qty. 1

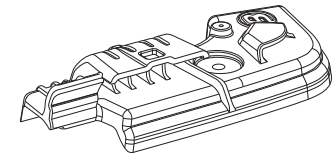

Tailgate Bar Retainer  
Part #575.38 - Right  
Qty. 1

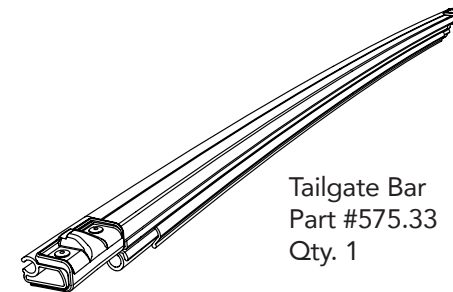

Tailgate Bar  
Part #575.33  
Qty. 1



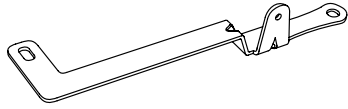

#2 Bow Mount Bracket  
Part #585.46 - Right  
Qty. 1

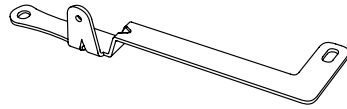

#2 Bow Mount Bracket  
Part #585.47 - Left  
Qty. 1

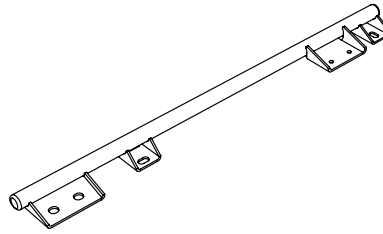

#3 & #4 Bow Mount Bracket  
Part #566.78 - Right  
Qty. 1

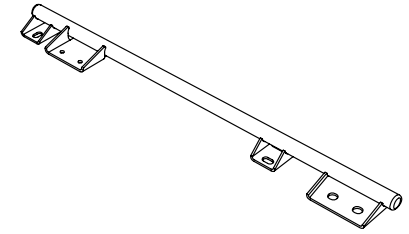

#3 & #4 Bow Mount Bracket  
Part #566.79 - Left  
Qty. 1



#4 Bow Assembly  
Part #566.86  
Qty. 1

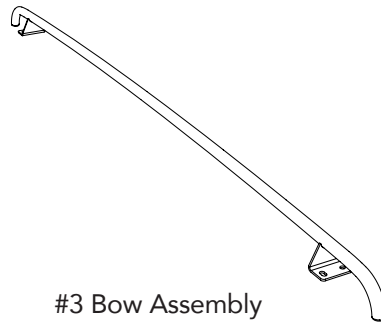

#3 Bow Assembly  
Part #578.98  
Qty. 1

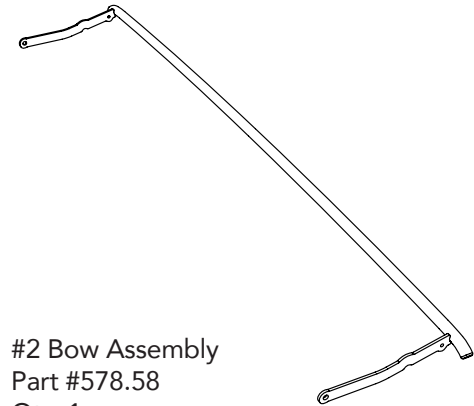

#2 Bow Assembly  
Part #578.58  
Qty. 1

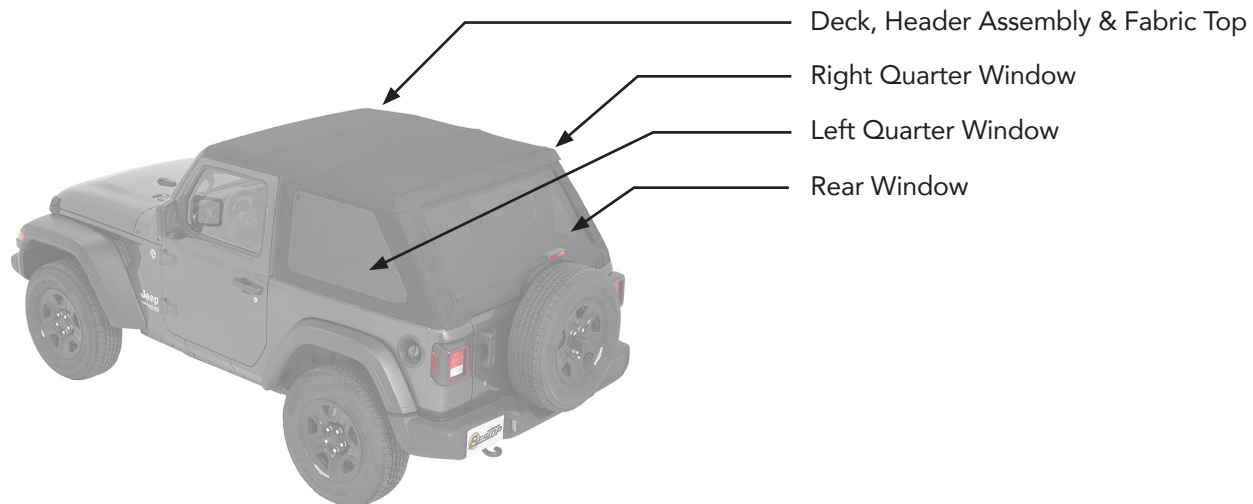

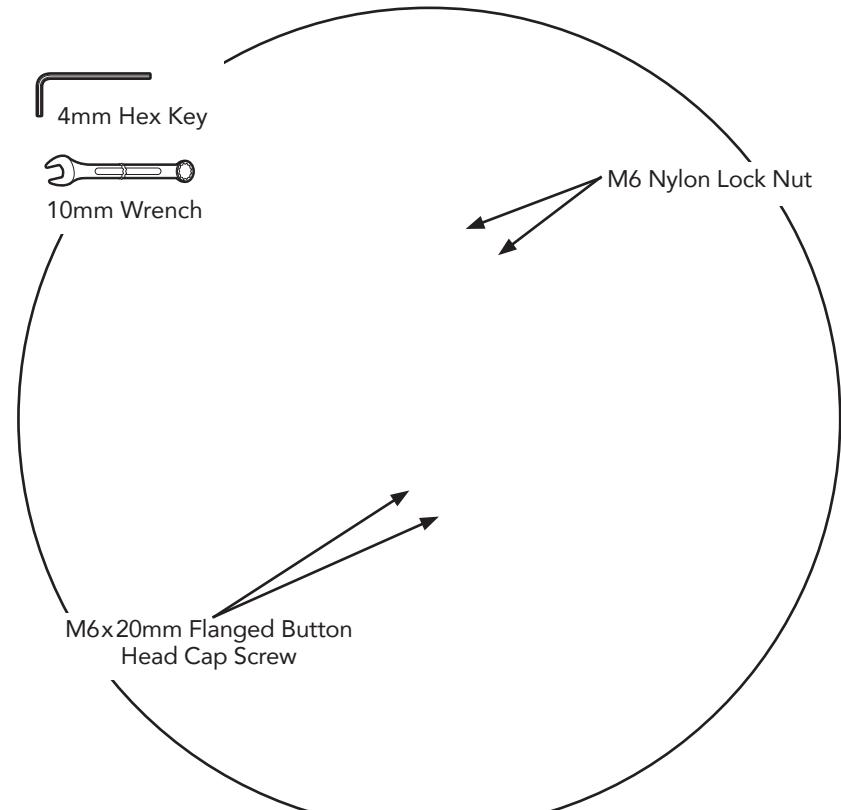
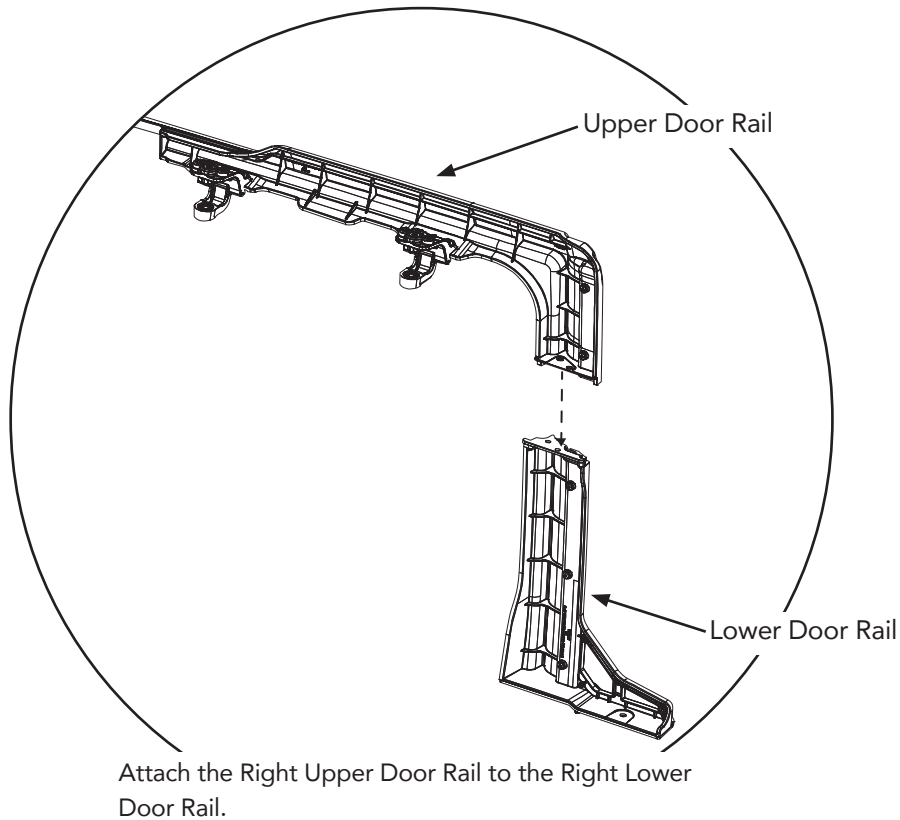

Use two (2) M6 x 20mm Flange Button Head Cap Screws and two (2) M6 Flanged Lock Nuts

**NOTE:** Screws must be inserted from the bottom up.

Repeat this on the Left side Door Rails.

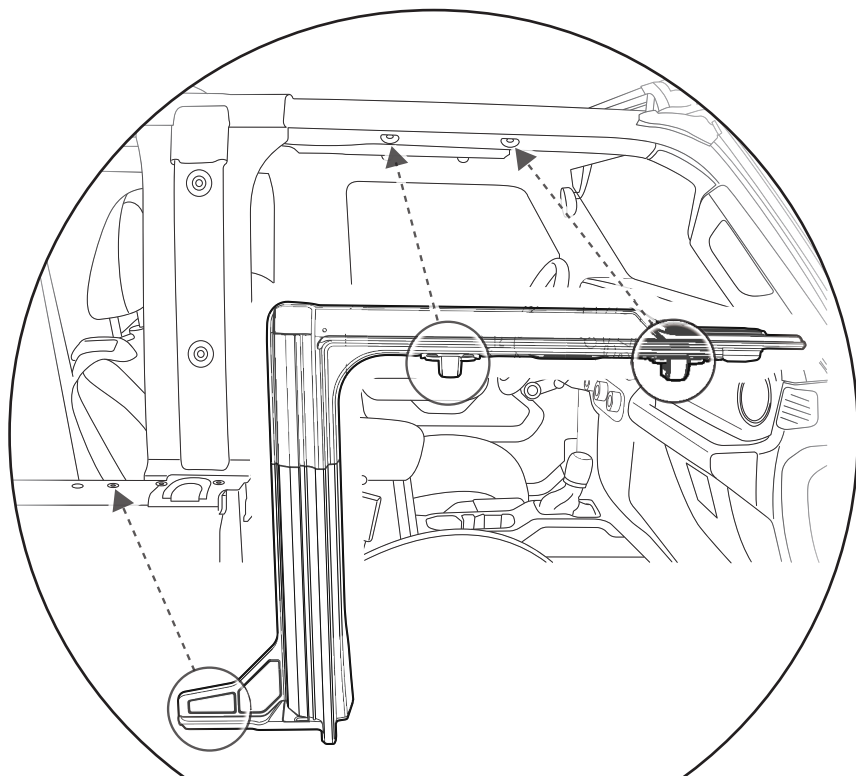

Align the hole in the lower portion of the Assembly with the threaded hole in the Jeep belt rail, the alignment pin on the bottom of the Assembly with the receiving hole in the top of the belt rail, and the two integral brackets along the top of the Assembly with the through-holes in the Jeep Sport Bar.

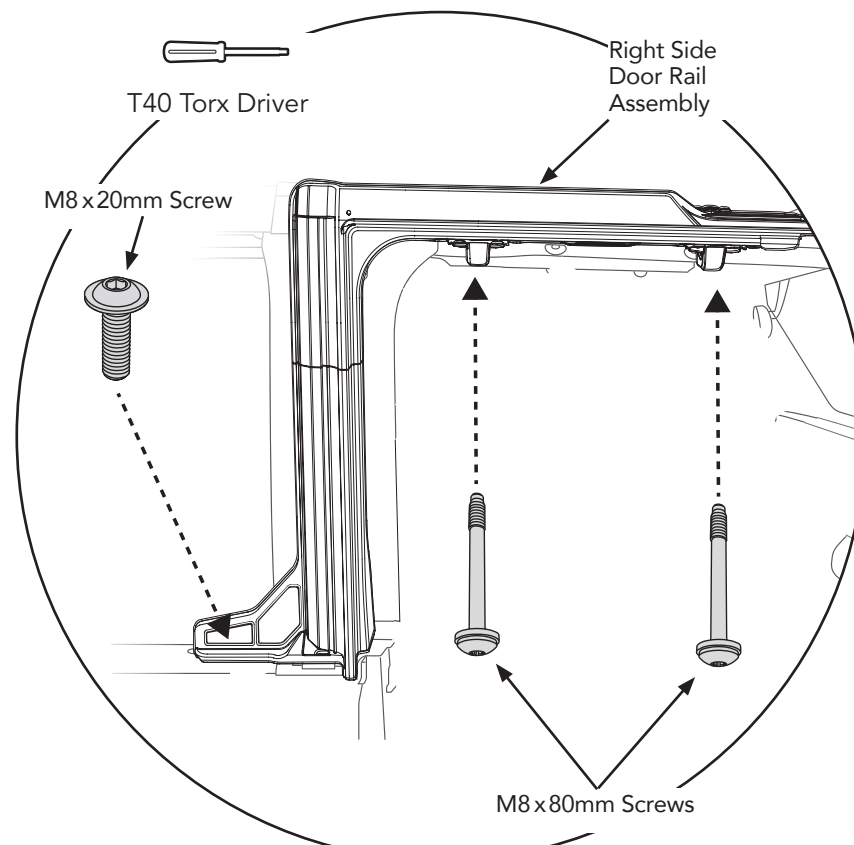

Insert two (2) M8x80 Screws up from the bottom of the integral brackets.

Use one (1) M8x20 screw on each Assembly to secure the Assembly to the Jeep belt rail.  
tighten fasteners to 55 in/lb (4.5 ft/lb).

**Note:** To prevent over torquing, Use a Screwdriver type Torx driver if a torque wrench is not available.

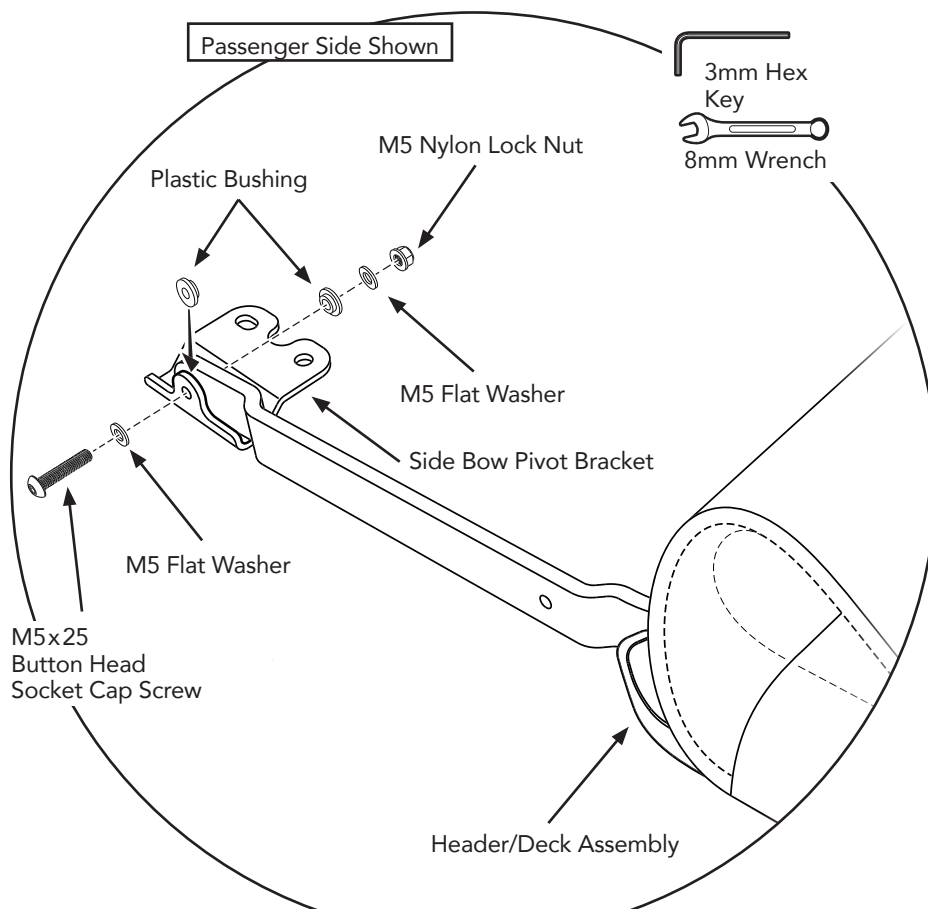

Attach the Side Bow Pivot Brackets to the Side Bows on the Header/Deck Assembly.

The Brackets attach to the end of each Side Bow using one (1) M5x25 Button Head Socket Cap Screw, two (2) Bushings, two (2) M5 Flat Washers and one (1) M5 Nylon Lock Nut on each Side Bow Leg.

The Plastic Bushings go directly on either side of the Side Bow legs, with the larger hole.

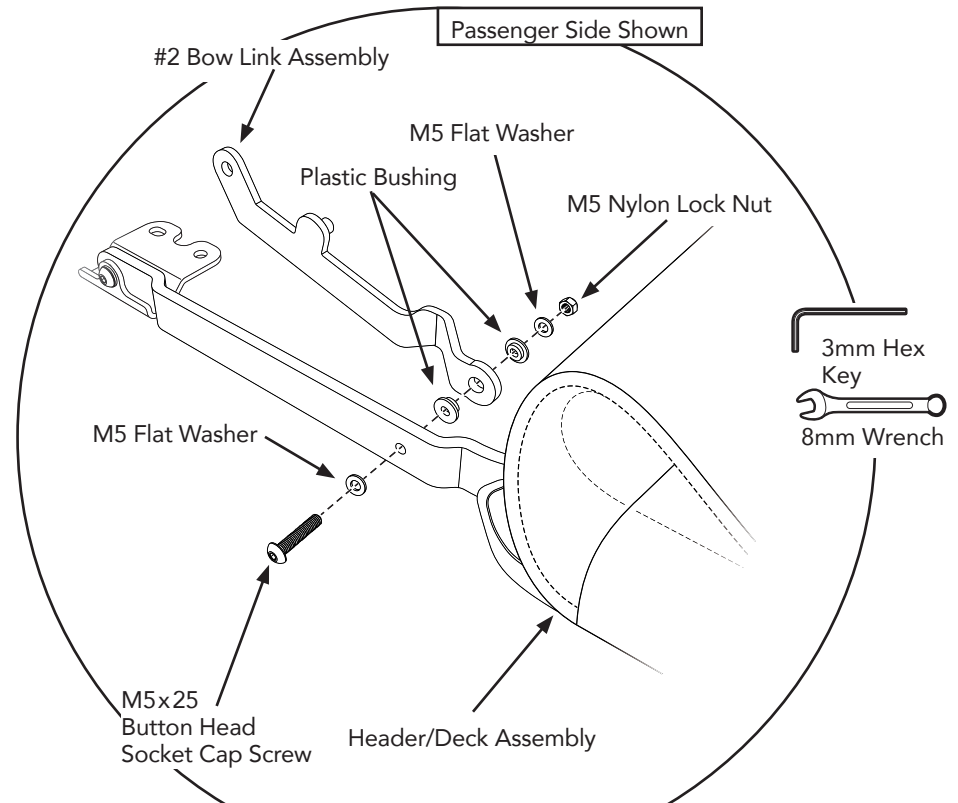

Attach the #2 Bow Link Assemblies to the Side Bows on the Header Assembly. Make sure that the Bow Stop on each Bow Link Assembly faces in.

The Bow Links attach to the end of each Side Bow leg using one (1) M5x25 Button Head Socket Cap Screw, two (2) Bushings, two (2) M5 Flat Washers and one (1) M5 Nylon Lock Nut on each Side Bow Leg.

The Plastic Bushings go directly on either side of the Side Bow legs.

**NOTE:** Leave these snug but not tight. The #2 bow links and side bows must be allowed to move freely.

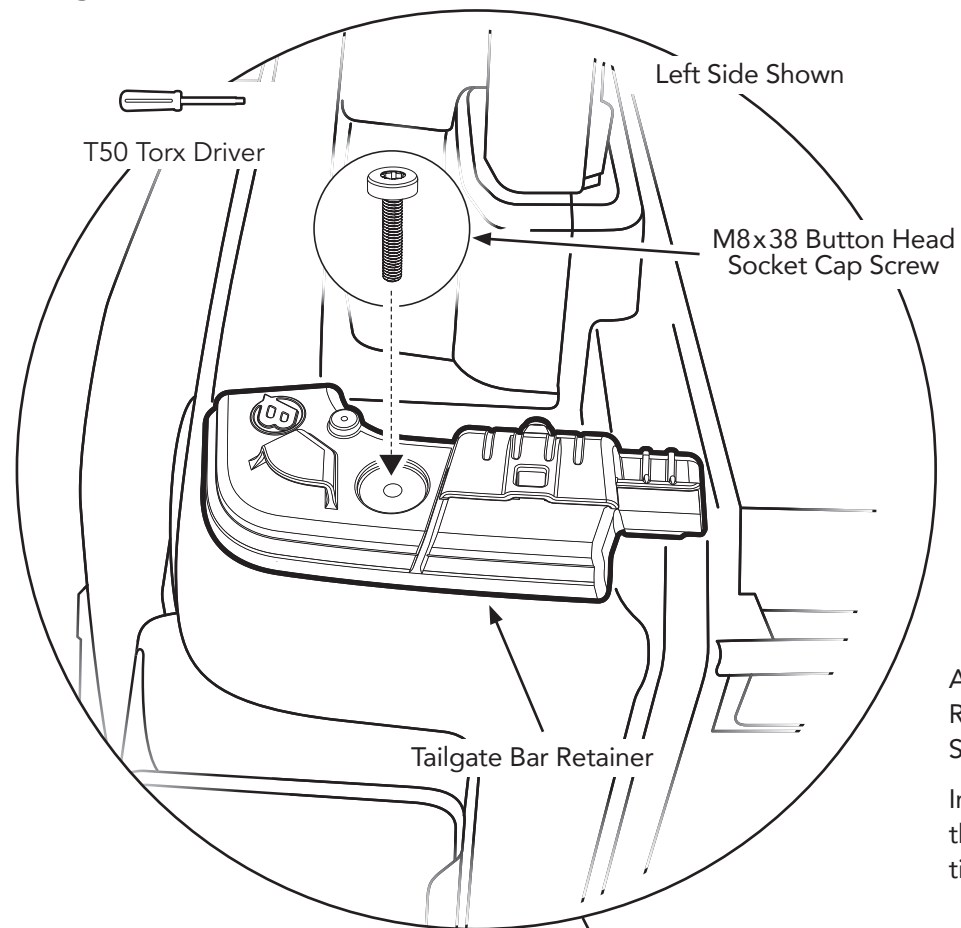

Attach the Tailgate Bar Retainers to the Jeep Belt Rail, using one (1) M8x38 Button Head Socket Cap Screw per retainer.

Insert the screws through the retainers, and into threaded holes in the top of the Jeep belt rail, and tighten.

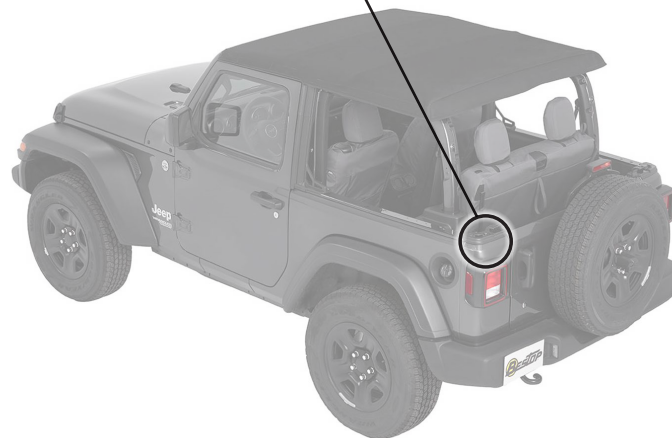

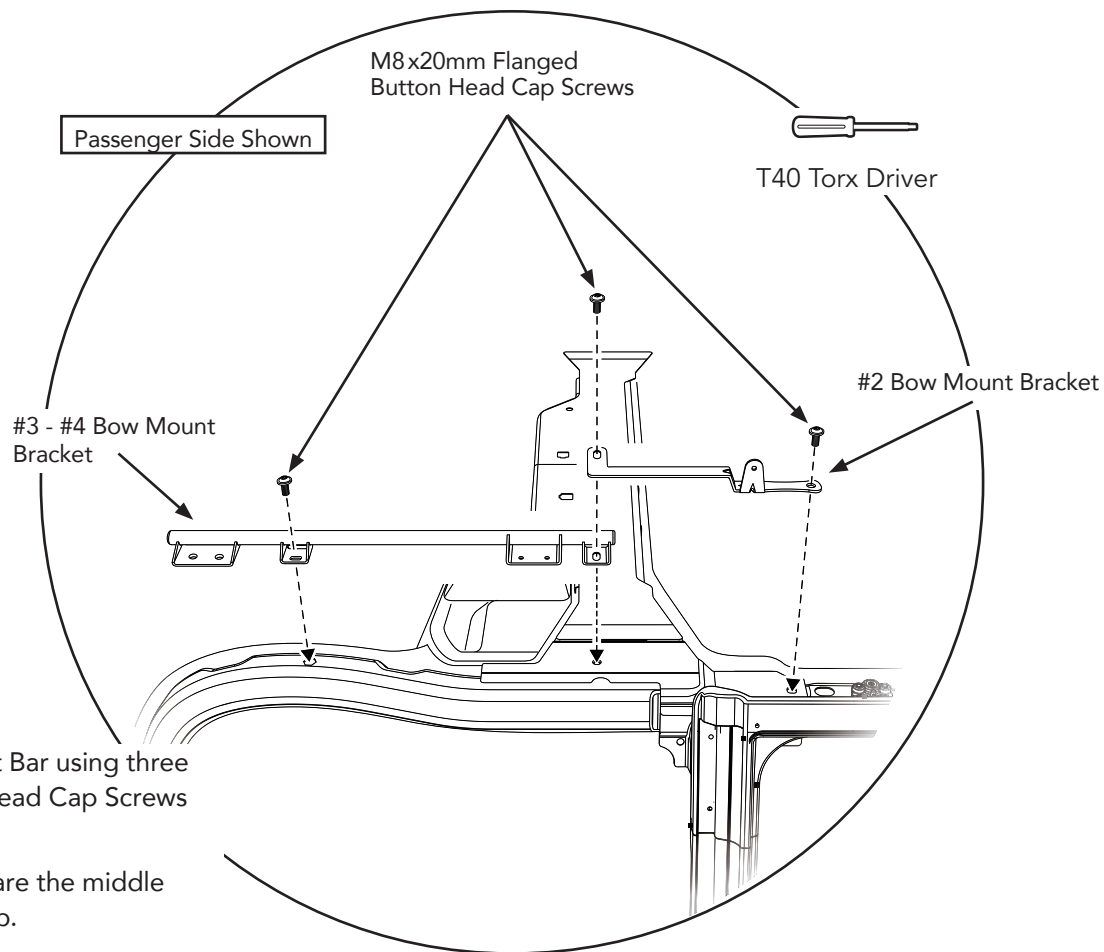

Secure the Brackets to the Sport Bar using three (3) M8x20mm Flanged Button Head Cap Screws on each side of the Jeep.

The Bow Mount Brackets will share the middle fastener on each side of the Jeep.

Do not fully tighten fasteners at this time - tighten these fasteners only after all parts have been adjusted for fit, after Section 10, on page 17 of this guide.

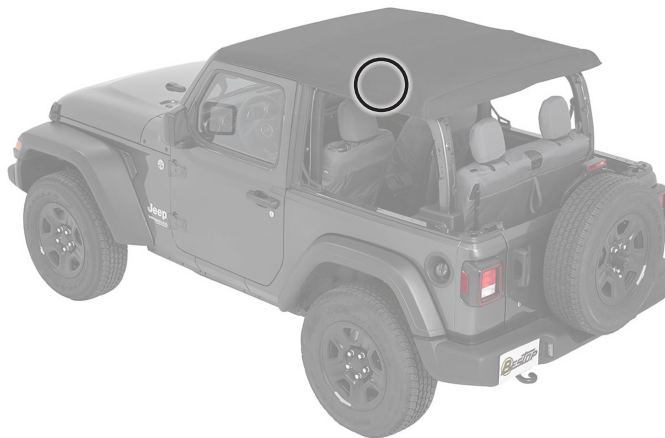

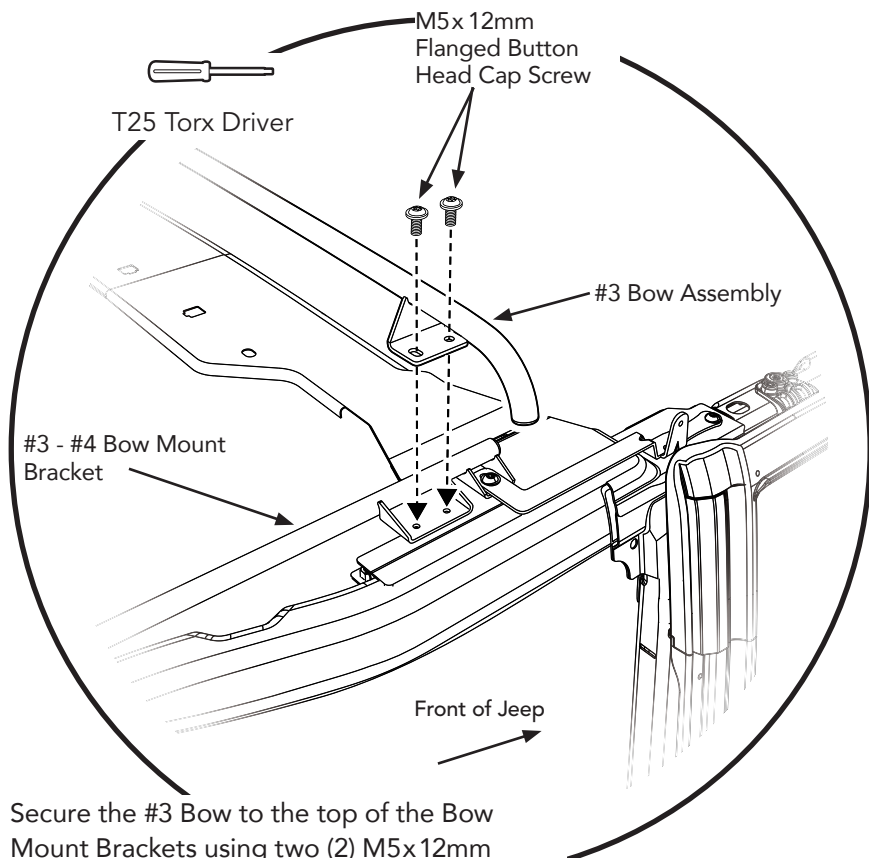

Secure the #3 Bow to the top of the Bow Mount Brackets using two (2) M5x12mm Flanged Button Head Cap Screws on each side of the Jeep.

Do not fully tighten fasteners at this time - tighten these fasteners only after all parts have been adjusted for fit, after Section 10, on page 17 of this guide.

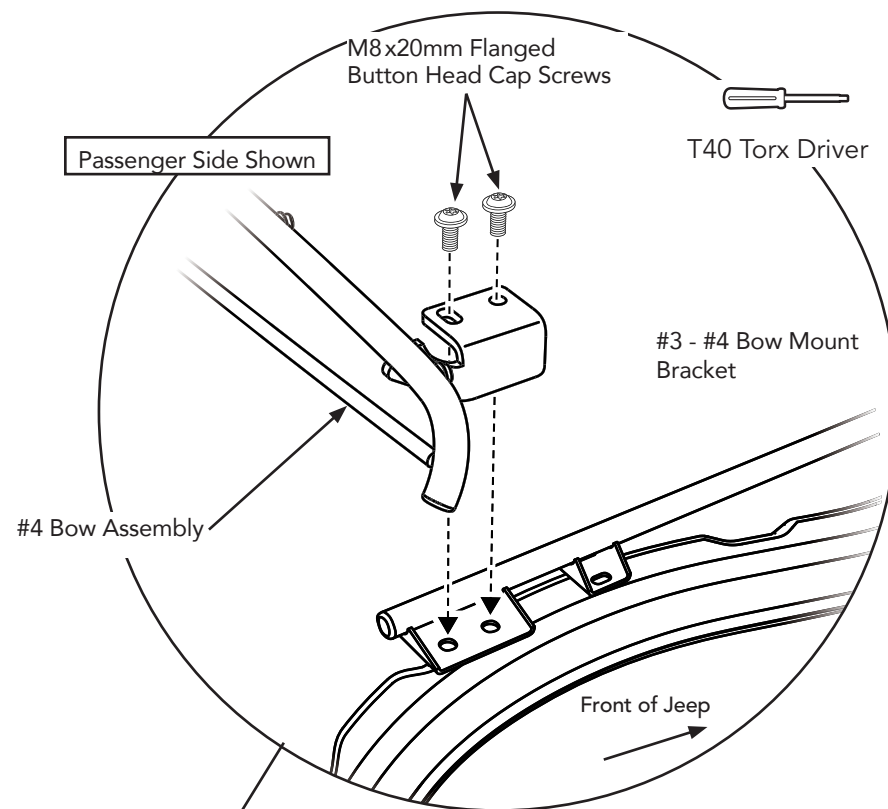

Secure the #4 Bow to the Brackets using two (2) M8x20mm Flanged Button Head Cap Screws on each side of the vehicle.

Do not fully tighten fasteners at this time - tighten these fasteners only after all parts have been adjusted for fit, after Section 10, on page 17 of this guide.

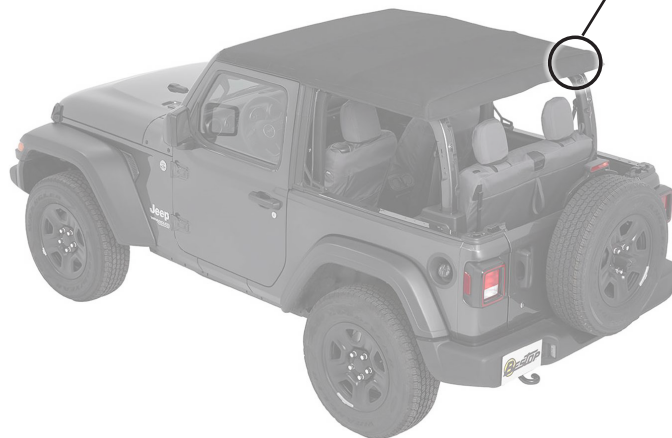



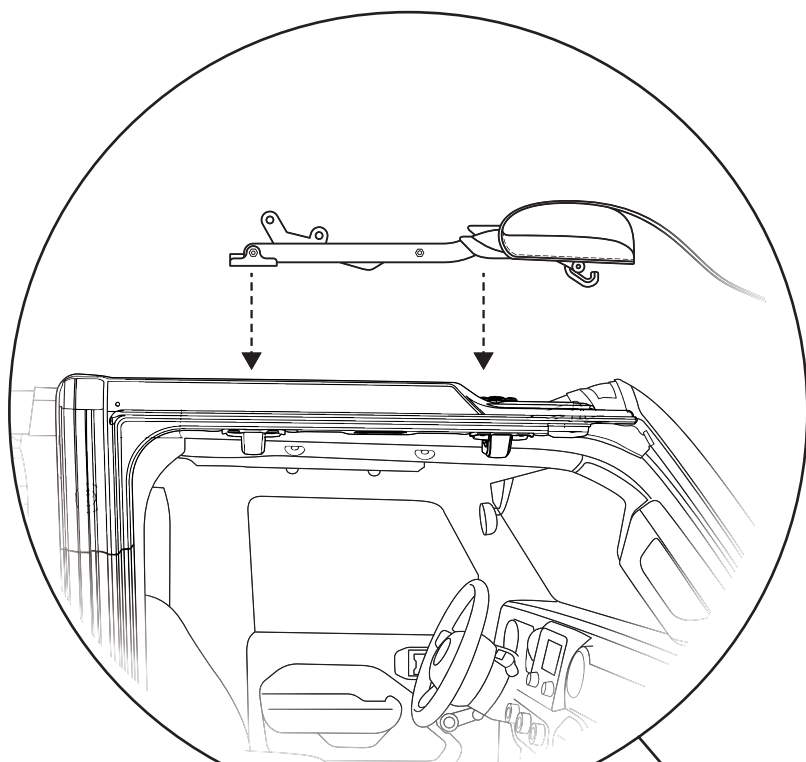

Place the Header and fabric on the Jeep windshield header, laying the fabric across the windshield and hood of the Jeep.

Align the Pivot Bracket holes with the holes in the rear sport bar clamps on the Door Rails.

**Tip** This will be much easier with two people.

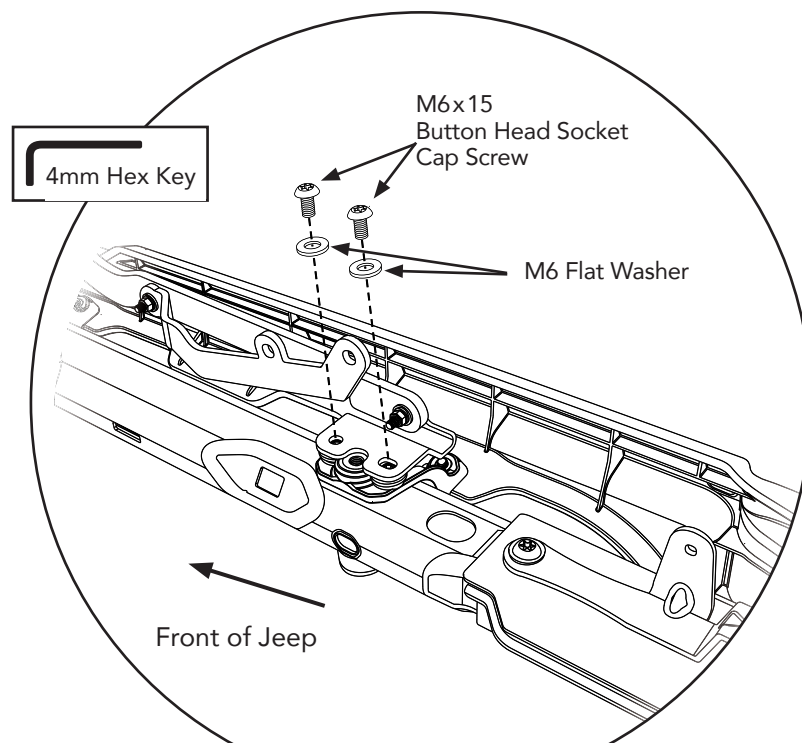

Secure the Pivot Brackets to the Door Rails using two (2) M6x15 Button Head Socket Cap Screws and two (2) M6 Flat Washers on each side of the Jeep.

Do not fully tighten fasteners at this time, tighten these fasteners only after all parts have been adjusted for fit, after Section 10, on page 17 of this guide.

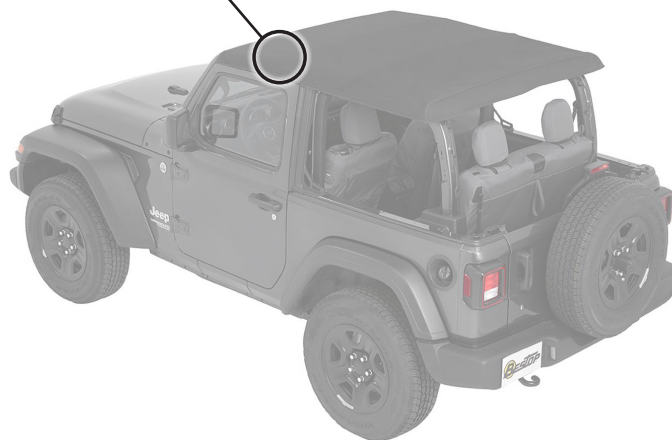

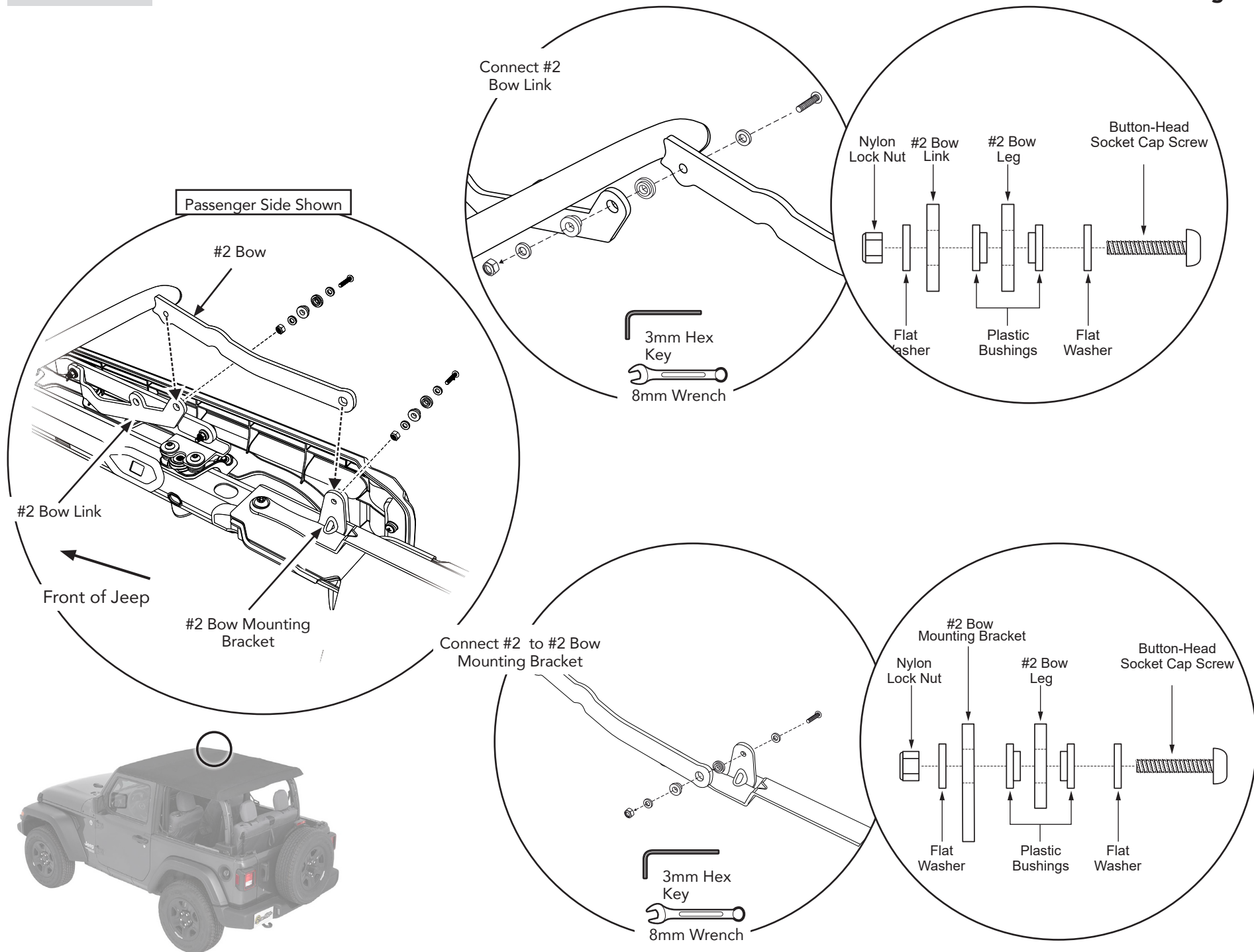

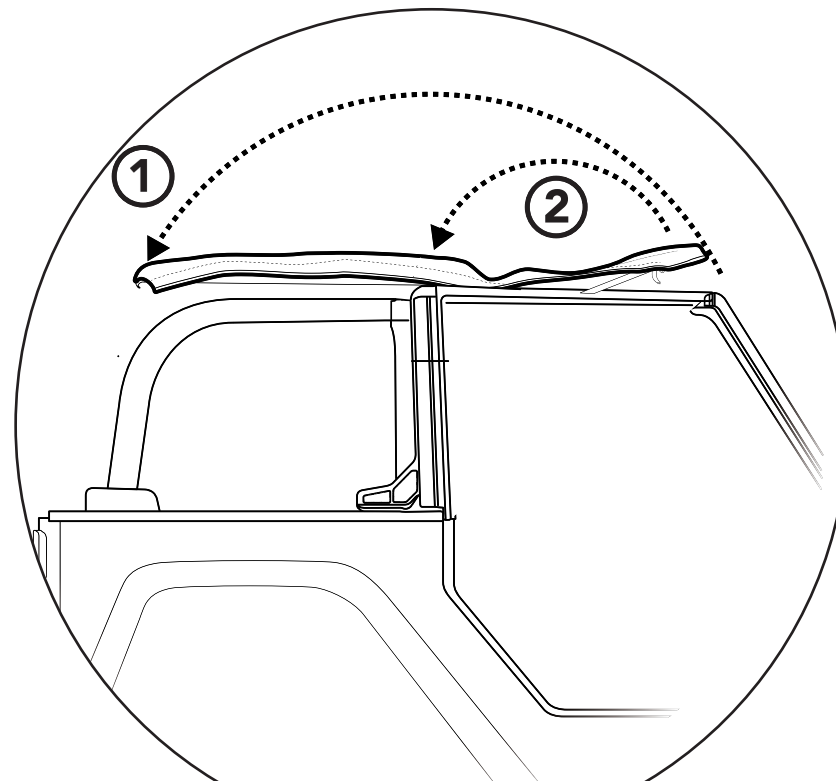

- ① Drape the Top Fabric over the top of the Jeep Sport Bars, and the #2, #3 and #4 Bows.
- ② Open the Sunrider. Fold the Sunrider back from the front pivot point, resting the front portion of the top on the rear portion.

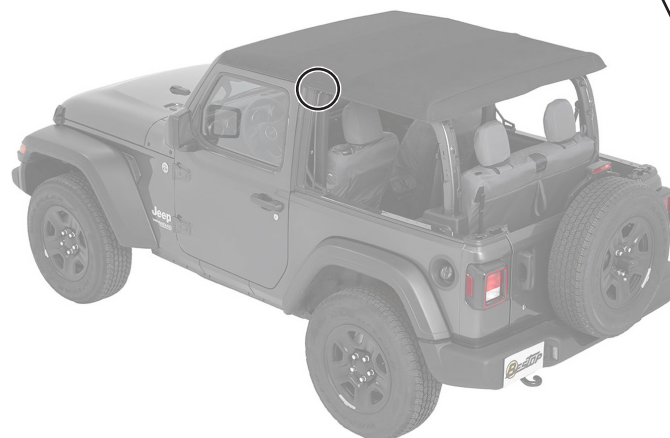
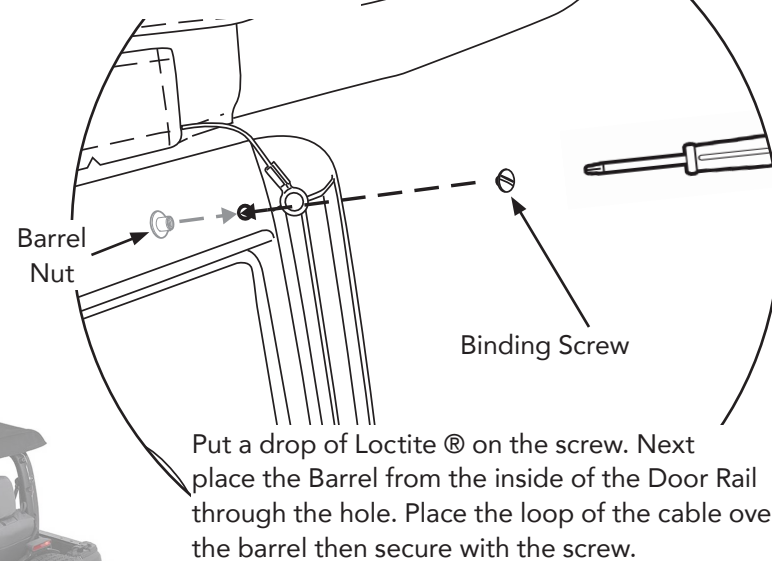
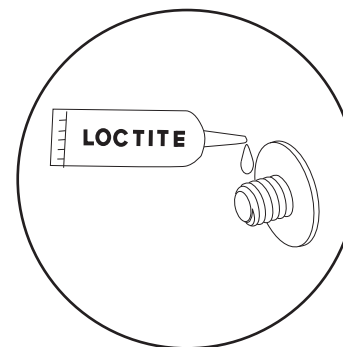
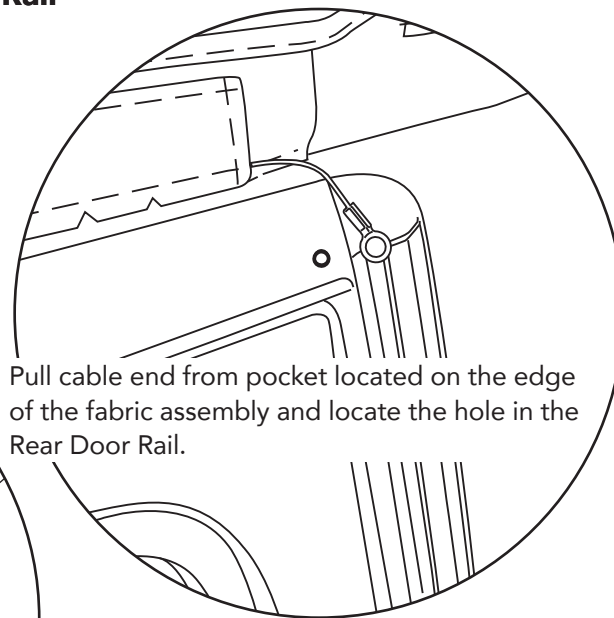
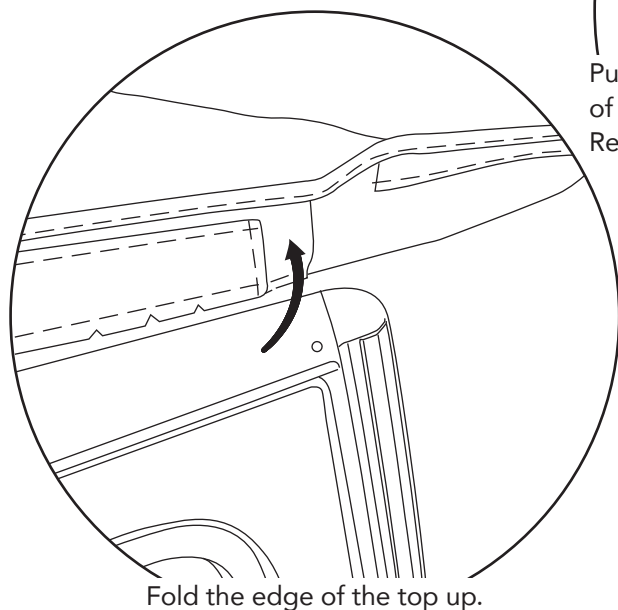

Attach the six (6) Hook-&-Loop Strips to the #4 Bow as shown above.

Wrap the Hook-&-Loop Strips around the cross-bars of the #4 Bow attaching one side of each strip to the opposite side. Make sure that the "hook" side ("scratchy side") of each wrapped strip is on the outside, so that it will adhere to the "loop" strip on the underside of the top fabric.

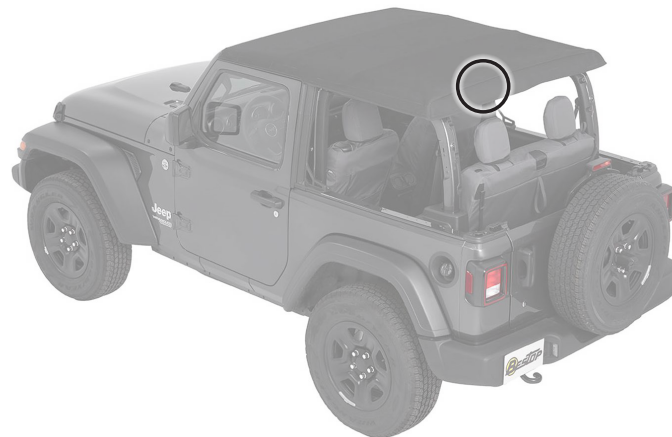
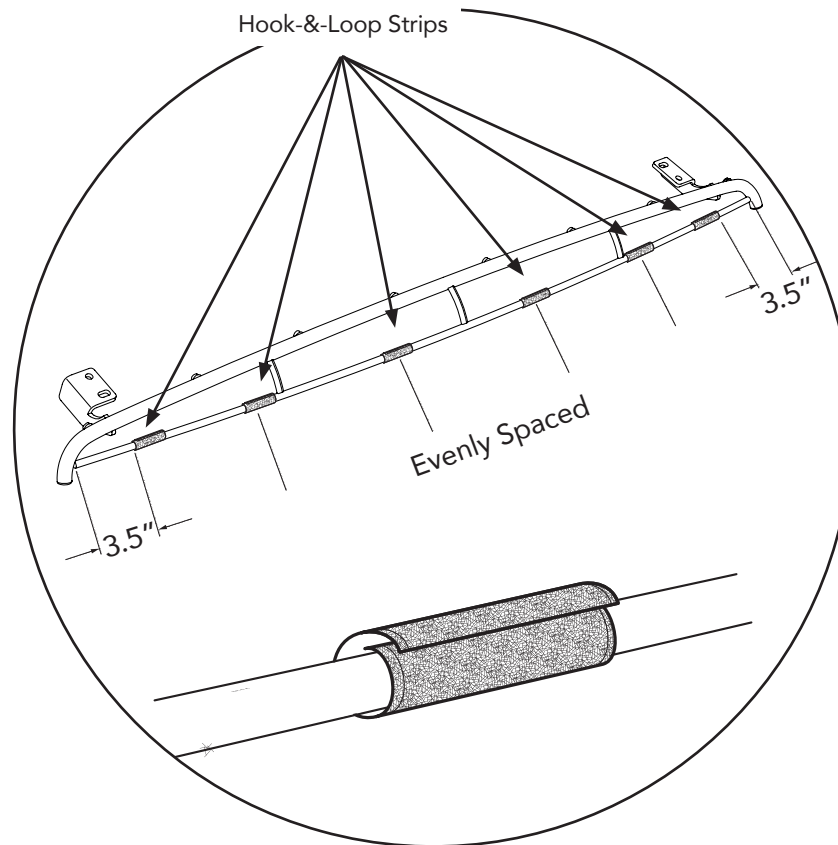

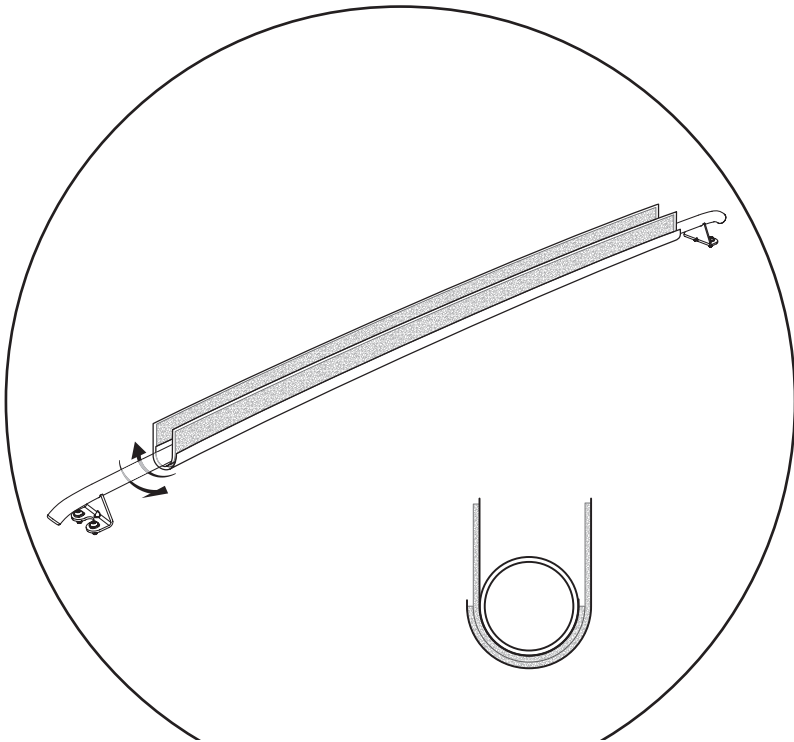

Flip the rear of the fabric deck forward for easier access.

Locate the two fabric flaps sewn to the inside of the fabric top just above the #3 Bow.

Wrap these flaps around the #3 Bow so that the Hook side of one flap attaches to the Loop side of the other flap.

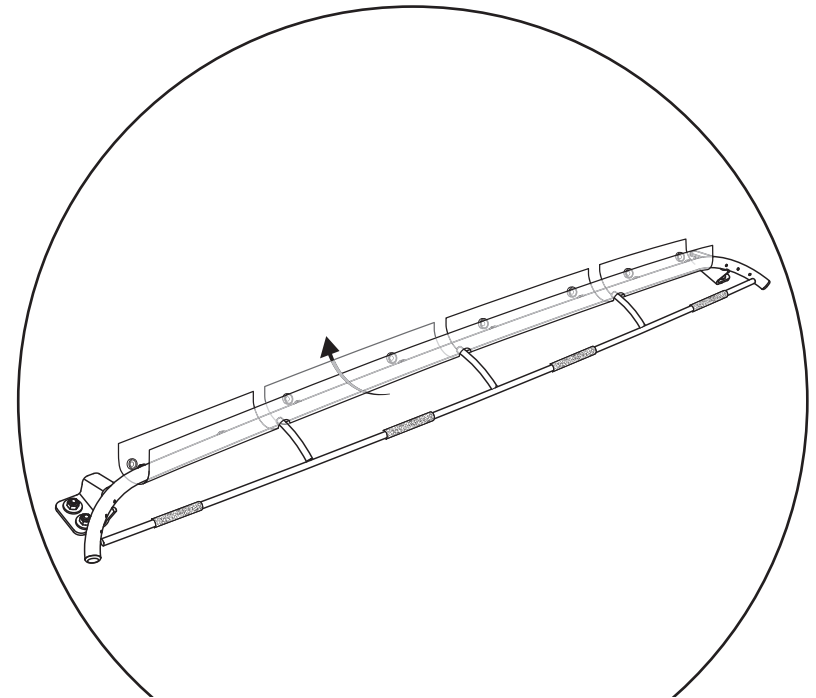

With the rear of the fabric deck flipped forward, locate the four flaps sewn to the inside of the fabric top just above the #4 Bow.

Wrap these flaps around the #4 Bow from back-to-front, and snap to the snaps on the front side of the #4 Bow.

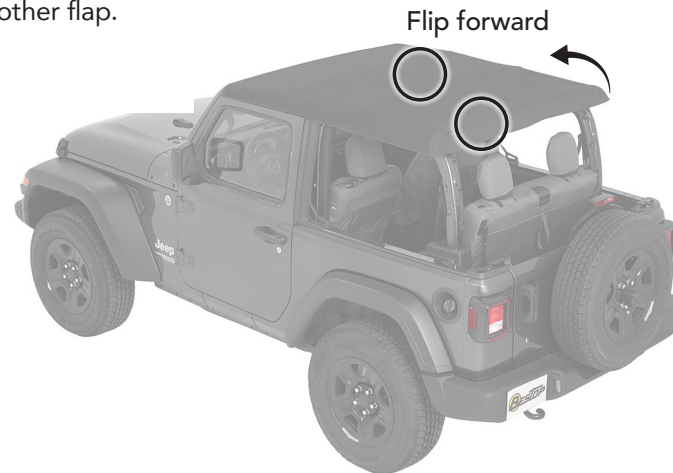

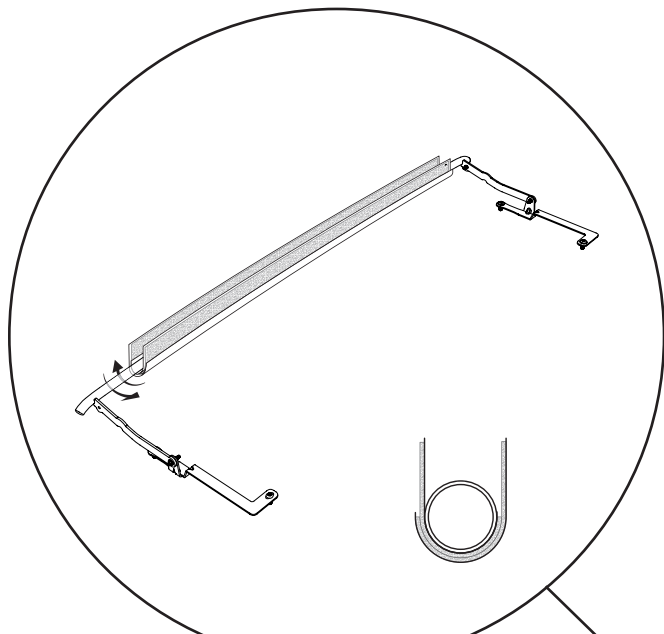

Locate the two fabric flaps sewn to the inside of the fabric top just above the #2 Bow.

Wrap these flaps around the #2 Bow so that the Hook side of one flap attaches to the Loop side of the other flap.

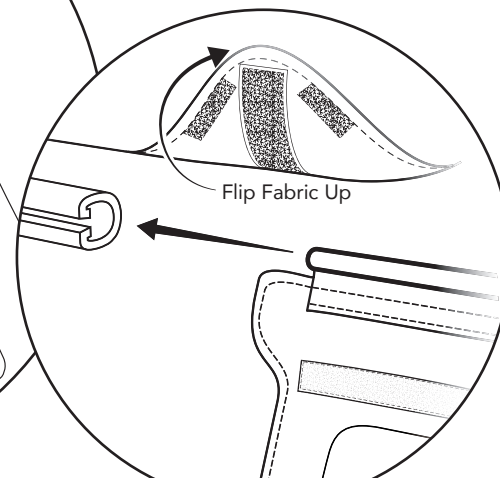
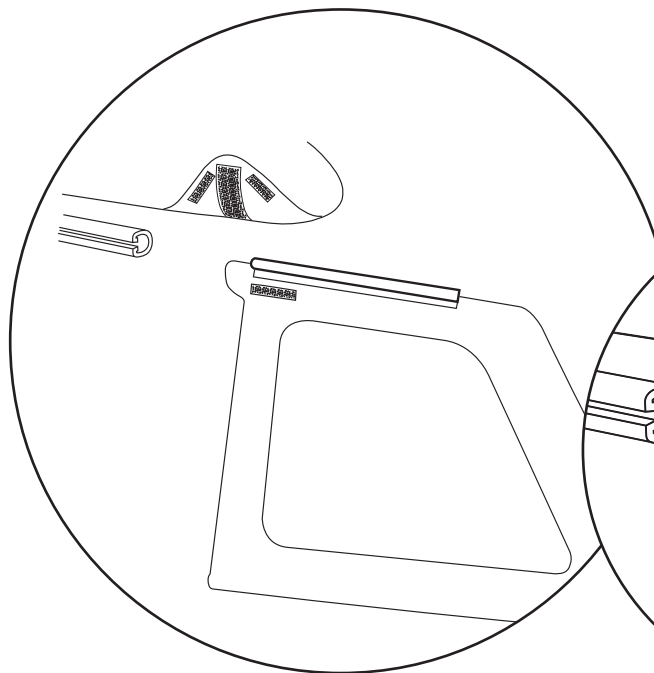

Locate the plastic channel along the left side edge of the top fabric, behind the left Rear Door Rail.

Lift up the fabric top for access to the plastic channel.

Insert the tip of the sewn-in plastic tube at the top edge of the left Quarter Window into the open end of the rear of the channel sewn onto the bottom edge of the top fabric.

Slide the Quarter Window forward until the front portion of the window is aligned with the rear edge of the Rear Door Rail.

Repeat on the right Side Quarter Window.

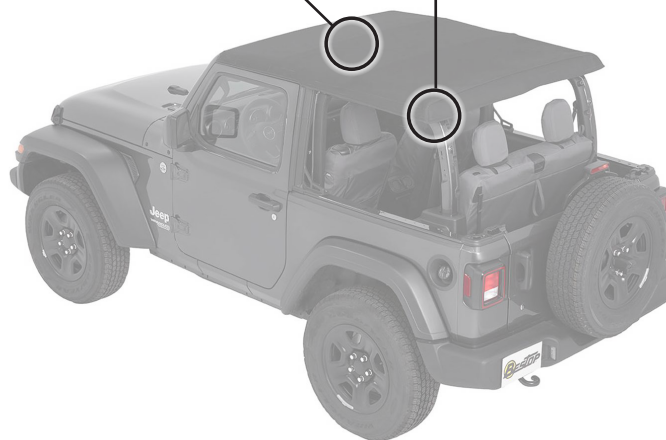



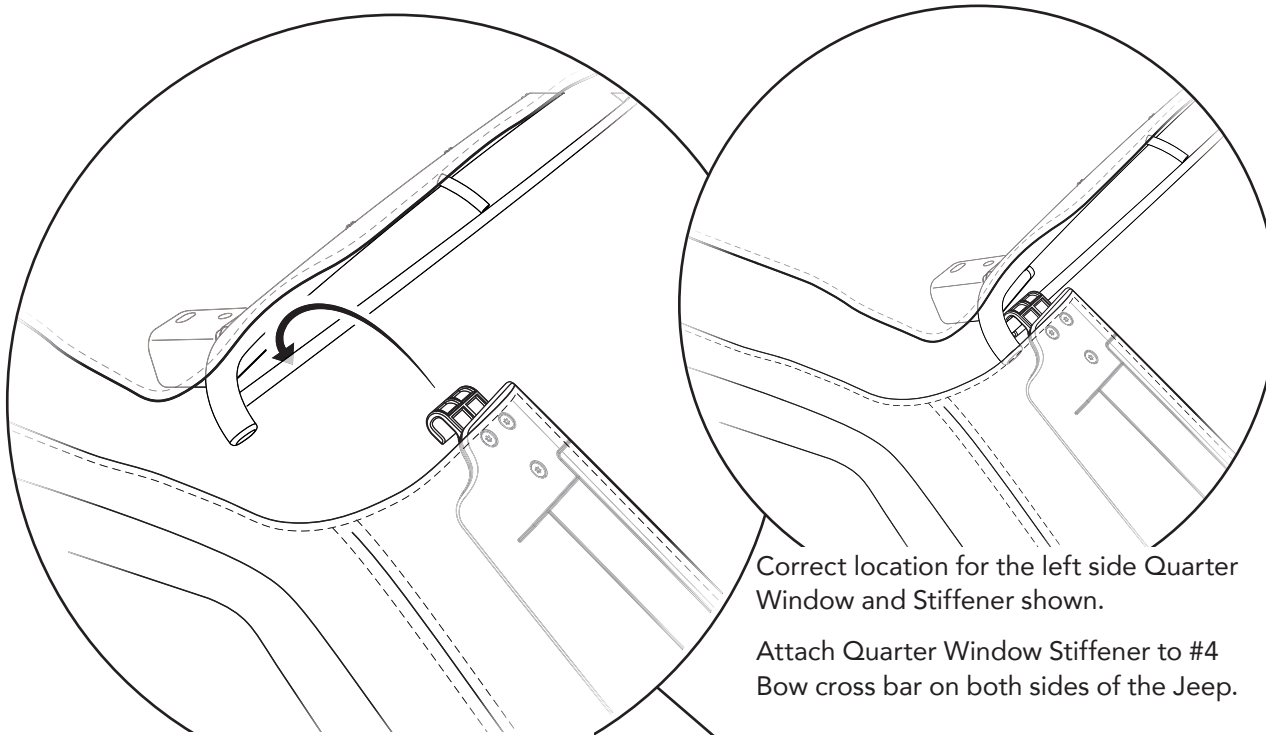

Correct location for the left side Quarter Window and Stiffener shown.

Attach Quarter Window Stiffener to #4 Bow cross bar on both sides of the Jeep.

Attach the Quarter Window Stiffeners (attached to the inside of each Quarter Window) to the #4 Bow cross bar.

Clip the Stiffener J-Hooks over the #4-Bow cross bar, and make sure they are located all the way to the outside of the #4 Bow on each side.

It may be easier to attach each J-hook to the cross bar by rotating the Stiffener just a bit side-to-side to allow the J-Hook to slide over the cross bar.

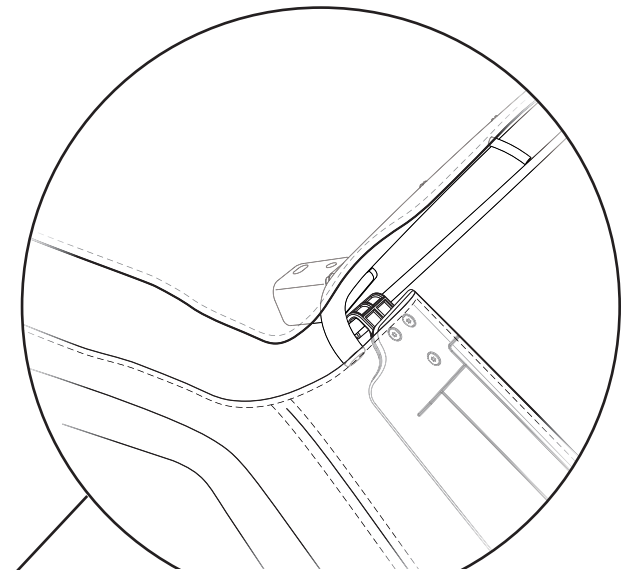

Secure the Quarter Window Stiffeners to the Tailgate Retainers.

Locate the strap attached to the inside of each Stiffener. Snap the loose end of this strap to the snap located on the inside of each Tailgate Retainer.

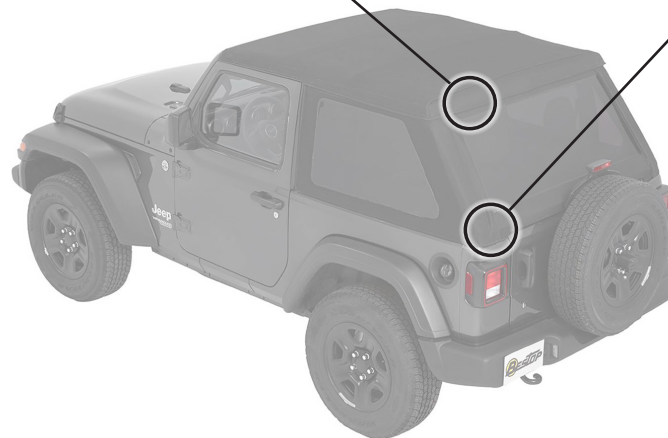

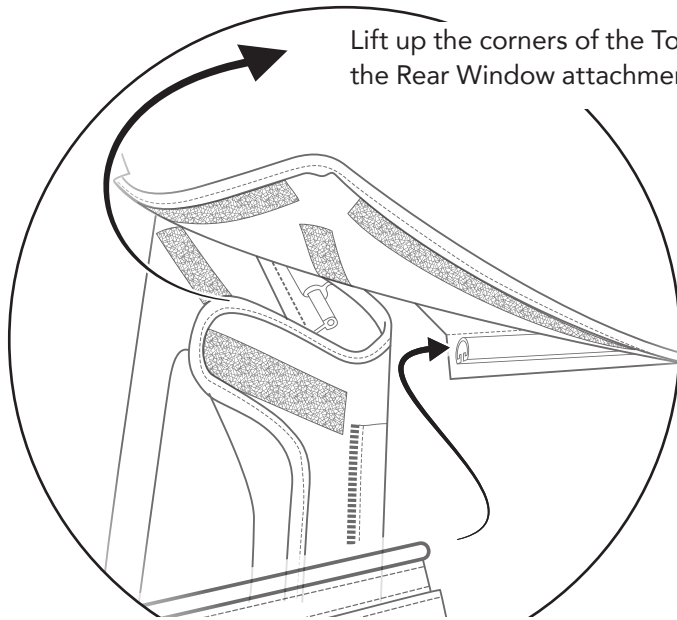

Insert the tip of the sewn-in plastic tube at the top right corner of the Rear Window into the left-side open end of the channel sewn onto the bottom edge of the top fabric, and slide the Rear Window to the right until it meets the right side Quarter Panel Stiffener.

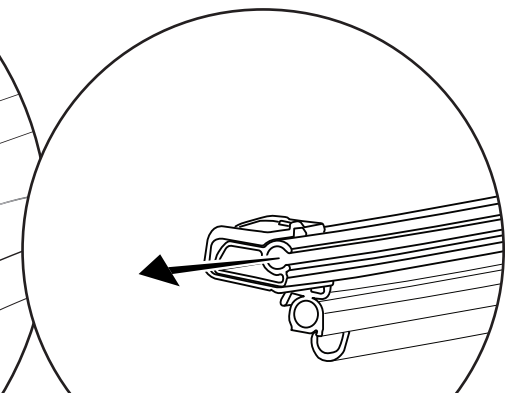
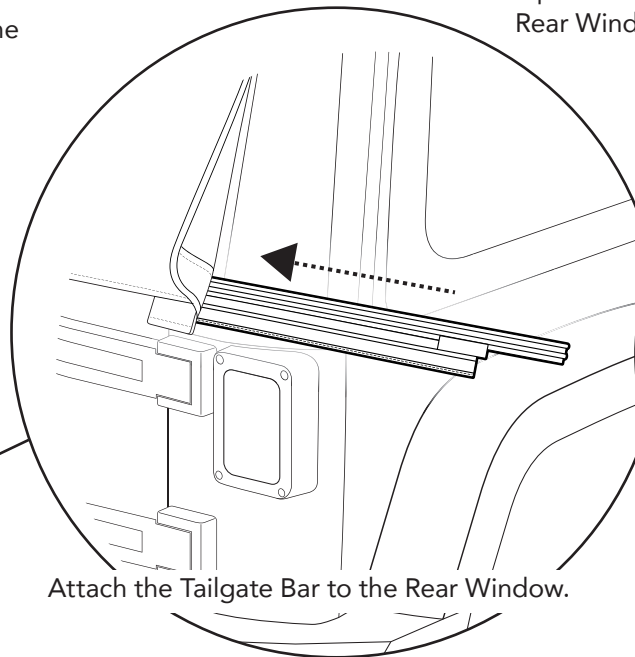
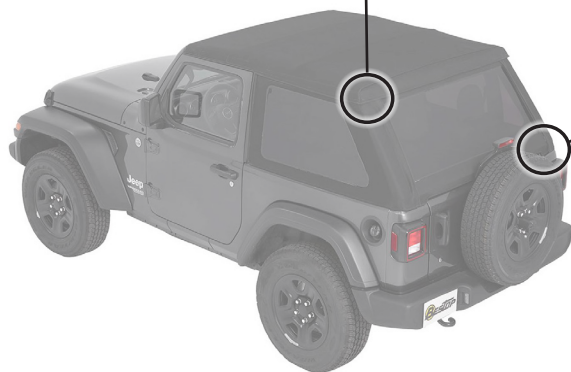
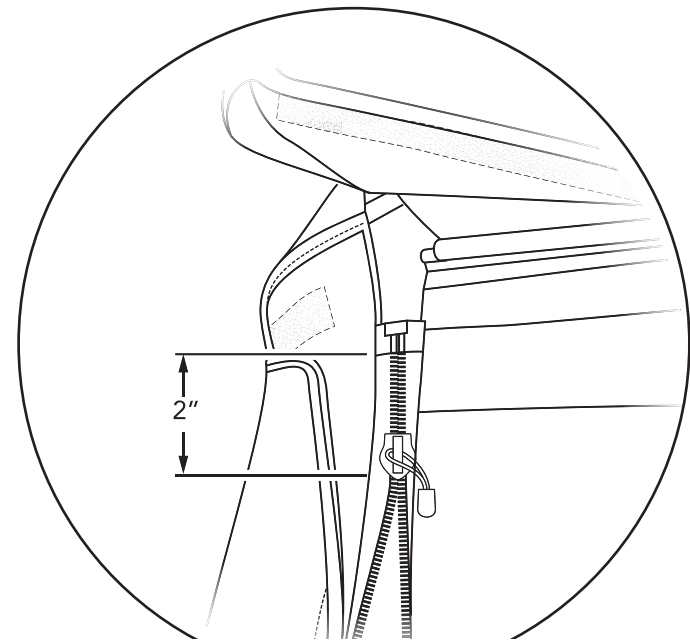

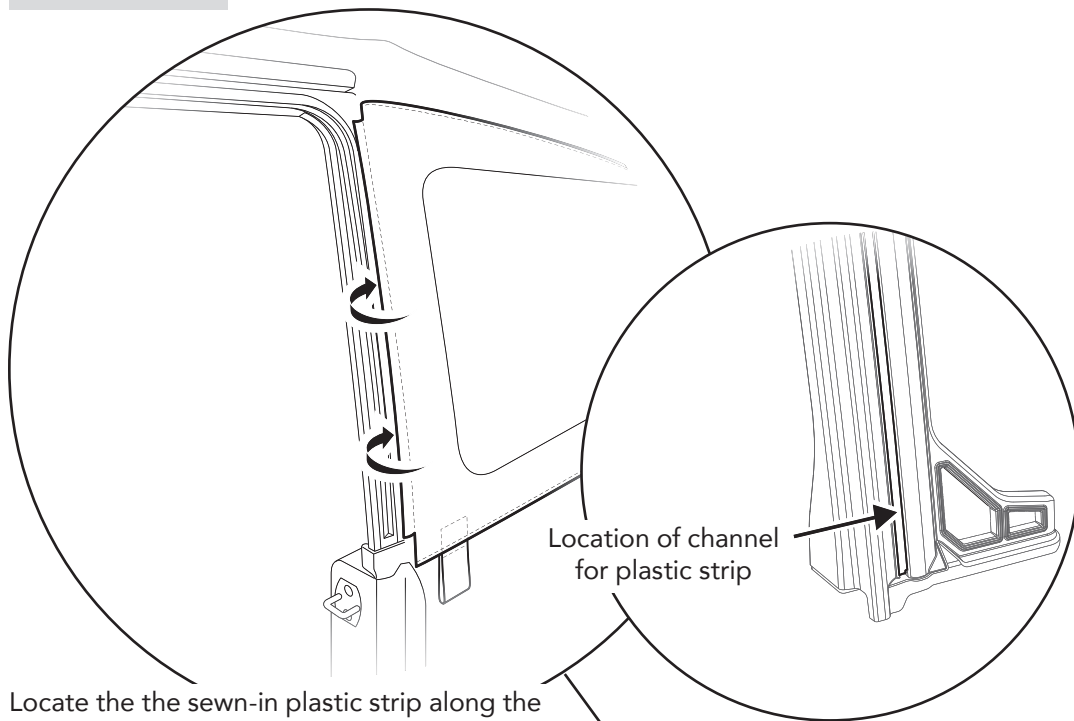

Locate the the sewn-in plastic strip along the front edge of the left Quarter Window.

Tuck this plastic strip into the vertical channel along the outside face of the left Rear Door Rail.

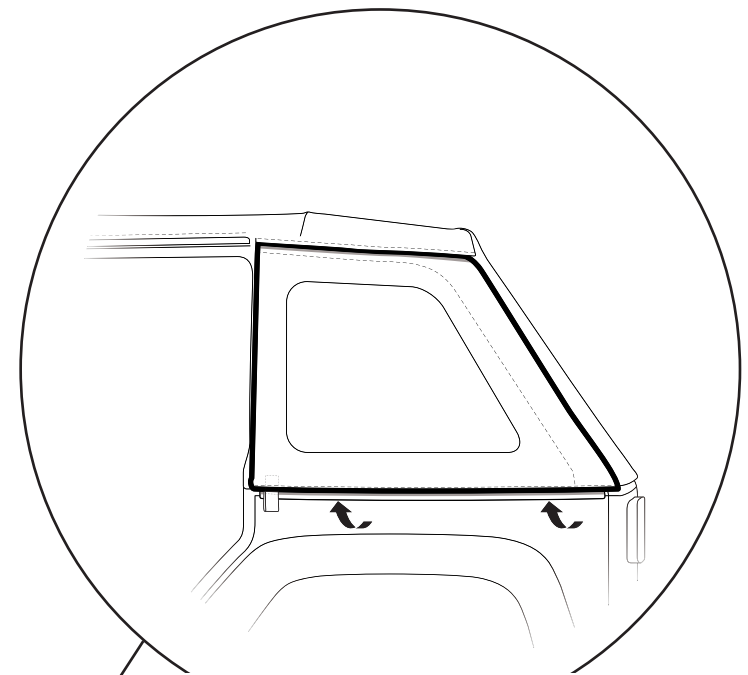

Tuck the plastic strip along the bottom edge of the left Quarter Window under the Jeep belt rail, by rolling it up underneath the belt rail, beginning at the rear, and working your way forward.

Repeat on the right Quarter Window.

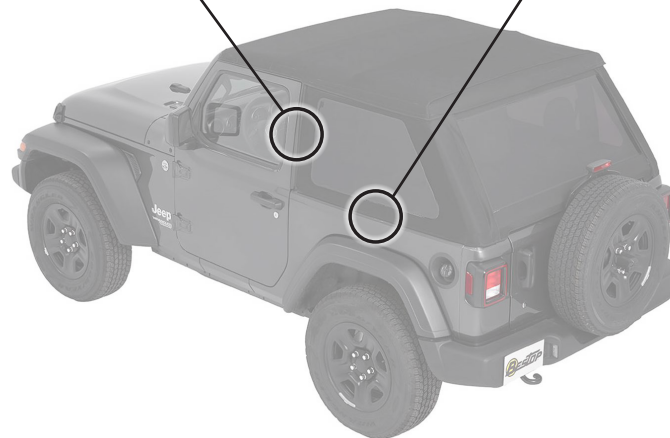

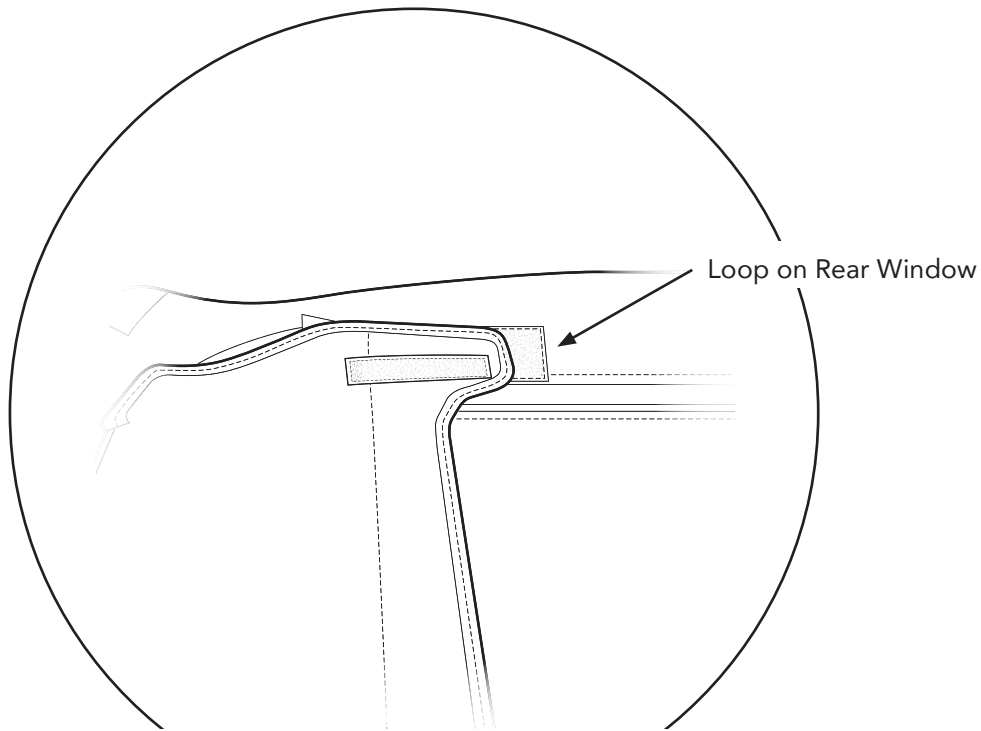

Attach the flap at the top corner of the left Quarter Window to the hook and loop strip on the top of the Rear Window.

Repeat on the right side of the Jeep.

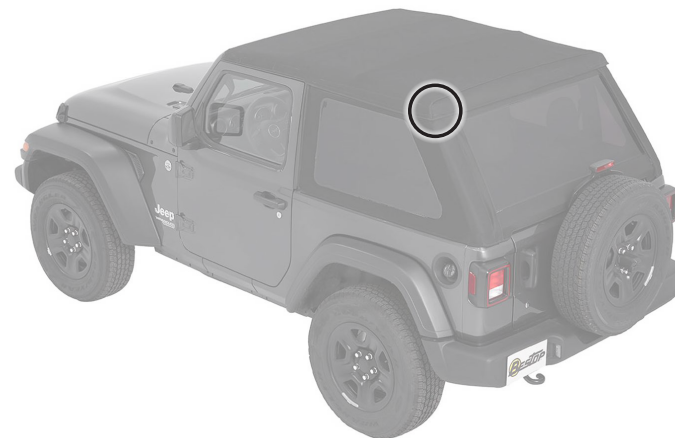
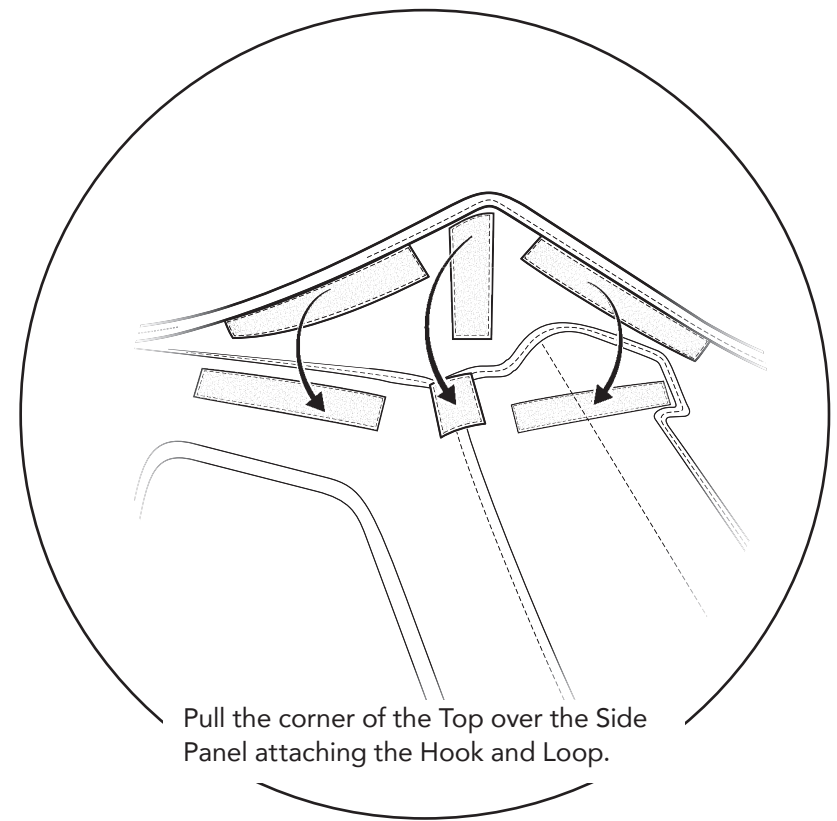

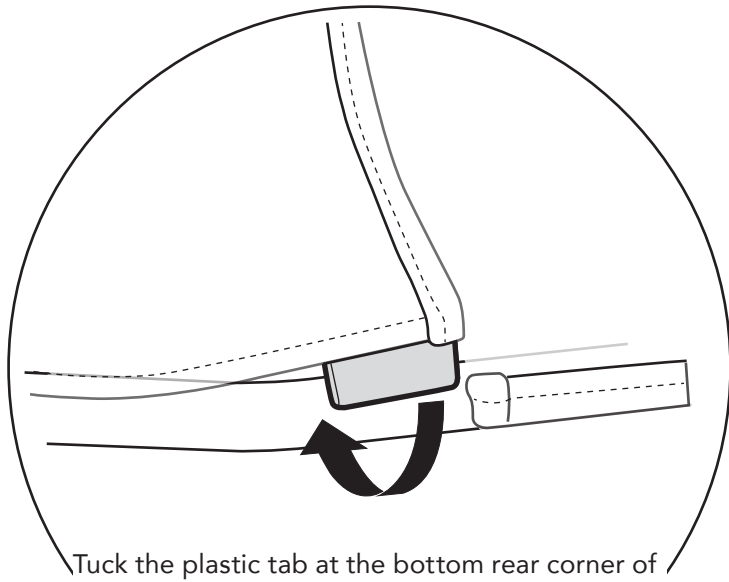

Tuck the plastic tab at the bottom rear corner of each Quarter Window under the Jeep belt rail.

Roll the tab up underneath the belt rail.

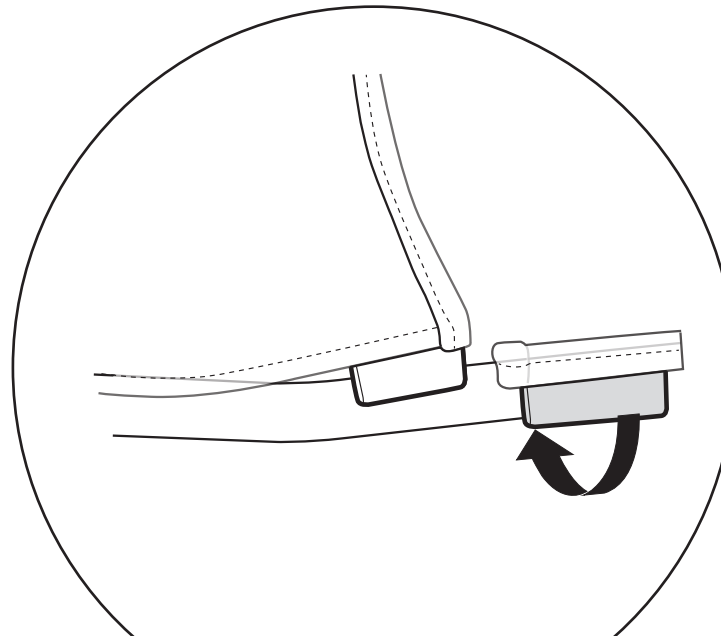

Tuck the plastic tabs at the bottom corners of the Rear Window into the Belt Rail Retainer.

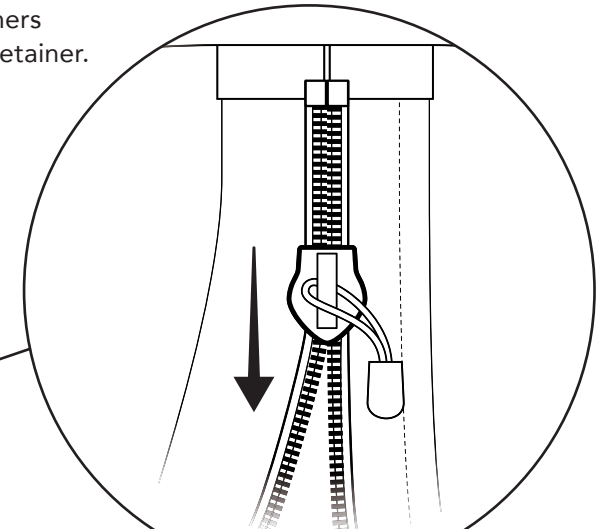

Finish zipping the Quarter Windows and Rear Window together completely.

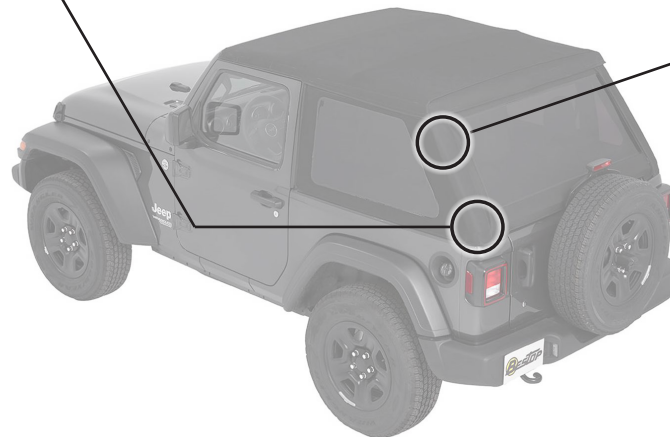

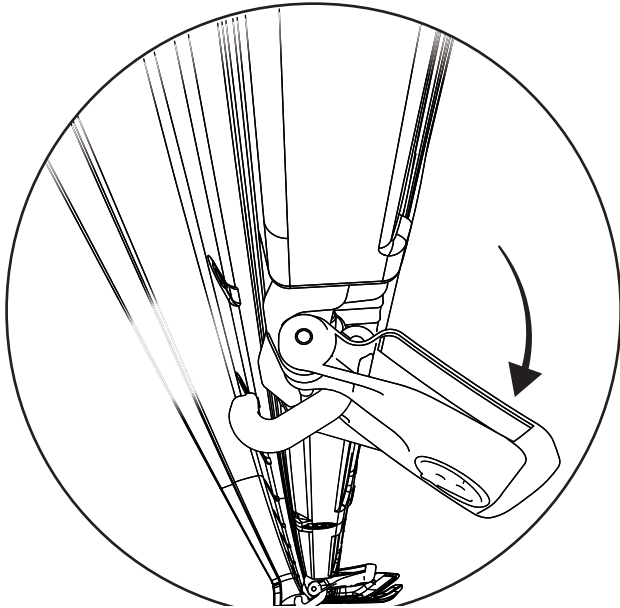

Fold the Sunrider closed and secure both latches to the vehicle's windshield header.

Pivot the latch handle down.

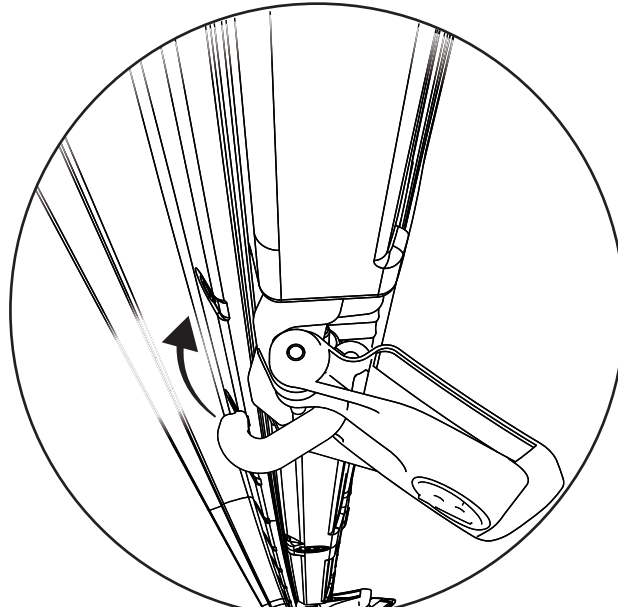

Engage the hook.

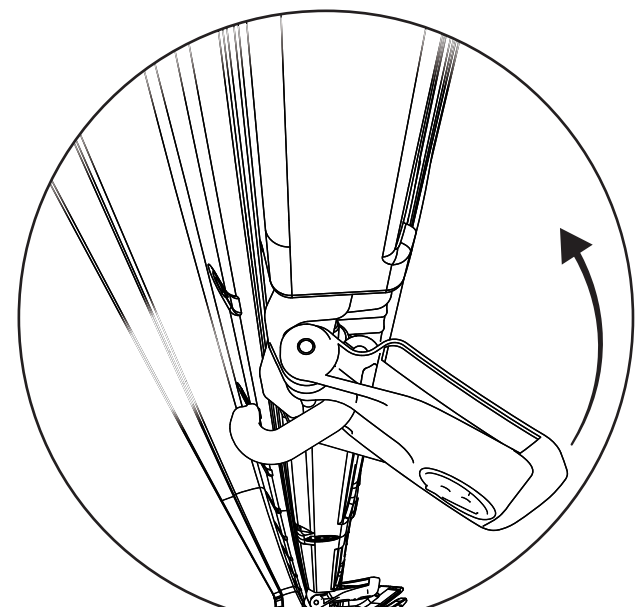

Pivot the latch handle back up.

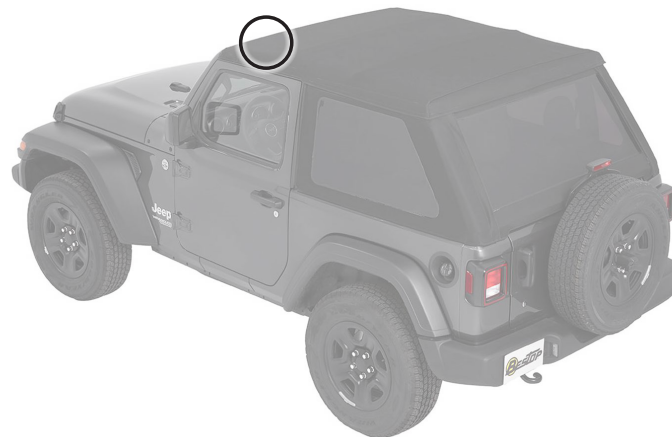





## Care and Maintenance of your Bestop Product

Your Bestop product is made of the finest materials available. To keep it looking new and for the maximum possible wear, it will need periodic cleaning and maintenance.

**Fabric:** The fabric should be washed often using soap, warm water and a soft bristle brush. Rinse with clear water to remove all traces of soap. Bestop recommends using Bestop Cleaner (part no. 11201-00) and Bestop Protectant (part no. 11202-00) for Vinyl fabric and Bestop Twill Protectant (part no. 11207-00) for Twill fabric. Bestop Cleaner and Bestop protectant are specially formulated to provide a total cleaning and protection system. Bestop Cleaner safely removes the toughest stains, will not harm vehicle finishes, is biodegradable and environmentally friendly. Bestop Protectant protects against UV-fading, cracking and hardening, and repels dust, grease, dirt and mildew.

**Windows:** Keep windows clean to avoid scratching. DO NOT use a brush on the windows! Wash with a water-soaked cloth or sponge and a mild dishwashing detergent. Bestop recommends Bestop Vinyl Window Cleaner (part no. 11203-00), which safely cleans and protects vinyl windows and helps prevent UV damage. NEVER WIPE THE WINDOWS WHEN THEY ARE DRY. Be careful when cleaning snow or frost from the vinyl windows since they are easily scratched and may crack at low temperatures. DO NOT roll the sides or rear window in cold weather. The windows become stiff and will crack. Cracks caused by misuse in cold temperatures are not covered under warranty.

**Water:** Seeping through at the seams may be stopped by applying 3-M Scotchgard® on the inside of the seams.

**Snap:** Keep snaps cleaned and lubricated with silicone to help prevent snaps from sticking to the studs. If a snap does become stuck to a stud, use a screwdriver and GENTLY pry apart to prevent permanent damage to the snap or the top fabric.

**Zippers:** Keeping zippers cleaned and lubricated with Bestop's Zipper Cleaner (part no. 11206-00) will help prevent damage and keep the zippers in smooth working condition. If a zipper opens behind the slider, the slider may have been spread apart. This problem can usually be repaired by using an ordinary pair of pliers to bring the sides back into parallel. Return slider to the end of the zipper in the normal Open position. Squeeze lightly at first and test the zipper. If the zipper continues to remain open squeeze more firmly with the pliers and try the zipper again. Repeat this procedure until the zipper operates correctly.

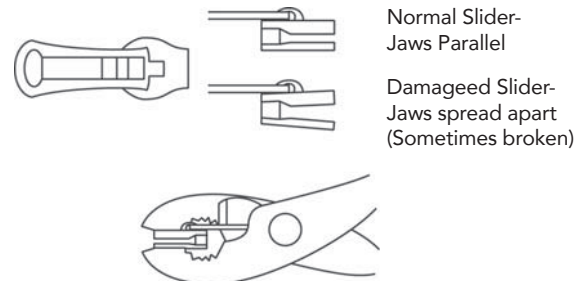

**For Bestop Warranty Information, Please go to;**  
<https://www.bestop.com/help/warranty-information/>

