



## Installation Instructions Trektop for Bronco 2 Door

Vehicle Application:  
Ford Bronco 2 Door 2021-Current  
Part Number 56872

### Installation Tips

Before you begin installing your new Trektop, please read all the instructions thoroughly, and watch the Bestop Installation video. (See Support section on this page).

For easier installation, the top should be installed at a temperature above 72° F. Below this temperature, the fabric may contract making it difficult to fit the vehicle.



### WARNING

Do not rely in any way on the components of this product to protect against injury or death in the event of an accident. Never operate the vehicle in excess of manufacturer's specifications.

Read and follow, precisely, all installation instructions provided when installing this product. Failure to do so may result in a poor fit and could place occupants of the vehicle in a potentially dangerous situation.



### Notes

We suggest using two people to help lift the top onto the vehicle.



### CAUTION

Safety glasses should be worn at all times when installing this product.

**WEAR SEAT BELTS AT ALL TIMES**

### Tools



Safety Glasses



T25, T30, T40  
and T50  
Torx Drivers



2.5 and 5mm  
Allen Wrenches



Scissors

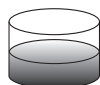

50/50 Alcohol  
water Solution



Soft Cloth



4 Hours

### Skill Level



3 - Moderately Difficult

### Support

We're here to help! Go to:  
<https://www.bestop.com>  
and click on Need Help?



<https://www.bestop.com/video-library>



## Installation Instructions Trektop for Bronco 2 Door

Vehicle Application:  
Ford Bronco 2 Door 2021-Current  
Part Number 56872

### Sugerencias de Instalación

**Antes de empezar a instalar esta unidad, lea atentamente todas las instrucciones.**

**Para un buen ajuste:**

Para facilitar la instalación, el producto debe instalarse a temperaturas superiores a 72 °F (22 °C).

Por debajo de esta temperatura, la tela puede encogerse una pulgada o más, lo que dificultaría su ajuste al vehículo.

Es normal que la tela se contraiga o arrugue cuando está guardada en la caja de empaque. A los pocos días después de la instalación, la tela se relajará y las arrugas desaparecerán.



#### ADVERTENCIA

Este producto se diseñó principalmente para mejorar la apariencia del vehículo y proteger a los ocupantes de las condiciones climáticas comunes. De ninguna manera piense que los componentes de este producto pueden servir como medio de contención para los ocupantes del vehículo o que pueden protegerlos contra lesiones o la muerte en caso de accidente. Este producto no protegerá a los ocupantes contra caídas de objetos. Nunca conduzca este vehículo fuera de las especificaciones del fabricante.

#### USE LOS CINTURONES DE SEGURIDAD EN TODO MOMENTO

Lea y siga con precisión todas las instrucciones de instalación que se proporcionan para instalar este producto. Si no lo hace, podría producirse un mal ajuste que colocaría a los ocupantes del vehículo en una situación potencialmente peligrosa.



#### PRECAUCIÓN

Debe usar gafas protectoras en todo momento durante la instalación de este producto.

### Conseils pour l'installation

**Lire toutes les instructions au complet avant de commencer l'installation de cet assemblage.**

**Pour un ajustement sans problème :**

Afin de faciliter l'installation, ce produit doit être installé à des températures au-dessus de 72 °F (22 °C).

Sous cette température, le tissu peut rétrécir d'un pouce (2,5 cm) ou plus, ce qui rendra l'ajustement sur le véhicule difficile.

Il est normal que le tissu rétrécisse et plisse pendant qu'il est dans la boîte d'expédition. En quelques jours après l'installation, le tissu se détendra et les plis disparaîtront.



#### AVERTISSEMENT

Ce produit est conçu principalement pour améliorer l'apparence du véhicule et pour protéger les occupants des conditions météorologiques usuelles. Ne jamais se fier aux composants de ce produit pour se protéger de blessures ou de la mort en cas d'accident. Ce produit ne protégera pas les occupants des chutes d'objets. Ne jamais utiliser le véhicule au-delà des caractéristiques techniques indiquées par le fabricant.

#### PORTER UNE CEINTURE DE SÉCURITÉ EN TOUT TEMPS

Lire et suivre, très fidèlement, toutes les instructions d'installation fournies lors de l'installation de ce produit. Ne pas suivre cette consigne peut causer une installation inadéquate et mettre les occupants du véhicule dans une situation potentiellement dangereuse.



#### MISE EN GARDE

Des lunettes de sécurité doivent être portées en tout temps lors de l'installation de ce produit.



## Installation Instructions Trektop for Bronco 2 Door

Vehicle Application:  
Ford Bronco 2 Door 2021-Current  
Part Number 56872

### Parts List



Front Door Rail Right  
Part #599.16  
Qty. 1

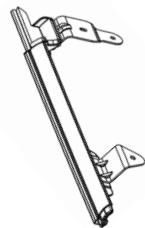

Front Door Rail Left  
Part #599.17  
Qty. 1

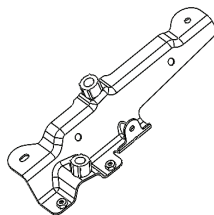

Main Pivot Bracket Right  
Part #602.60  
Qty. 1

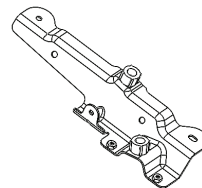

Main Pivot Bracket Left  
Part #602.61  
Qty. 1

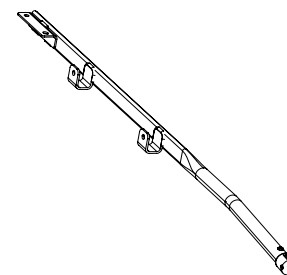

Front Side Rail Right  
Part #600.82  
Qty. 1

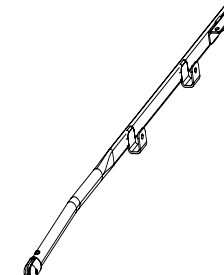

Front Side Rail Left  
Part #600.83  
Qty. 1

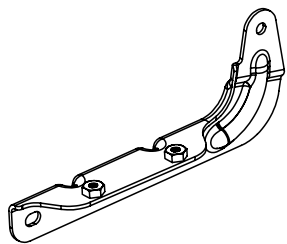

Link Control Bracket Right  
Part #598.18  
Qty. 1

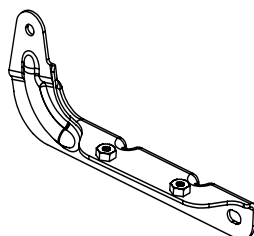

Link Control Bracket Left  
Part #598.19  
Qty. 1



Retainer, Upper Quarter  
Window Right  
Part #599.06  
Qty. 1



Retainer, Upper Quarter  
Window Left  
Part #599.07  
Qty. 1

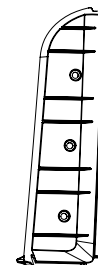

Vertical Window Retainer  
Right  
Part #597.58  
Qty. 1

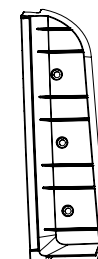

Vertical Window Retainer  
Left  
Part #597.59  
Qty. 1

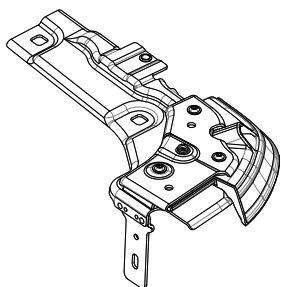

Tailgate Bar Retainer Right  
Part #609.26  
Qty. 1

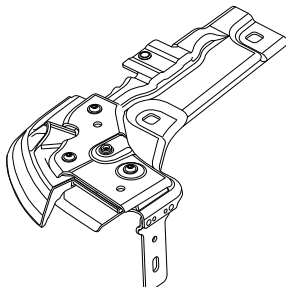

Tailgate Bar Retainer Left  
Part #609.27  
Qty. 1

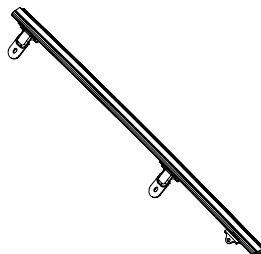

Belt Retainer Right  
Part #597.80  
Qty. 1

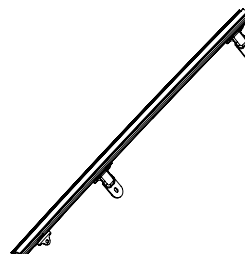

Belt Retainer Left  
Part #597.81  
Qty. 1

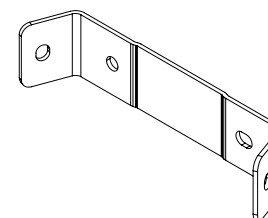

Rear Halo Mounting  
Bracket  
Part #599.39  
Qty. 2

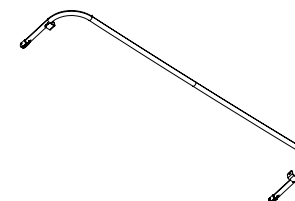

1.5 Bow Assembly  
Part #602.46  
Qty. 1



## Installation Instructions Trektop for Bronco 2 Door

Vehicle Application:  
Ford Bronco 2 Door 2021-Current  
Part Number 56872

### Parts List

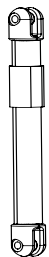

Control Linkage  
Part #602.75  
Qty. 2

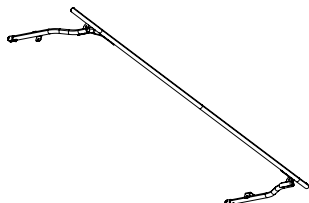

#2 Bow Assembly  
Part #600.84  
Qty. 1



#2 Bow Control Link  
Part #598.00  
Qty. 2



Tailgate Retainer  
Part #597.67  
Qty. 1

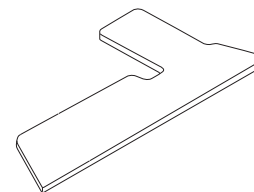

#1 Bow Foam Seal Rt  
Part #615.66  
Qty. 1

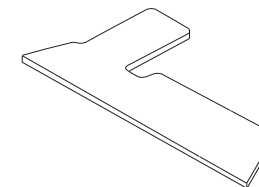

#1 Bow Foam Seal Lt  
Part #615.67  
Qty. 1



Quarter Window Retainer  
Foam Large  
Part #615.68  
Qty. 2



Quarter Window Retainer  
Foam Small  
Part #615.69  
Qty. 2

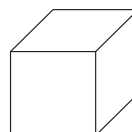

Tailgate Bar Retainer Foam  
Part #615.70  
Qty. 2

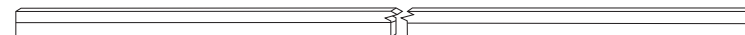

Belt Rail Retainer Foam  
Part #615.71  
Qty. 2



Vertical Window Retainer  
Seal Right  
Part #608.72  
Qty. 1



Vertical Window Retainer  
Seal Left  
Part #608.73  
Qty. 1

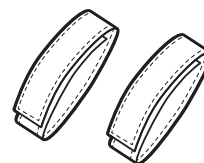

Sunrider Tie-Down Straps  
Part #410.42  
Qty. 2



Seal, Belt  
Part #596.65  
Qty. 2





## Installation Instructions Trektop for Bronco 2 Door

Vehicle Application:  
Ford Bronco 2 Door 2021-Current  
Part Number 56872

### Parts List

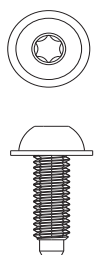

SCREW, M6 X 1.0 X 15mm  
Part #533.61  
Qty. 20  
T-30 Torx

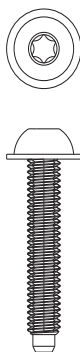

SCREW, M6 X 1.0 X 30mm  
Part #533.19  
Qty. 6  
T-30 Torx

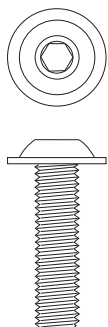

Screw, M8 X 1.25 X 30mm  
Part #583.63  
Qty. 6  
5mm Hex Socket

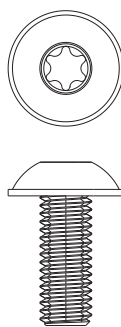

Screw, M8 X 1.25 X 20mm  
Part #573.09  
Qty. 4  
T-40 Torx



Spacer, 5.5MM  
Part #603.20  
Qty. 4



M4 x 8mm Shoulder Bolt  
#665.42  
Qty. 2  
2.5mm Hex Key



SCREW, Pivot Knuckle  
Part #308.65  
Qty. 14  
T-30 Torx



Loctite Capsule  
Part #309.83  
Qty. 1

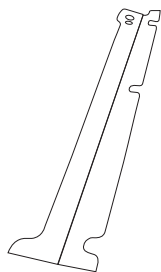

Front Seal Film Right (Shown)  
Part #609.40  
Qty. 1

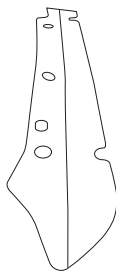

Rear Seal Film Right (Shown)  
Part #609.42  
Qty. 1

Front Seal Film Left  
Part #609.41  
Qty. 1

Rear Seal Film Left  
Part #609.43  
Qty. 1

Kit Part # 611.51

Note: Packaged with  
the windows

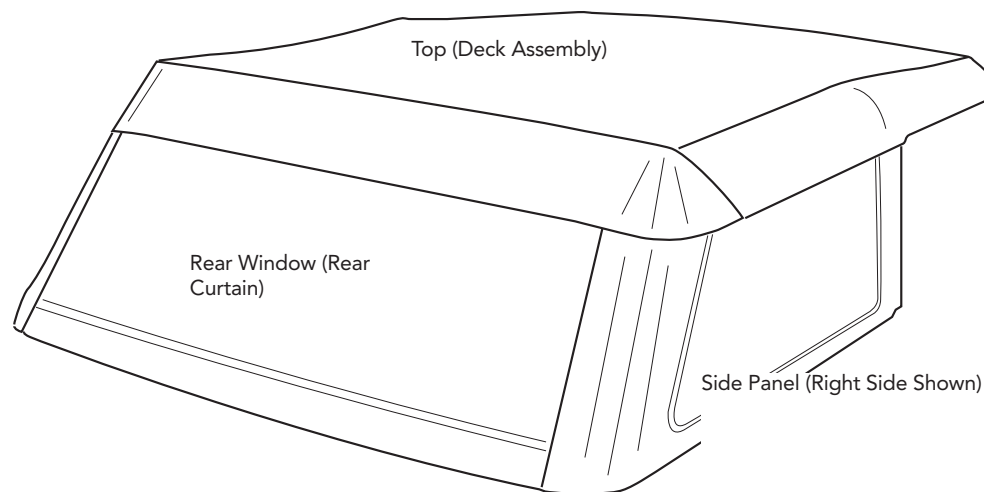

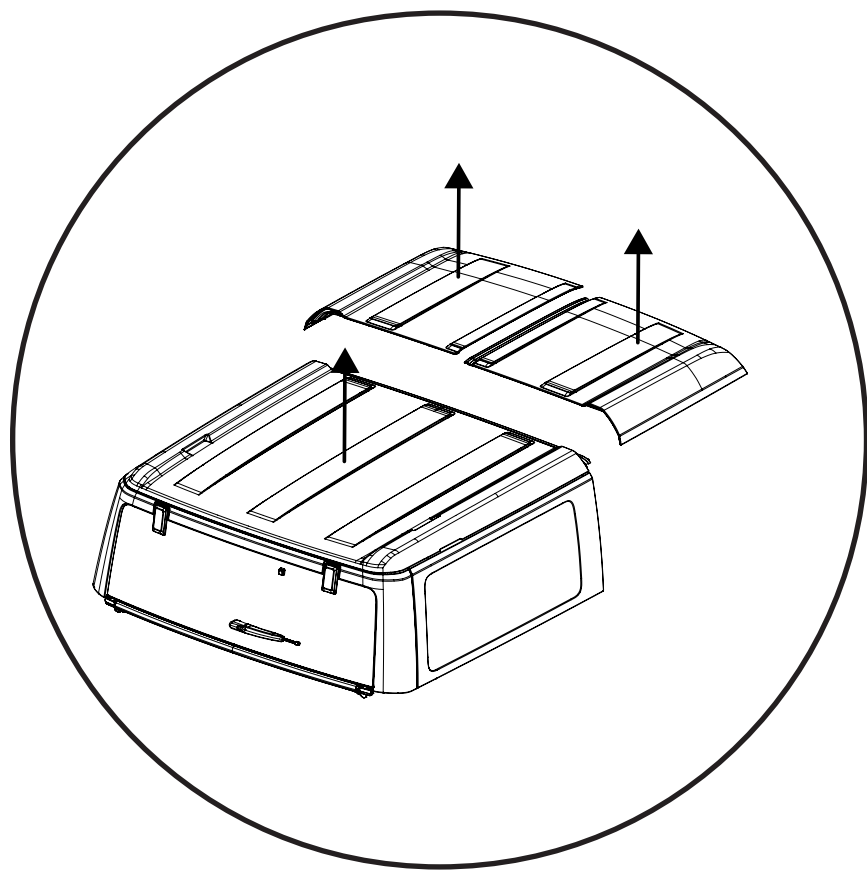

Remove the hardtop. (See owners manual for details)

**Note:** Some of the screws that are used to mount the hardtop will be used for the installation of the TrekTop.

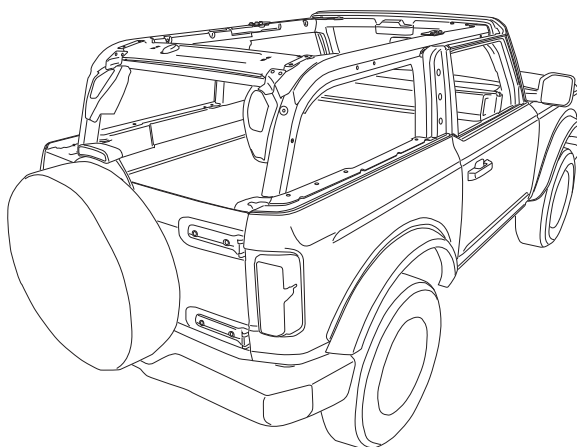

Step 1

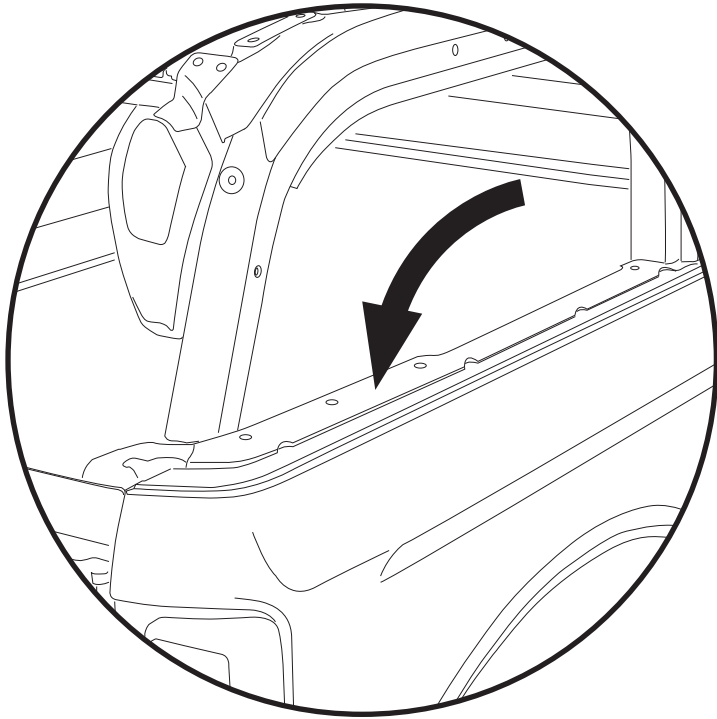

Wipe the top edge of the body with the 50/50 Alcohol/Water solution and a soft cloth.

Tools

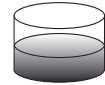

50/50 Alcohol  
water Solution



Soft Cloth

Parts

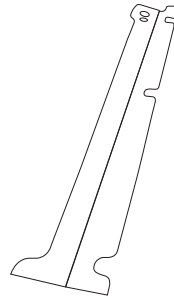

Front Seal Film Right (Shown)  
Part #609.40  
Qty.1

Front Seal Film Left  
Part #609.41  
Qty.1

Step 2

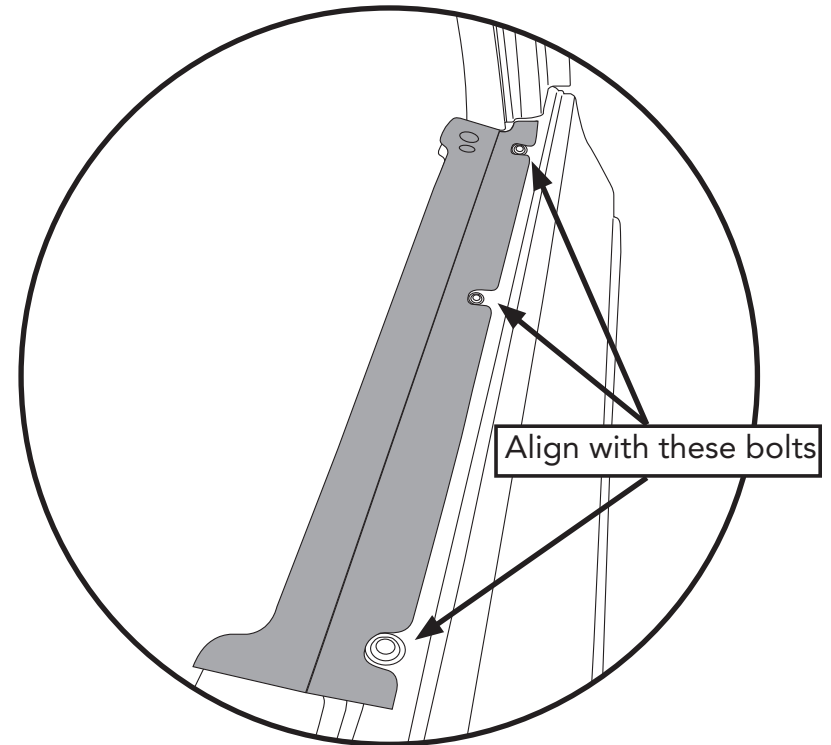

Align with these bolts

Align the cut outs to the fender bolts.

**Note:** It is very important to align the cut outs to the fender bolts first.

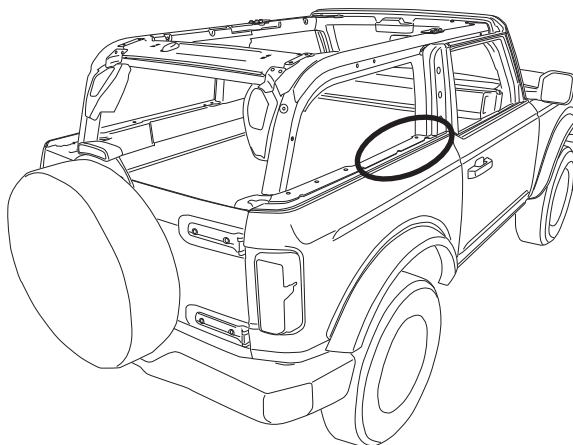

Step 3

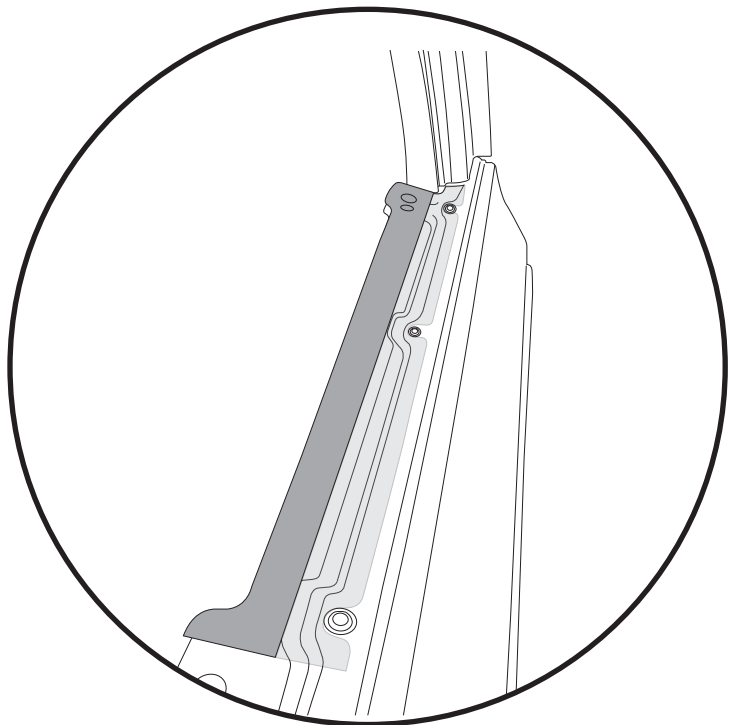

Remove the paper backing from the adhesive on the side with the cut outs and adhere the film to the vehicle.

Step 4

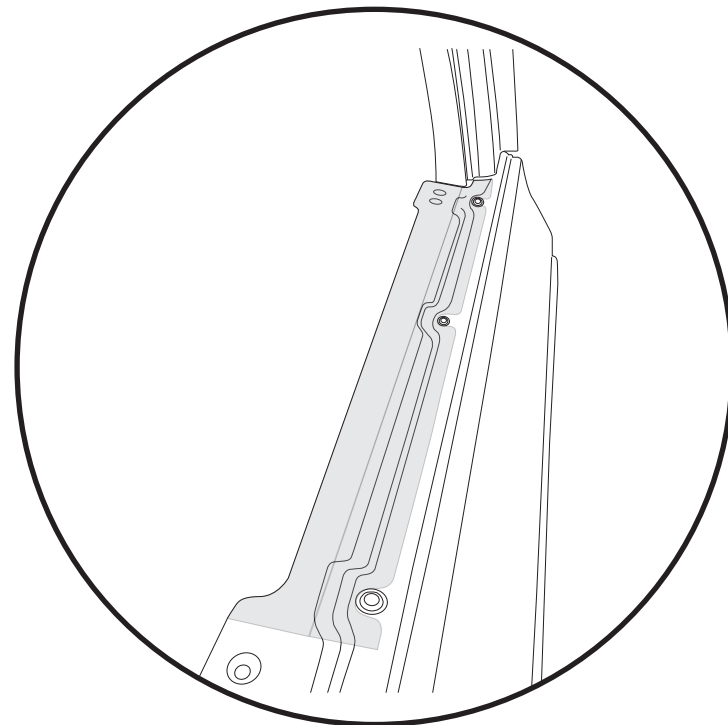

Remove the paper backing from the other side of the film and adhere the rest of the film to the vehicle.

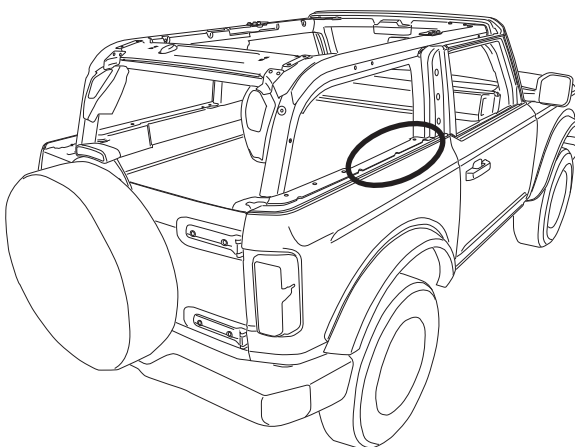

## Step 1

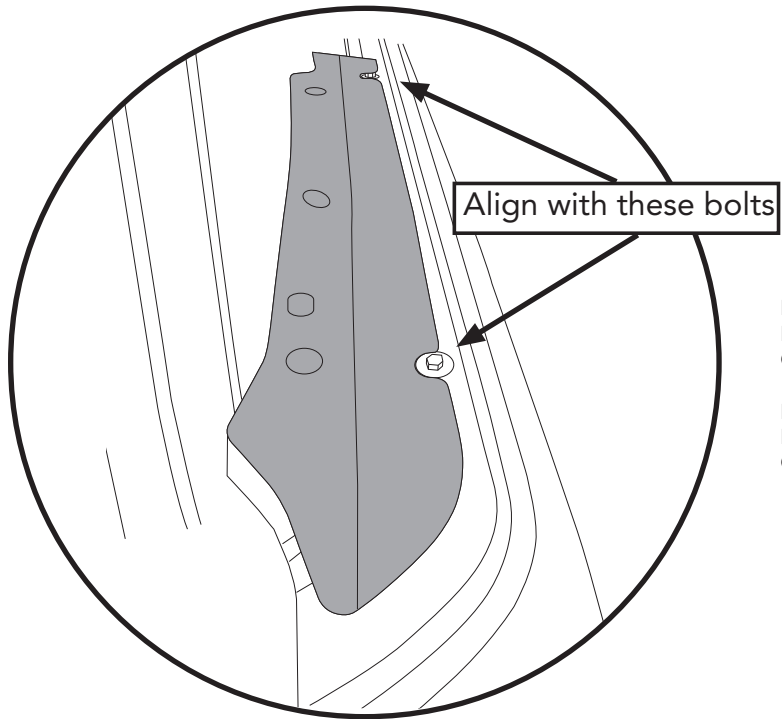

## Parts

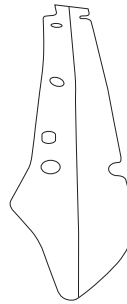

Rear Seal Film Right (Shown)  
Part #609.42  
Qty.1

Rear Seal Film Left  
Part #609.43  
Qty.1

## Step 2

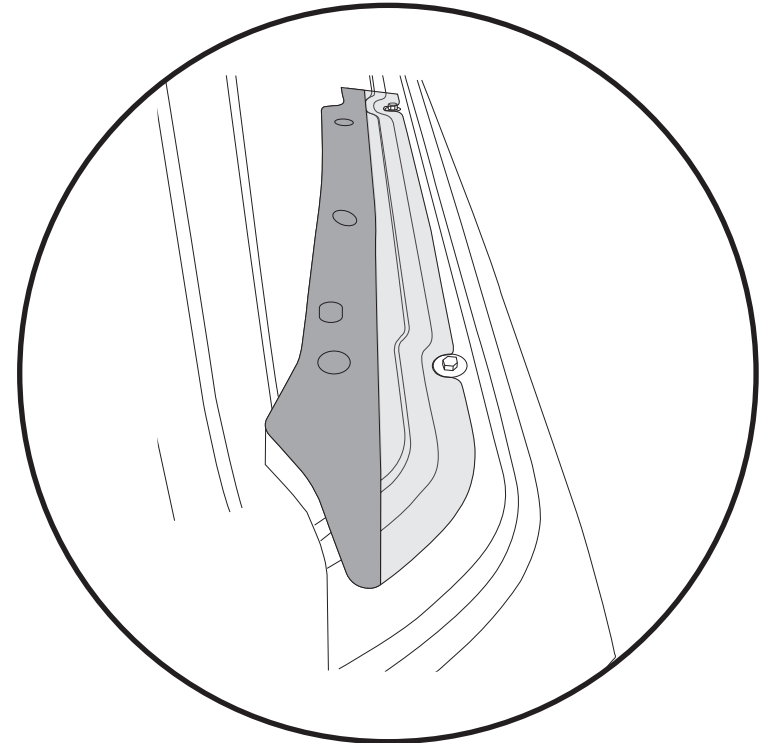

Align the cut outs to the fender bolts.

**Note:** It is very important to align the cut outs to the fender bolts first.

Remove the paper backing from the adhesive on the side with the cut outs and adhere the film to the vehicle.

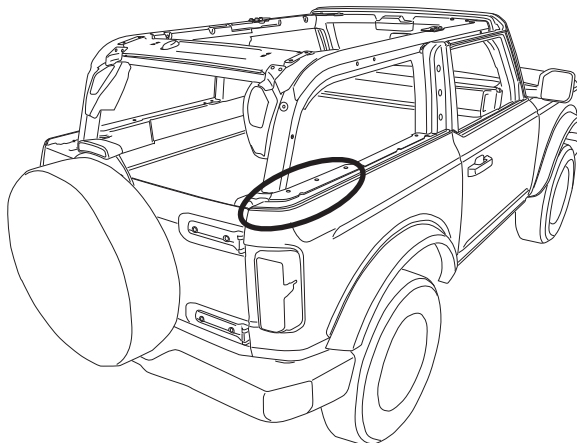

## Step 3

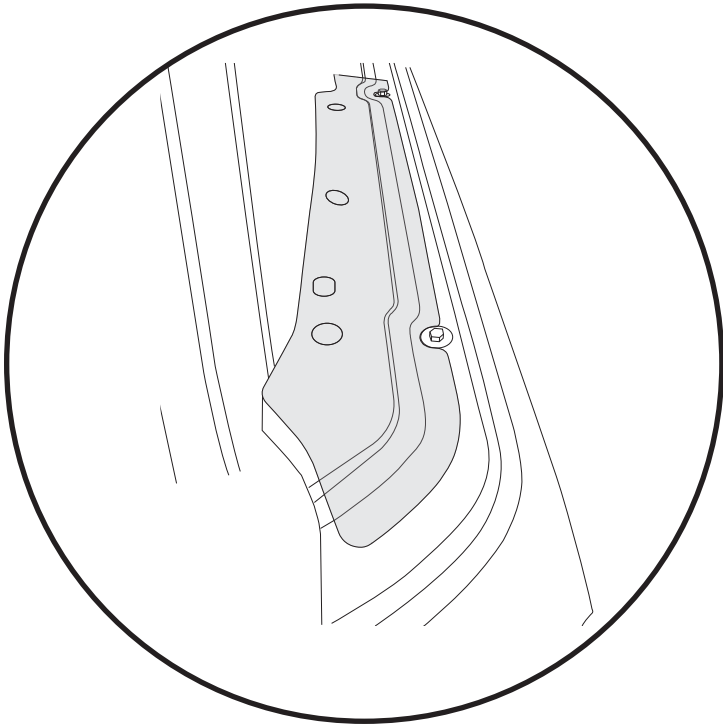

Remove the paper backing from the other side of the film and adhere the rest of the film to the vehicle.

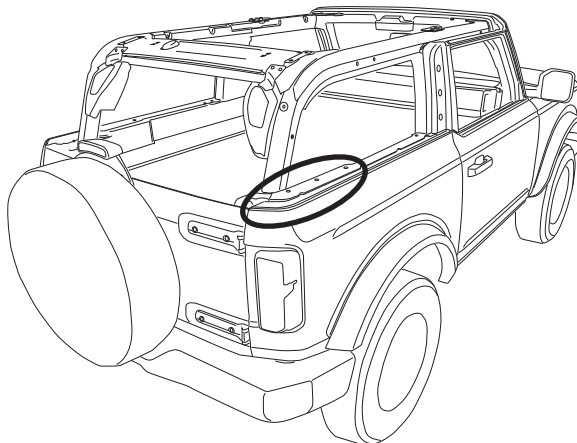

## Step 1

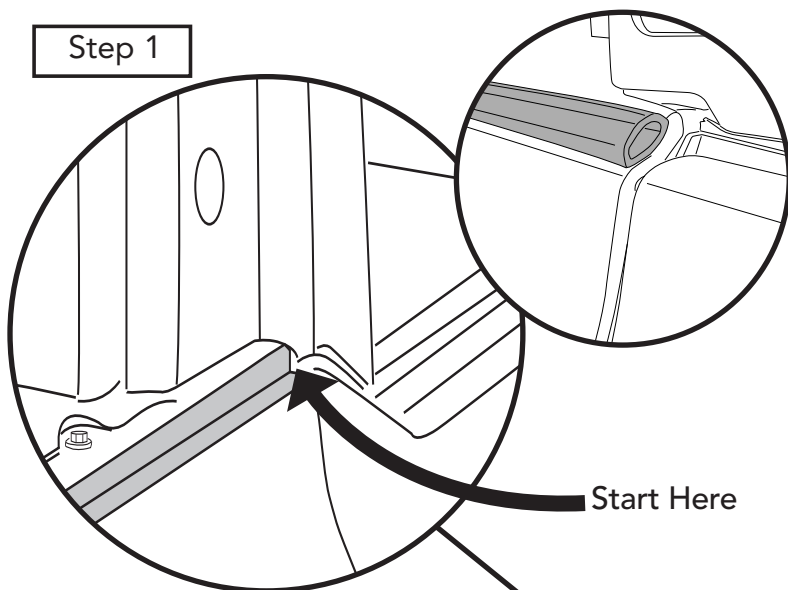

Wipe the edge of the body with the 50/50 Alcohol/Water solution with the soft cloth.

## Step 2

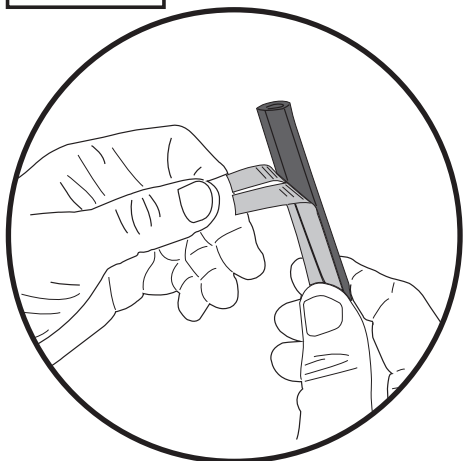

Start to remove the adhesive protective strip and place the end of the Seal down on the top edge of the body.

## Tools

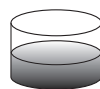

50/50 Alcohol  
water Solution



Soft Cloth



Scissors

## Parts



Seal, Belt  
Part #596.65  
Qty. 2

## Step 3

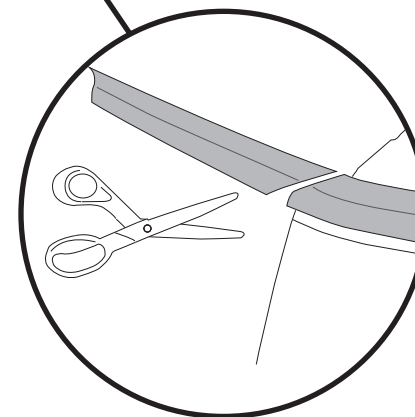
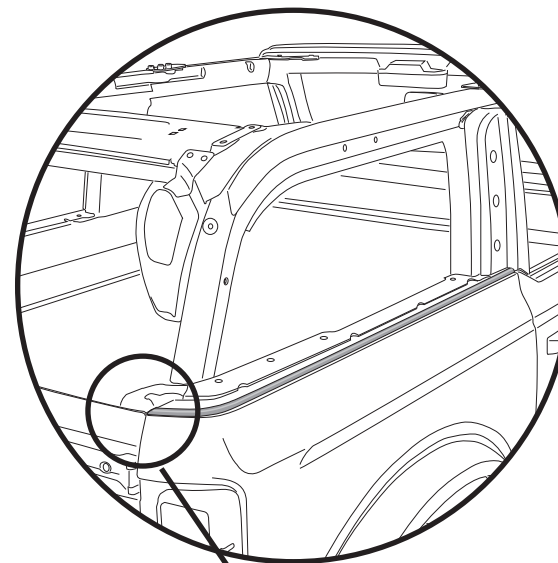

Continue removing the protective strip from the seal as you place it along the top edge of the body. When you reach the tailgate opening, Clip the excess seal with a pair of scissors.

Repeat these steps on the left side of the vehicle.

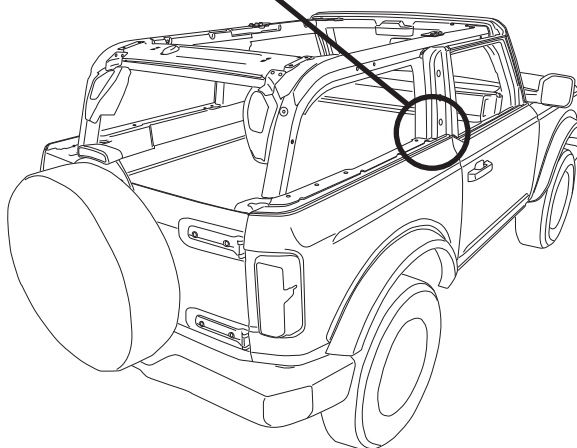



## Step 1

## Tools



T30  
Torx Driver

## Parts

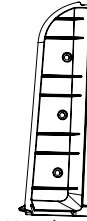

Vertical Window Retainer  
Right  
Part #597.58  
Qty. 1

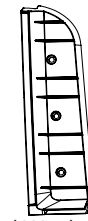

Vertical Window Retainer  
Left  
Part #597.59  
Qty. 1



SCREW, M6 X 1.0 X 30mm  
Part #533.19  
Qty. 6  
T-30 Torx

## Step 2

Remove three (3) bolts. Retain these bolts in case you want to re-install the hard top.

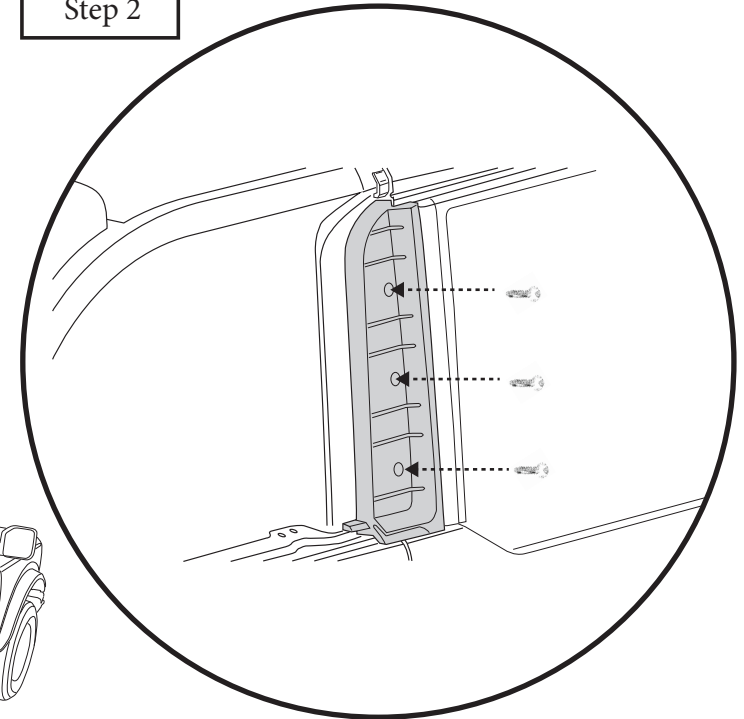
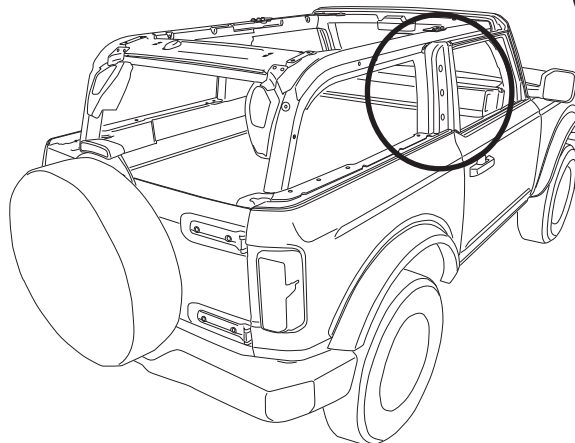

Place the Vertical Window Retainer Right (Part # 597.58) on the vehicle then attach with three (3) M6 x 30mm Screws (Part #533.19). Repeat this step on the left side of the vehicle.

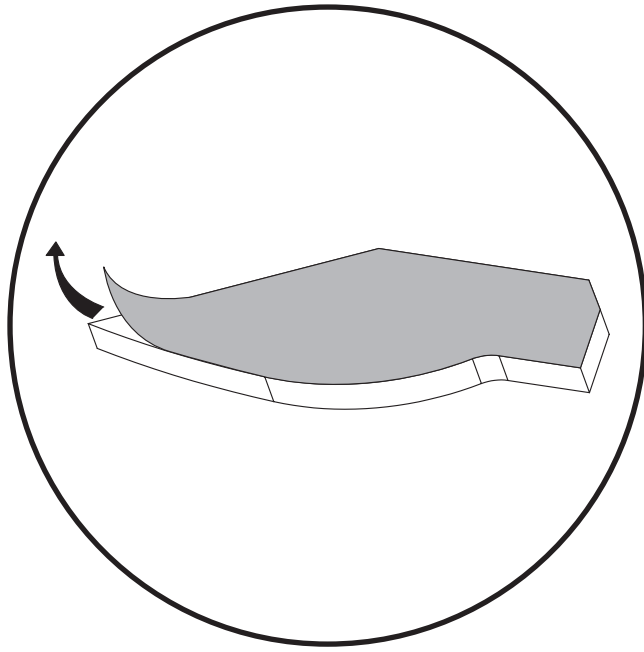

## Parts



Vertical Window Retainer  
Seal Right  
Part #608.72  
Qty. 1

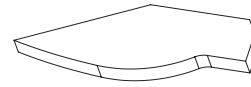

Vertical Window Retainer  
Seal Left  
Part #608.73  
Qty. 1

Peel the protective paper from the back of the Vertical Window Retainer Seal Right, (Part#608.72) flip it over then place it on the top of the of the Vertical Window Retainer Right.

Repeat this step on the left side of the vehicle.

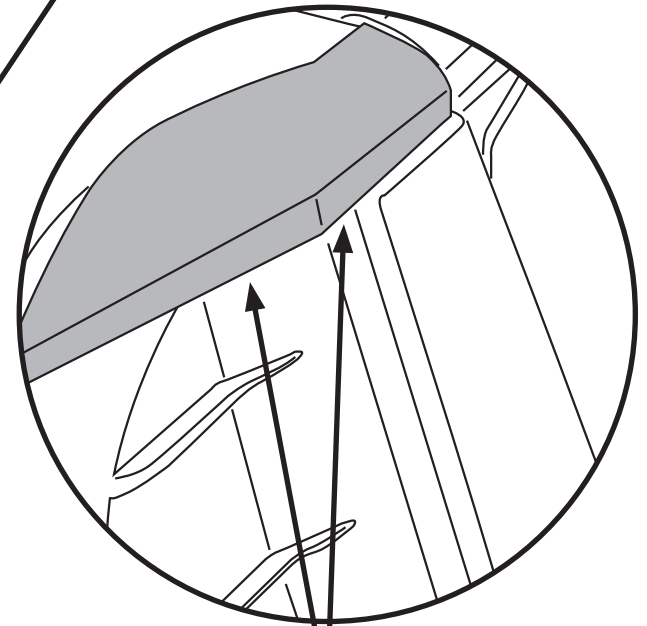
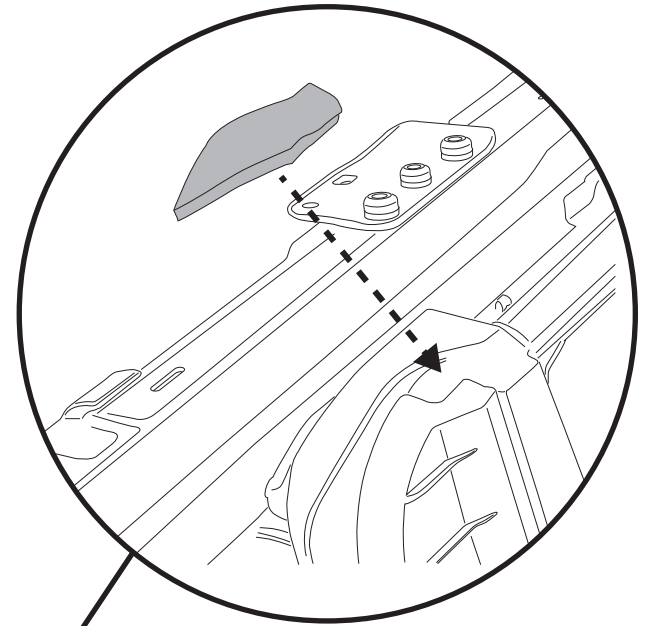
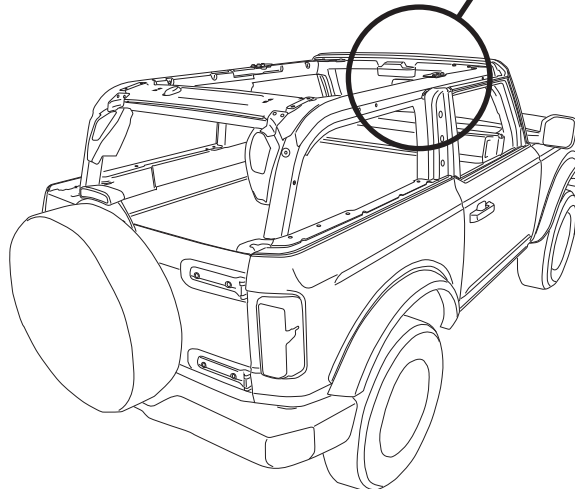

Align Here

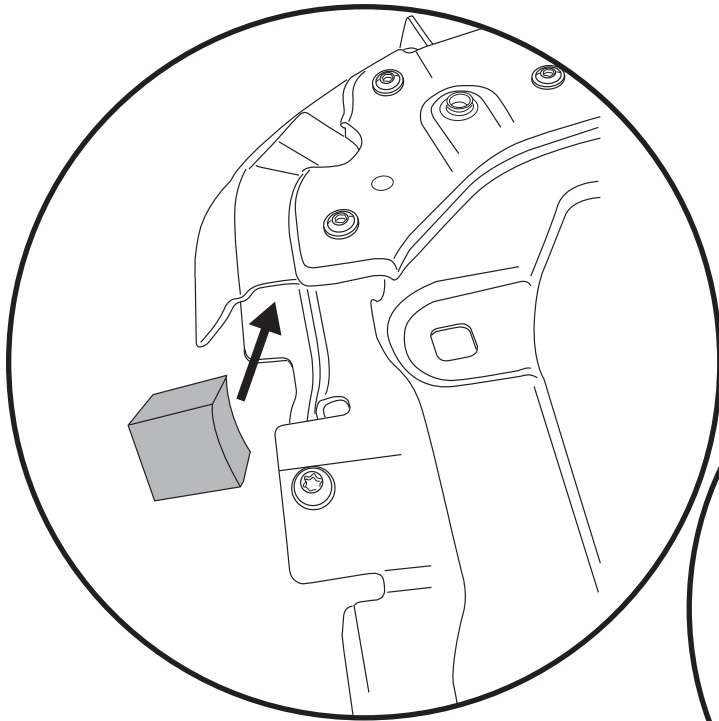

Insert the Tailgate Bar Retainer Foam between the upper and lower pieces of the Tailgate Bar Retainer.

Repeat this step on the left side Tailgate Bar Retainer.

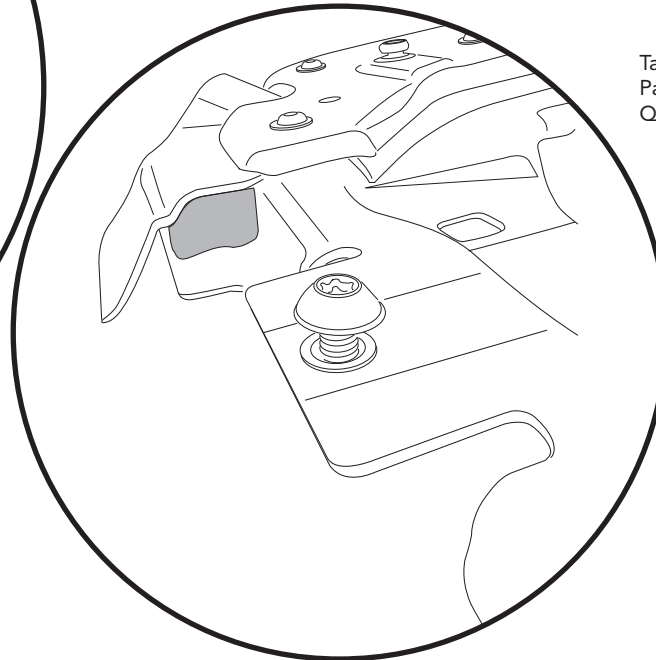
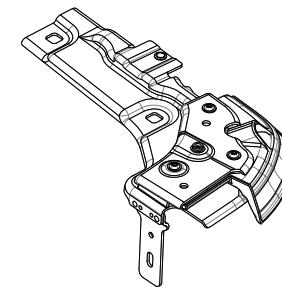
**Parts**

Tailgate Bar Retainer Right  
Part #609.26  
Qty. 1

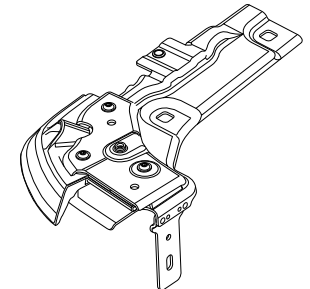

Tailgate Bar Retainer Left  
Part #609.27  
Qty. 1

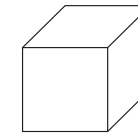

Tailgate Bar Retainer Foam  
Part #615.70  
Qty. 2

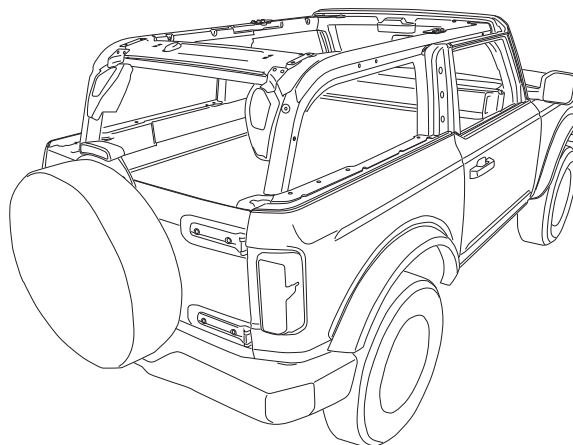

Step 1

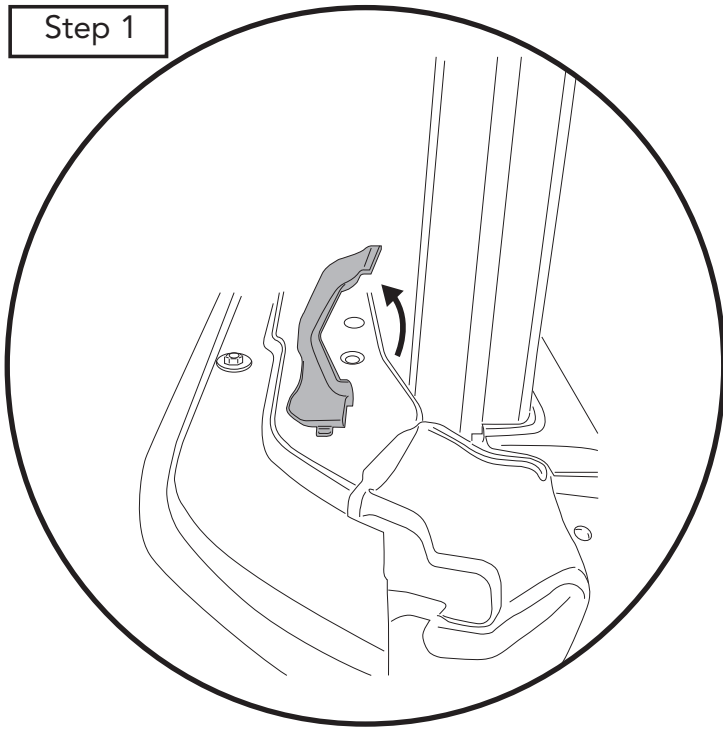

Remove plastic trim piece  
Start from the back to the front.

Repeat this step on the right side of  
the vehicle.

Step 2

Threaded mounting  
hole

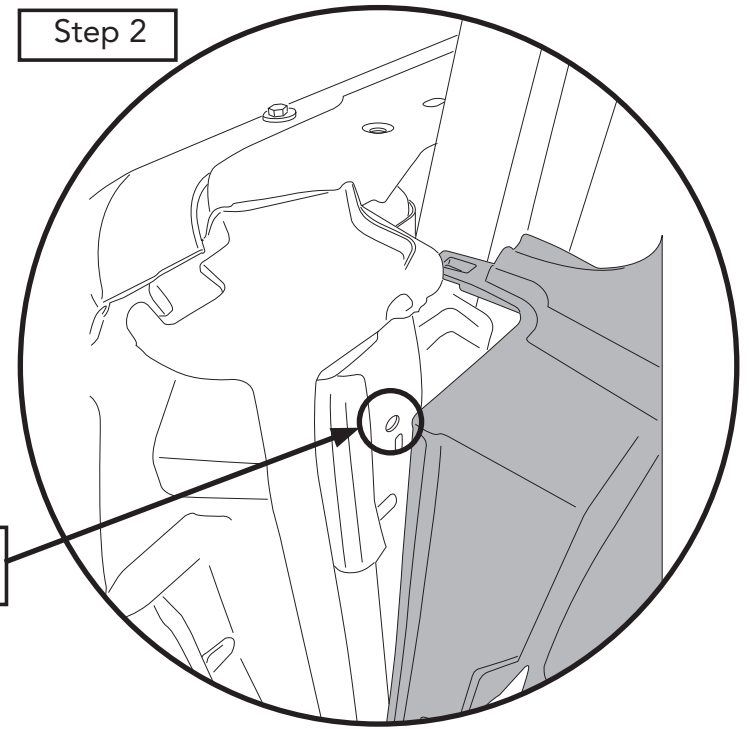

Pull back the top of the rear trim cover for access  
the threaded hole.

Repeat this step on the right side of the vehicle.

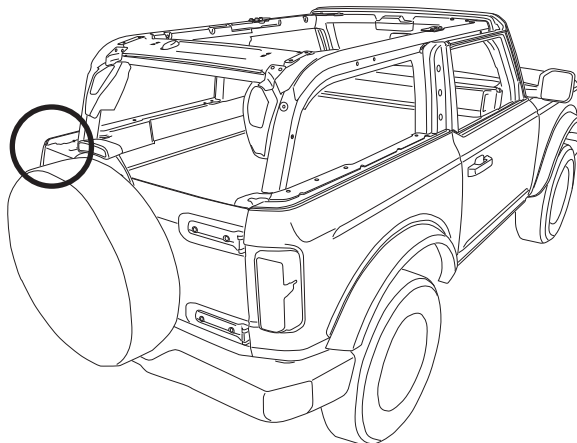

## Step 3

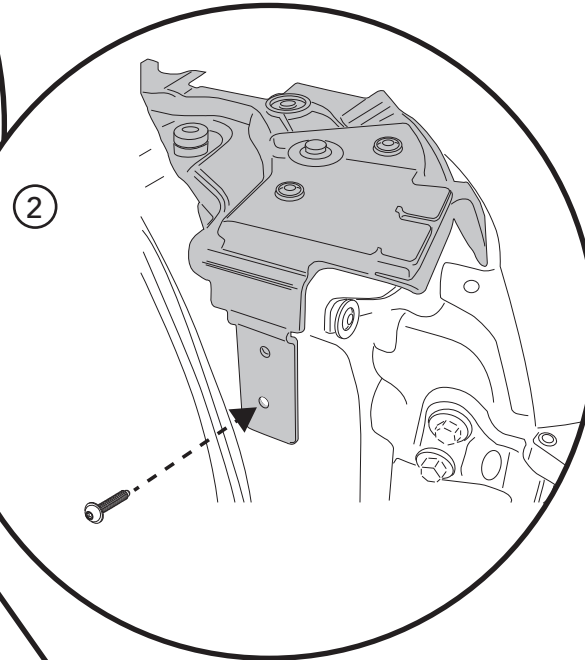
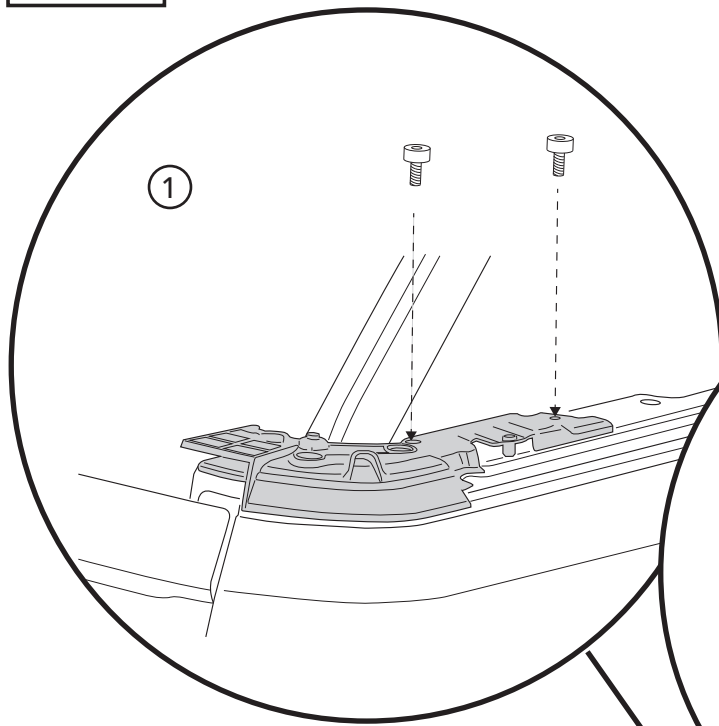

- ① Open the Tailgate.  
Place the Tailgate Bar Retainer (Part #609.26 Right Side) and (Part # 609.27 Left Side) on the corner of the vehicle and attach with two (2) M8 x 24mm bolts that were removed when the Hard Top was removed.
- ② Attach the tab that is hanging down into the tailgate opening with a M6 x 1.0 x 15 Screw (Part #533.61)  
Repeat this step on the left side of the vehicle.

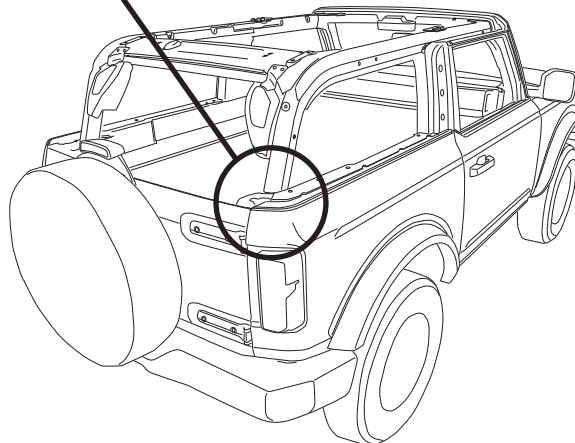

## Tools



T30  
Torx Driver

## Parts

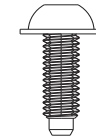

SCREW, M6 X 1.0 X 15mm  
Part #533.61  
Qty. 2  
T-30 Torx

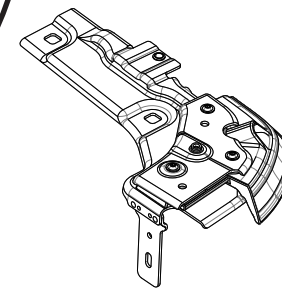

Tailgate Bar Retainer Right  
Part #609.26  
Qty. 1

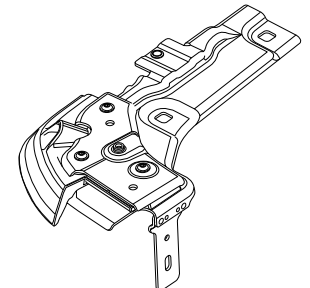

Tailgate Bar Retainer Left  
Part #609.27  
Qty. 1

**Tip**

Leave these fasteners loose until the Window Belt Retainers are installed. Then tighten all of the fasteners.

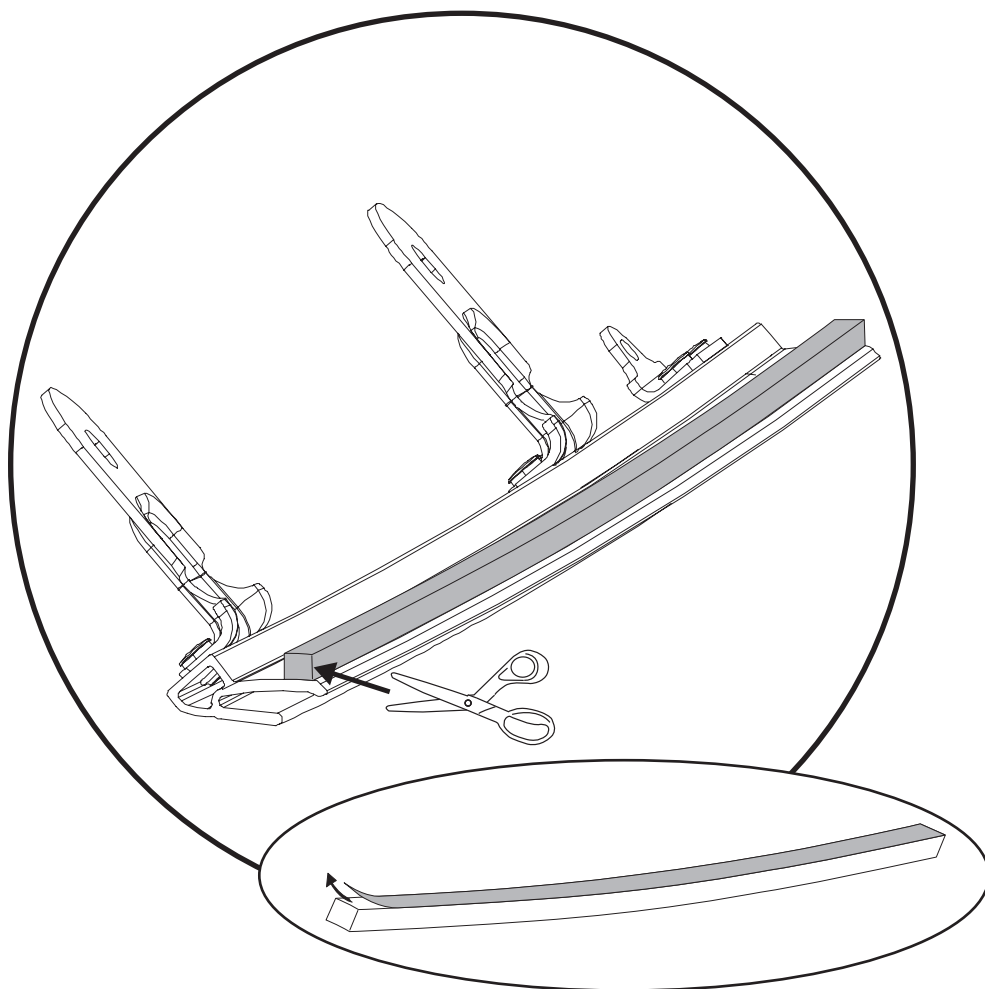

Peel the protective strip from the back of the Belt Rail Retainer Foam then place it on the under side of the Belt Rail Retainer. Cut off excessive foam with scissors.

Repeat this step on the left side Belt Rail Retainer.

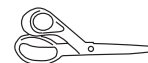
**Tools**

Scissors

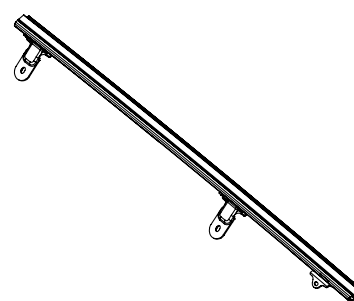
**Parts**

Belt Retainer Right  
Part #597.80  
Qty. 1

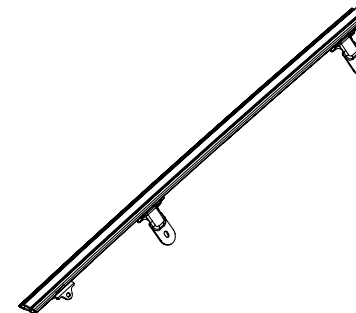

Belt Retainer Left  
Part #597.81  
Qty. 1



Belt Rail Retainer Foam  
Part #615.71  
Qty. 2

## Tools



T30  
Torx Driver

## Parts

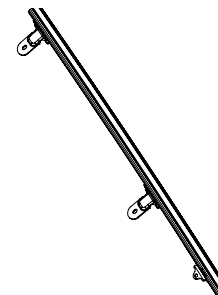

Belt Retainer Right  
Part #597.80  
Qty. 1

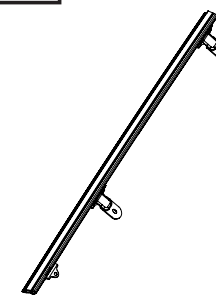

Belt Retainer Left  
Part #597.81  
Qty. 1

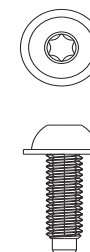

SCREW, M6 X 1.0 X 15mm  
Part #533.61  
Qty. 2  
T-30 Torx

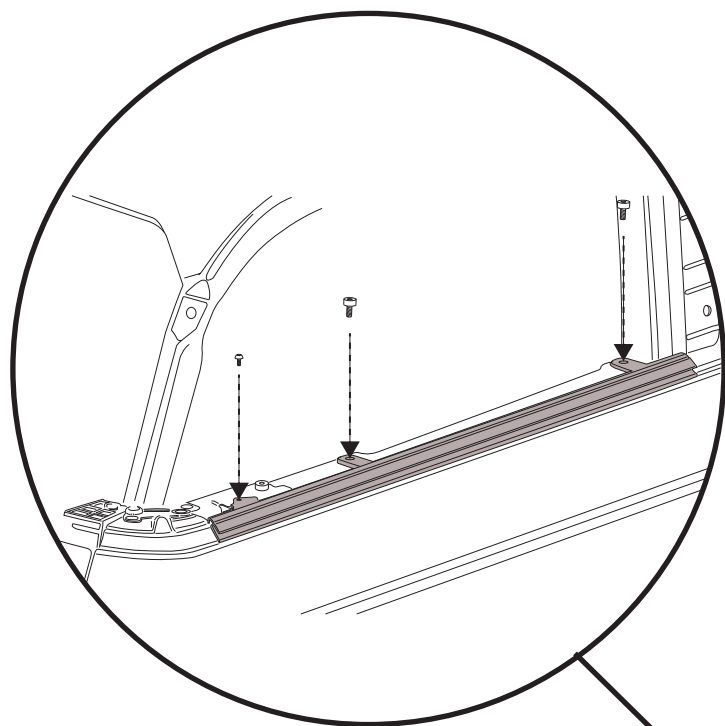

Attach the Belt Retainer Right (Part # 597.80) to the vehicle body using two (2) M8 x 24 mm Screws that were removed when the Hard Top was removed and one (1) M6 x 15mm screw (Part #533.61). Tighten the fasteners that mount the Belt Retainers and Corner Retainers.

Repeat this step on the left side of the vehicle.

## Tip

Remember to snap the rear trim covers back into place before closing the tailgate.

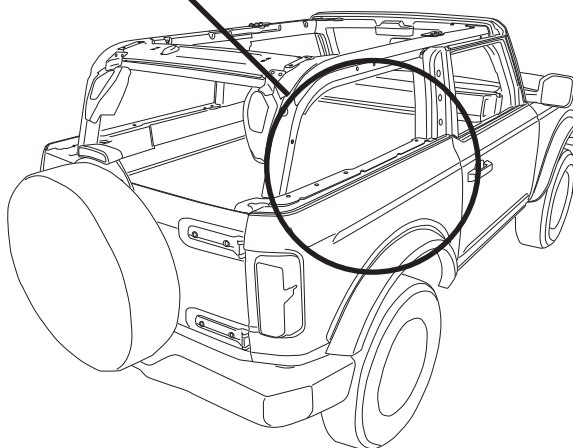



Step 1

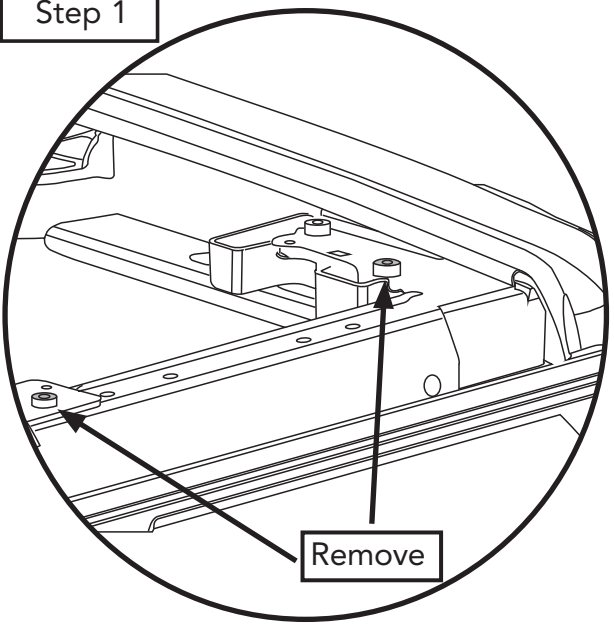

Remove the bolts from the vehicle (two from each side) and hold onto it. These bolts will be reused later in the installation.

**Note:** Remember the place where the fasteners were removed from.

Tools



T50  
Torx Driver

Parts

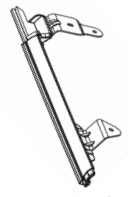

Front Door Rail Left  
Part #599.17  
Qty. 1



Front Door Rail Right  
Part #599.16  
Qty. 1



Spacer, 5.5MM  
Part #603.20  
Qty 2

Step 2

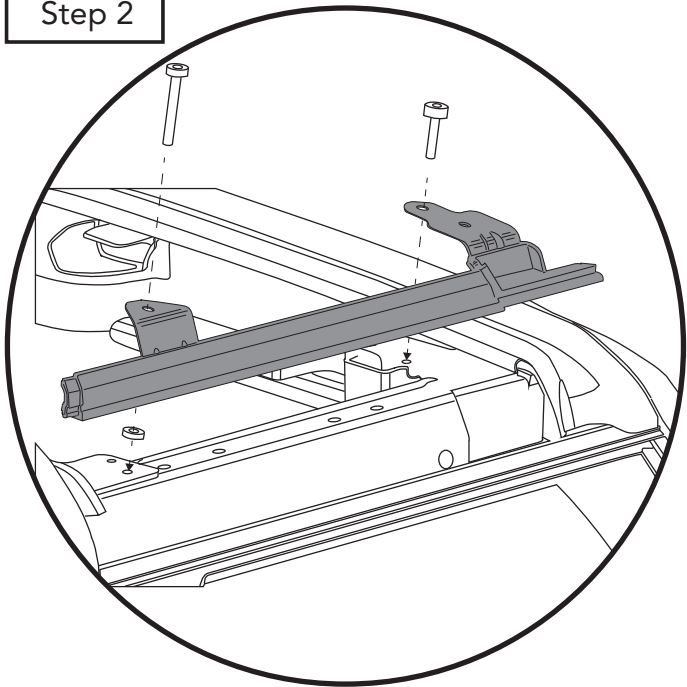

Attach Front Door Rails to the vehicle using the bolts that were removed from section 2 and one (1) 5.5 mm spacers (Part # 603.20).

Repeat this step on the left side of the vehicle.

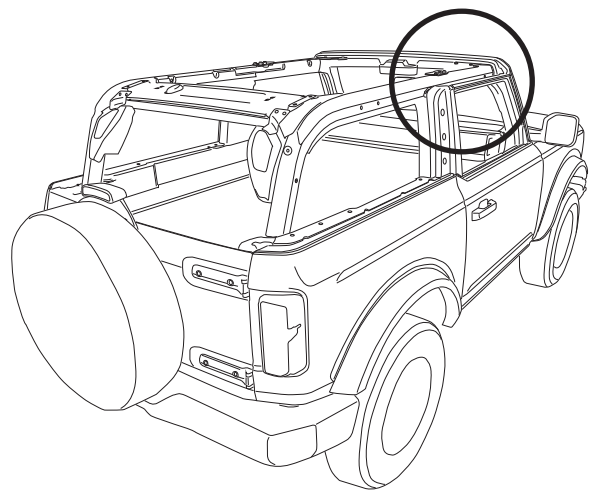

## Tools



T50  
Torx Driver



5mm  
Allen Wrench

## Parts

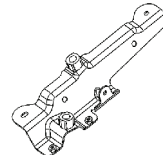

Main Pivot Bracket Right  
Part #602.60  
Qty 1

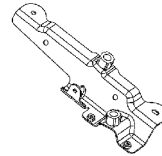

Main Pivot Bracket Left  
Part #602.61  
Qty 1

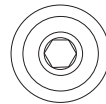

Screw, M8 X 1.25 X 30mm  
Part #583.63  
Qty. 2  
5mm Hex Socket



Spacer, 5.5MM  
Part #603.20  
Qty. 2

## Step 1

Remove

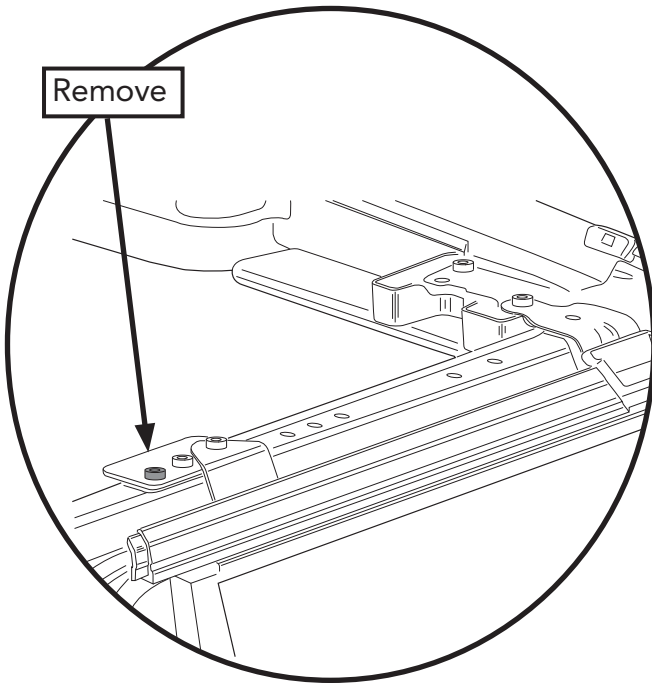

Remove the bolt shown in the illustration.

## Step 2

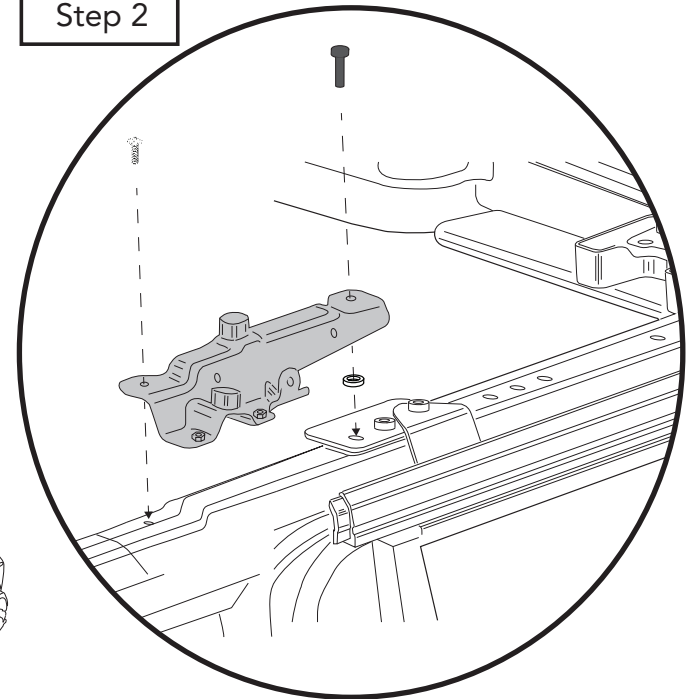

Install the Main Pivot Bracket Right (Part # 602.60) Using the bolt that was removed in Step 1, A 5.5mm Spacer (Part # 603.20) and one (1) M8 x 30mm Screw (Part # 583.63).

Repeat this step on the left side of the vehicle.

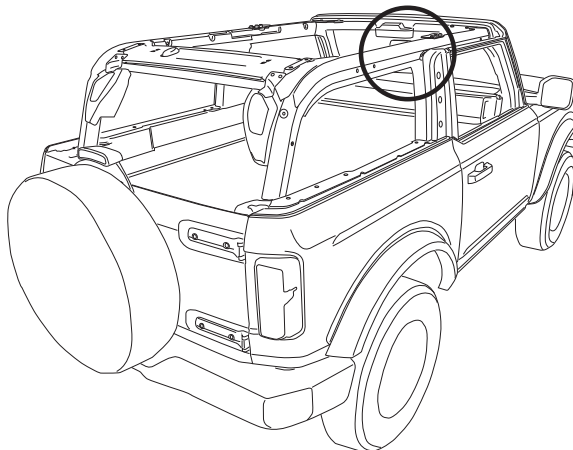

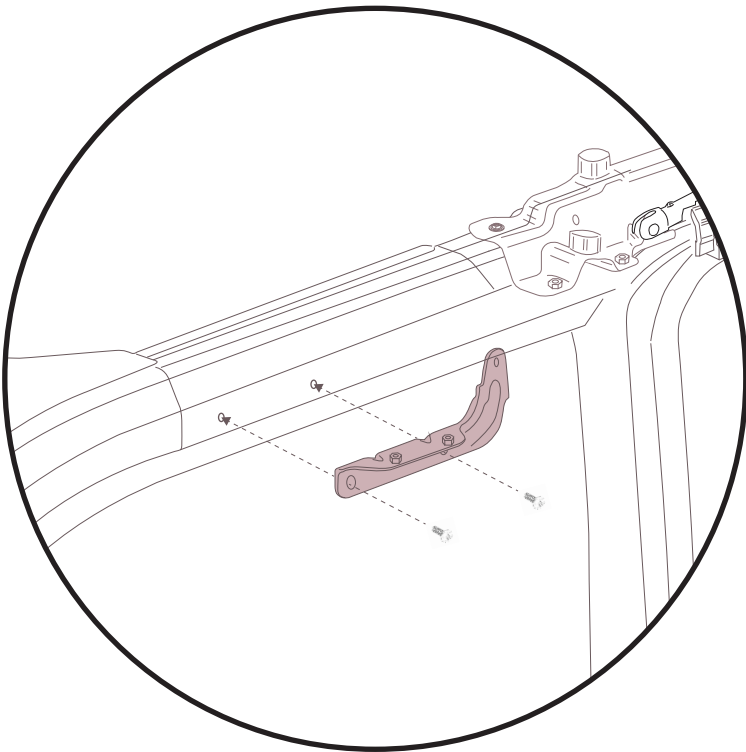

Attach the Link Control Bracket Right (Part # 598.18) using two (2) M8x30mm Screws (Part # 583.63).

Repeat this step on the left side of the vehicle.

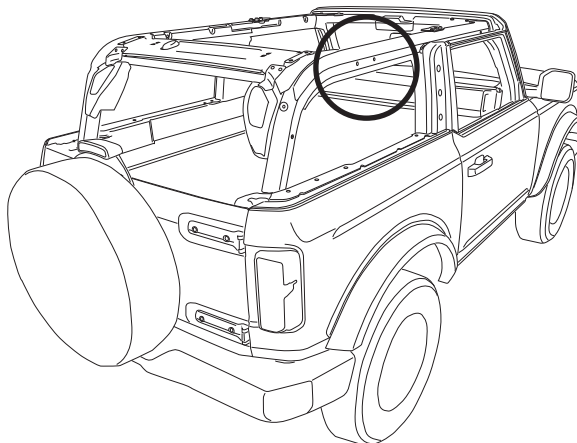

## Tools



5mm  
Allen Wrench

## Parts

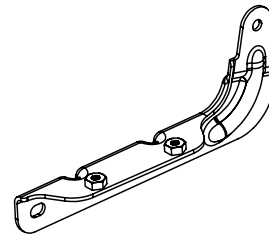

Link Control Bracket Right  
Part #598.18  
Qty. 1

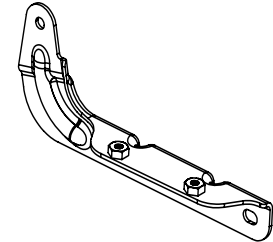

Link Control Bracket Left  
Part #598.19  
Qty. 1

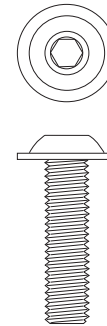

Screw, M8 X 1.25 X 30mm  
Part #583.63  
Qty. 4  
5mm Hex Socket

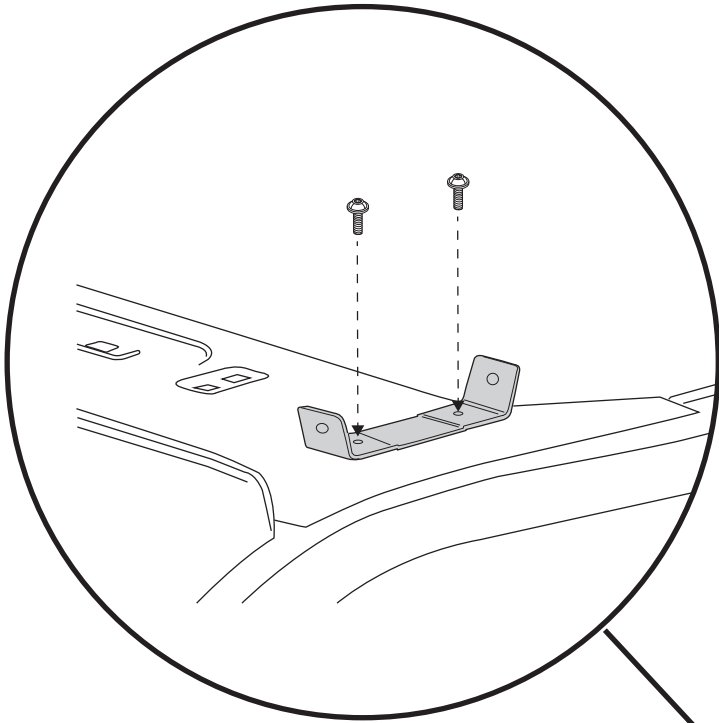

## Tools



5mm  
Allen Wrench

## Parts

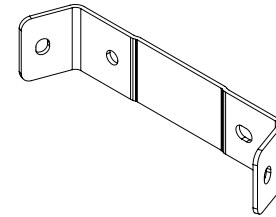

Rear Halo Mounting  
Bracket  
Part #599.39  
Qty. 2

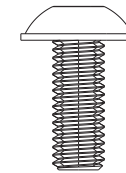
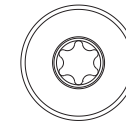

Screw, M8 X 1.25 X 20mm  
Part #573.09  
Qty. 4  
T-40 Torx

Attach the Rear Halo Mounting Brackets (Part # 599.39) with two (2) #573.09 screws.  
Repeat this step on the left side of the vehicle.

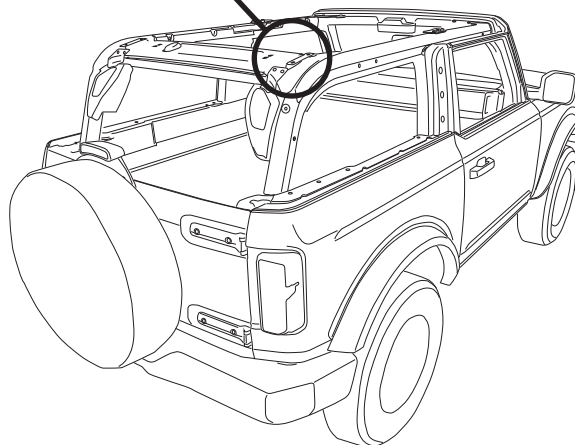

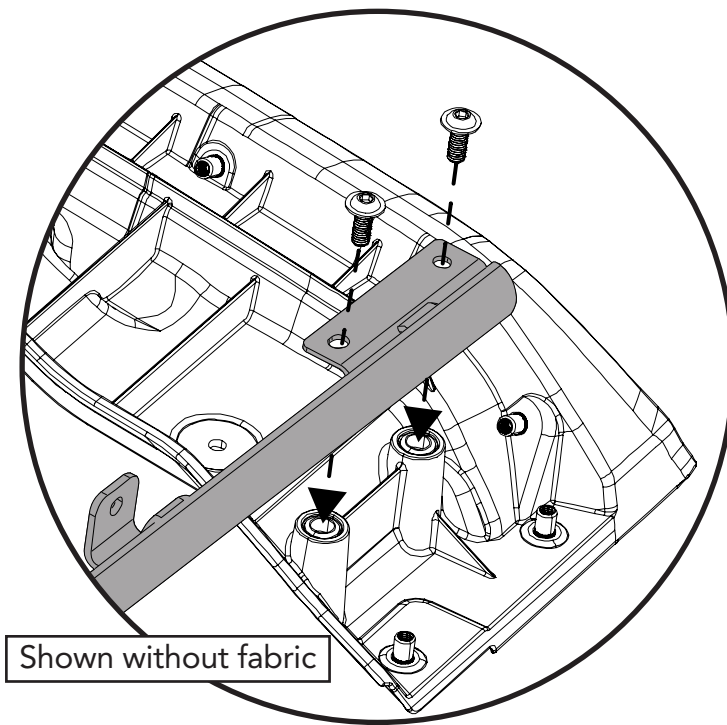

Shown without fabric

### Tools



T30  
Torx Driver

### Parts

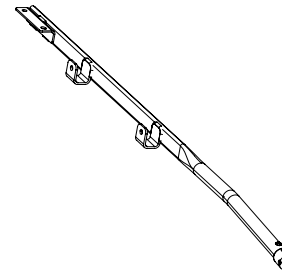

Front Side Rail Right  
Part #600.82  
Qty. 1

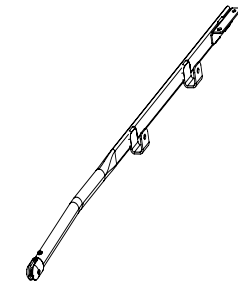

Front Side Rail Left  
Part #600.83  
Qty. 1

Place the Top (Deck Assembly) on a clean flat surface and fold the fabric forward to expose the #1 Bow (Molded part with the latches). Attach the side Bows Part # 600.82 (Right side) and 600.83 (Left side) using two (2) M6x1.0x15 Screws Part # 533.61.

Repeat this step on the left side.

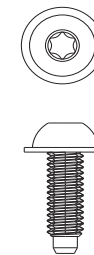

SCREW, M6 X 1.0 X 15mm  
Part #533.61  
Qty. 4  
T-30 Torx

## Tools



T30  
Torx Driver

## Parts



1.5 Bow Assembly  
Part #602.46  
Qty. 1



SCREW, Pivot Knuckle  
Part #308.65  
Qty. 2  
T-30 Torx

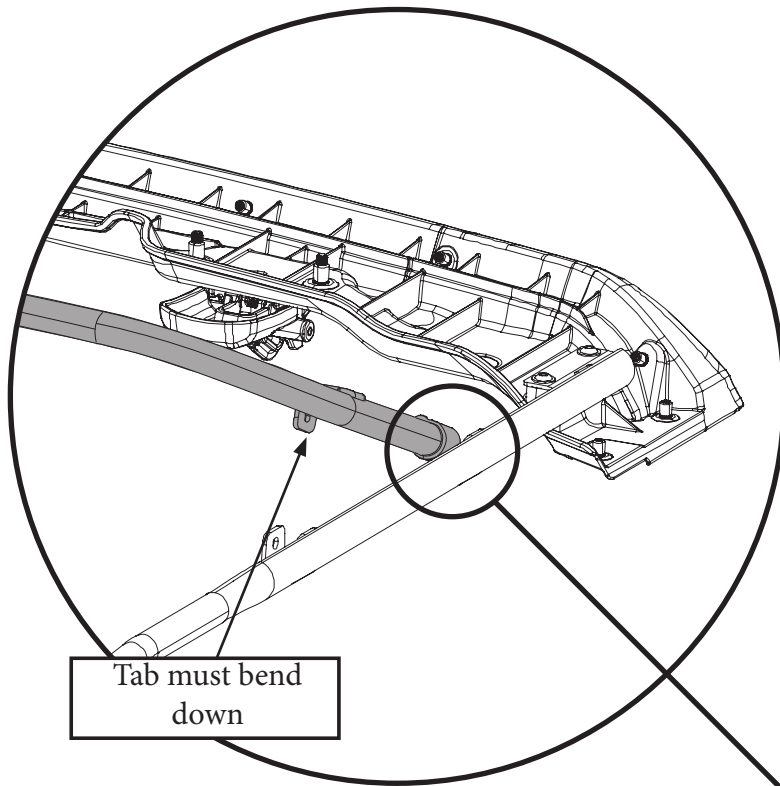

Attach the 1.5 Bow (Part #602.46) to the Front Side Rails using two (2) of the #308.65 screws.

Repeat this step on the left side of the vehicle.

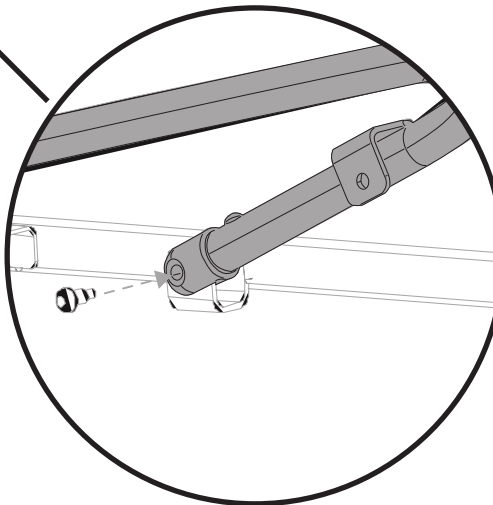

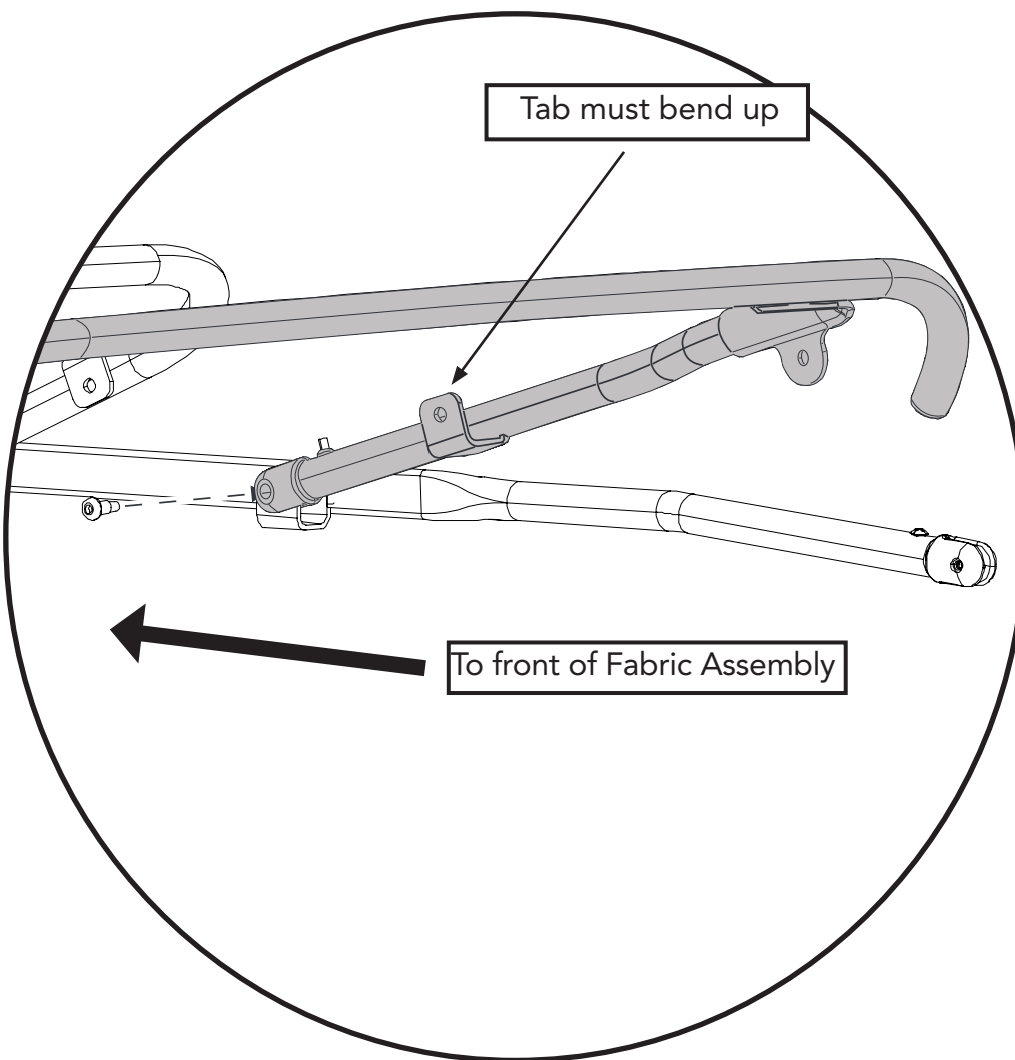

Tools



T30  
Torx Driver

Parts

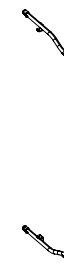

#2 Bow Assembly  
Part #600.84  
Qty. 1



SCREW, Pivot Knuckle  
Part #308.65  
Qty. 2  
T-30 Torx

Attach the 2 Bow (Part #600.84) to the Front Side Rails using two (2) of the #308.65 screws.

Repeat this step on the left side of the vehicle.



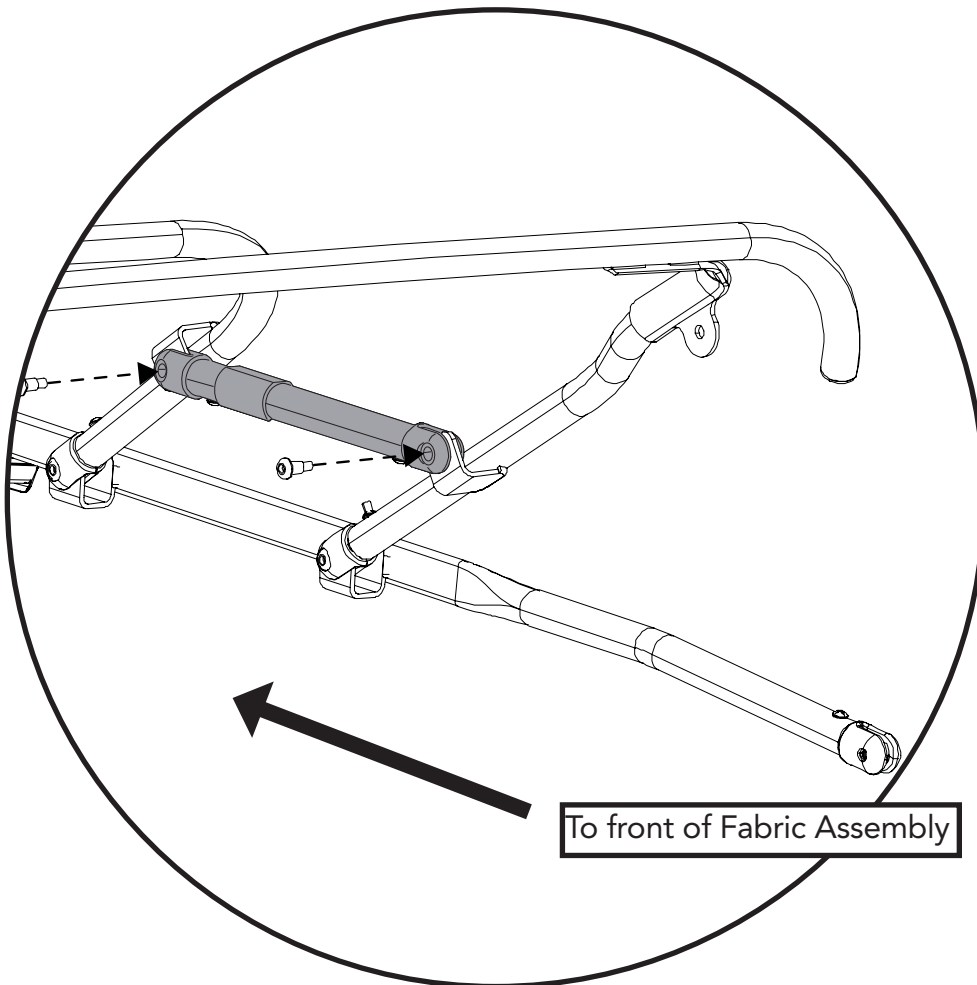

Attach the Control Linkage (Part #602.75) to the Front Side Rails using two (2) of the #308.65 screws.

Repeat this step on the left side of the vehicle.

#### Tools



T30  
Torx Driver

#### Parts



Control Linkage  
Part #602.75  
Qty. 2



SCREW, Pivot Knuckle  
Part #308.65  
Qty. 4  
T-30 Torx

## Parts

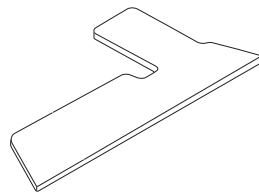
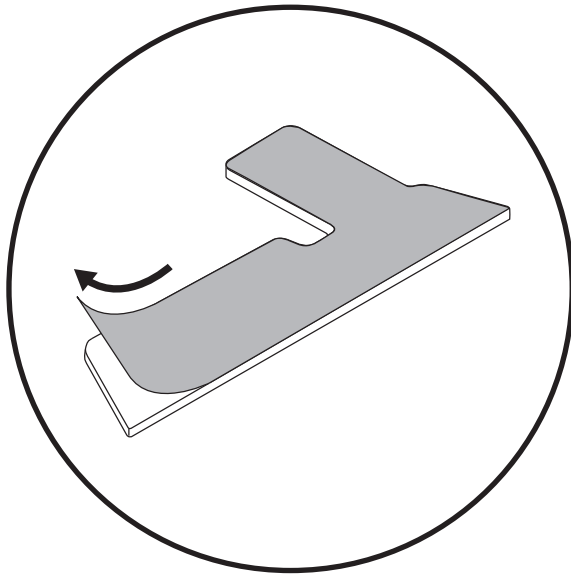

#1 Bow Foam Seal Rt  
Part #615.66  
Qty. 1

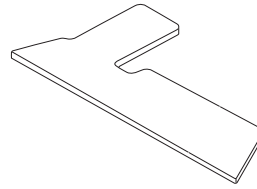

#1 Bow Foam Seal Lt  
Part #615.67  
Qty. 1

Peel the protective paper from the back of the #1 Bow Foam Seal (Part #615.66) then place it on the side of the #1 Bow.

Repeat this step on the left side of the vehicle.

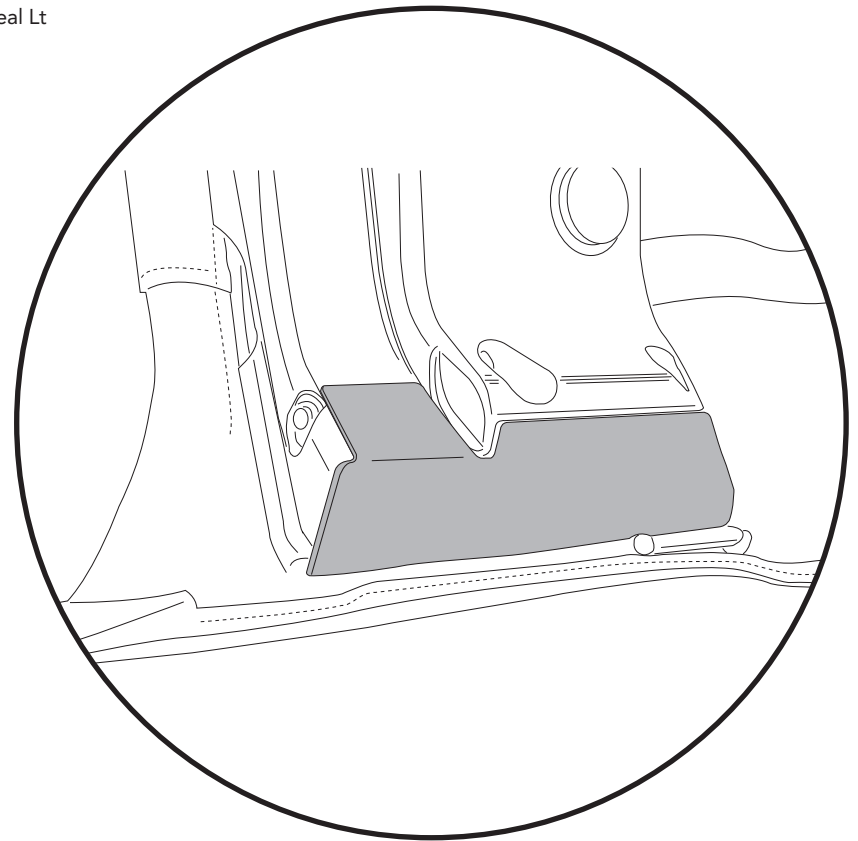

## Tools



T30  
Torx Driver

## Tip

It will be easier lifting the fabric assembly onto the vehicle with two people.

## Parts



SCREW, Pivot Knuckle  
Part #308.65  
Qty. 2  
T-30 Torx

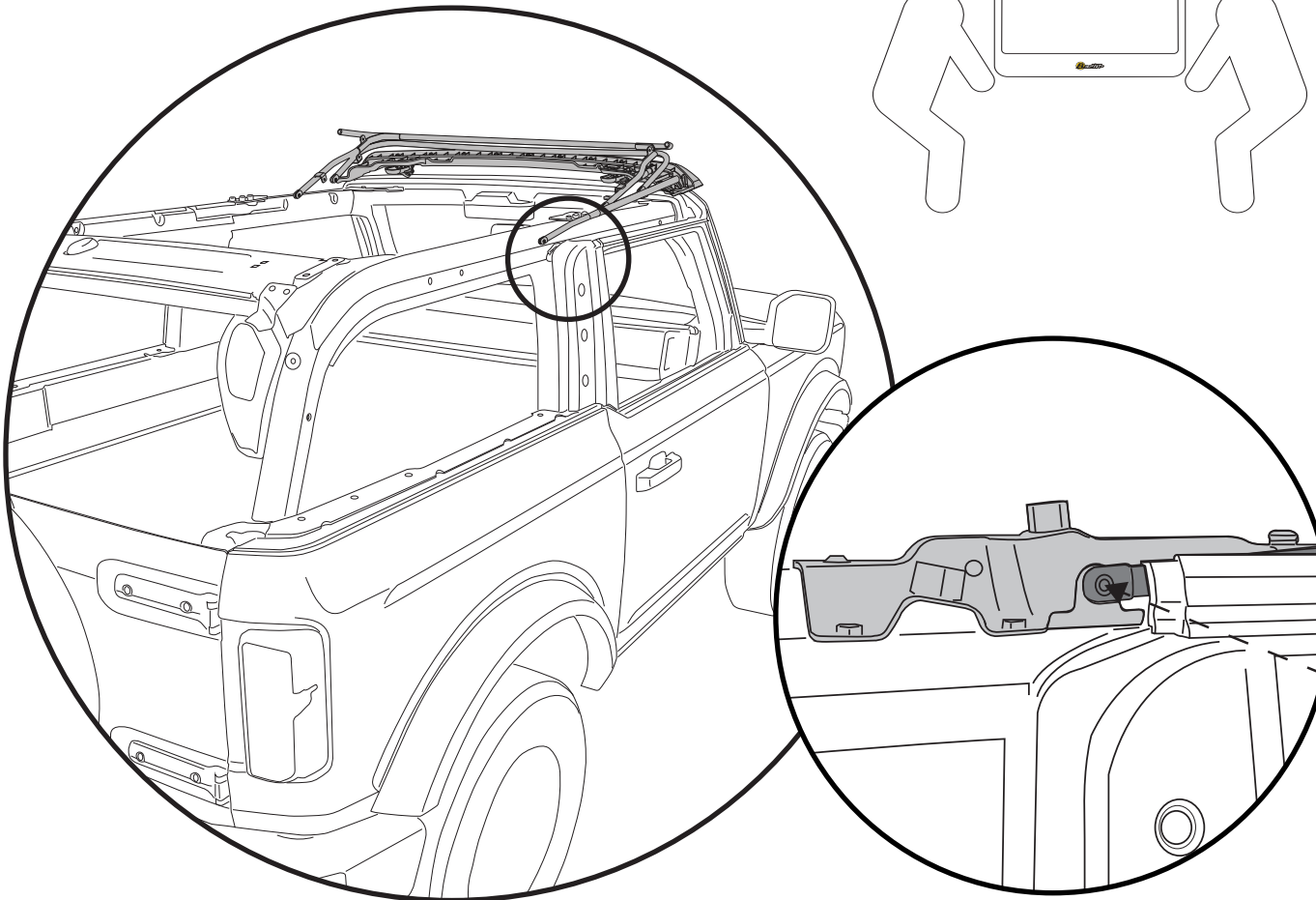

Have someone help you lift the top assembly on top of the vehicle with the side bows going towards the rear of the vehicle. Attach the Side Bow to the Main Pivot Brackets using one (1) Pivot Knuckle Screw (Part #308.65).

Repeat this step on the left side of the vehicle.

## Tip

Remove antenna to make access to the right side of the vehicle easier.

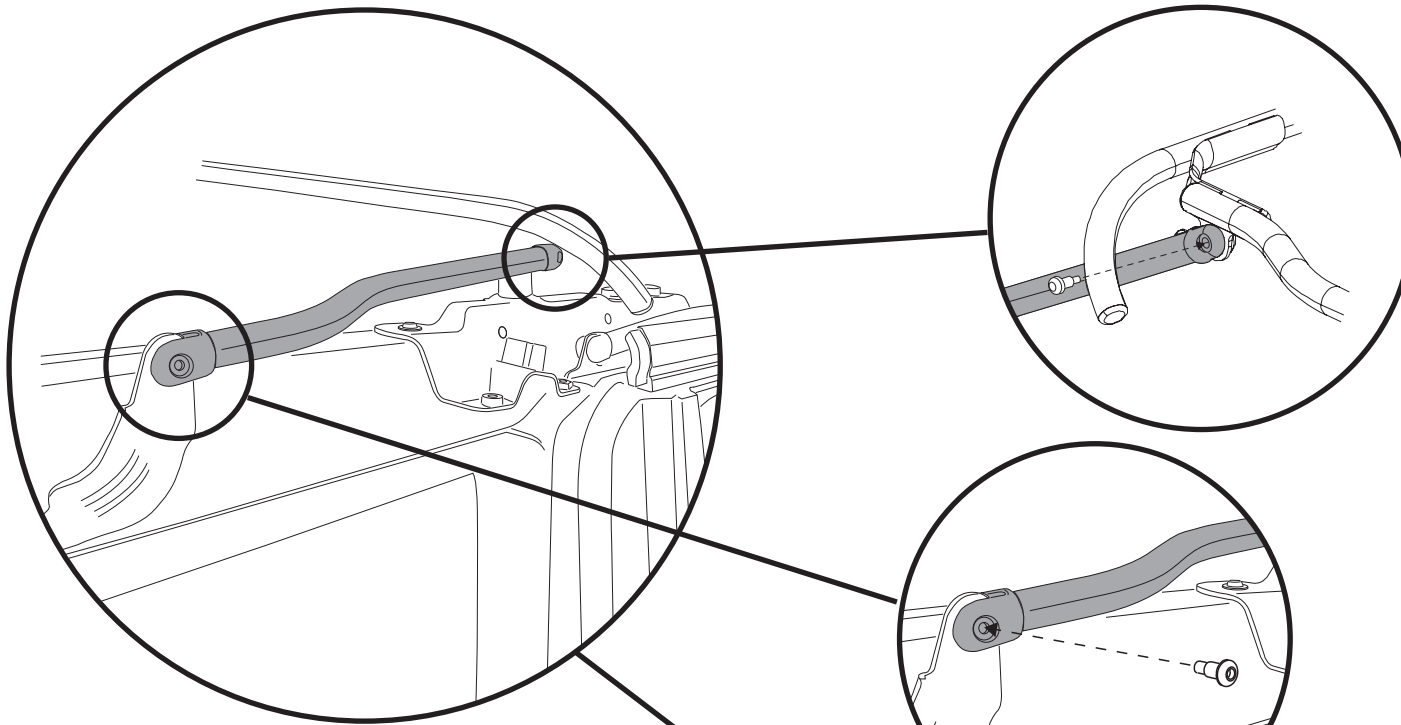

Attach the #2 Bow Control Linkage (Part #598.00) to the Link Control Bracket Then to the #2 bow using two (2) of the Pivot Knuckle Screws (Part #308.65).

Repeat this step on the left side of the vehicle.

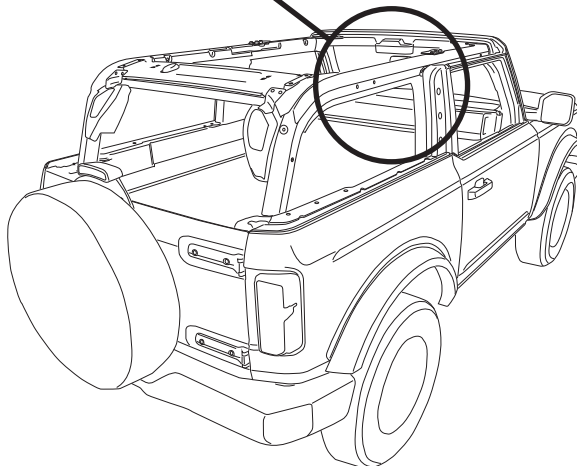

## Tools



T30  
Torx Driver

## Parts



#2 Bow Control Link  
Part #598.00  
Qty. 2



SCREW, Pivot Knuckle  
Part #308.65  
Qty. 4  
T-30 Torx

## Tools



T30  
Torx Driver

## Parts

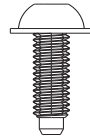

SCREW, M6 X 1.0 X 15mm  
Part #533.61  
Qty. 4  
T-30 Torx

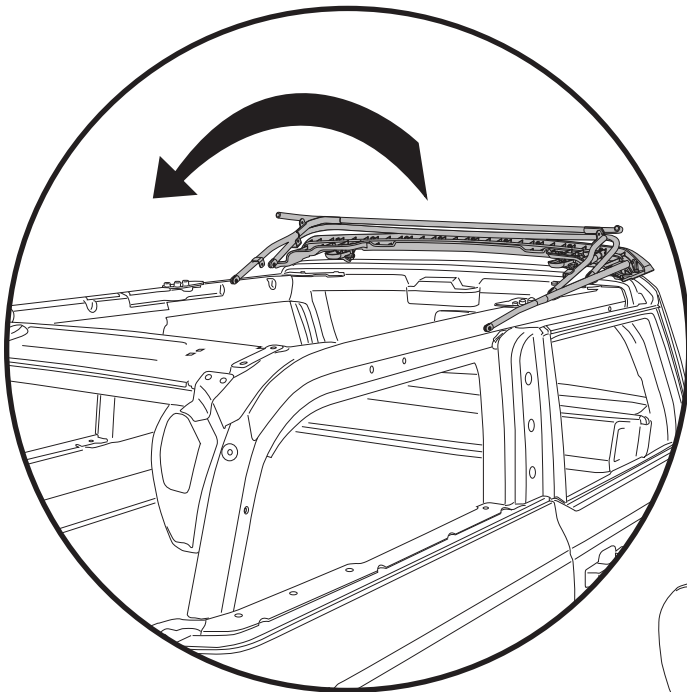

Fold the front of the top (Header) back.

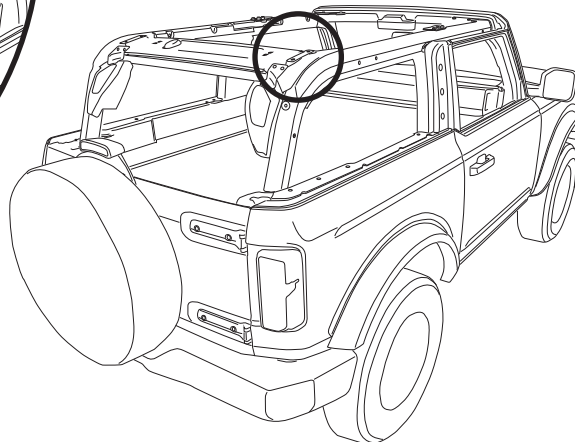
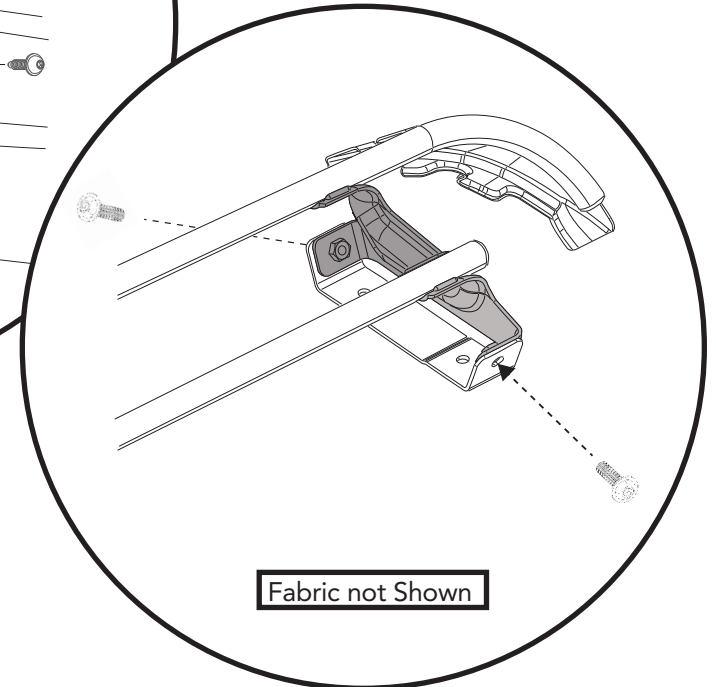
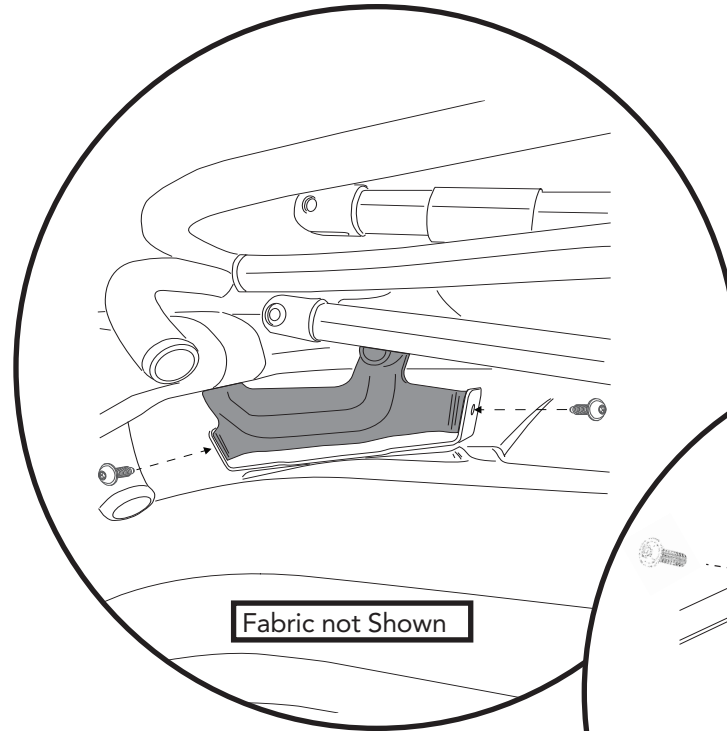

Attach The Rear Halo to the Rear Halo Mounting Bracket using two (2) of the M6 x 15mm screws (Part # 533.61) per side.

Repeat this step on the left side of the vehicle.

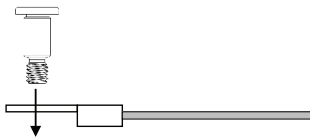
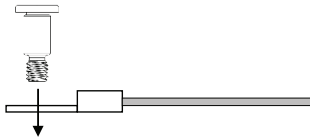
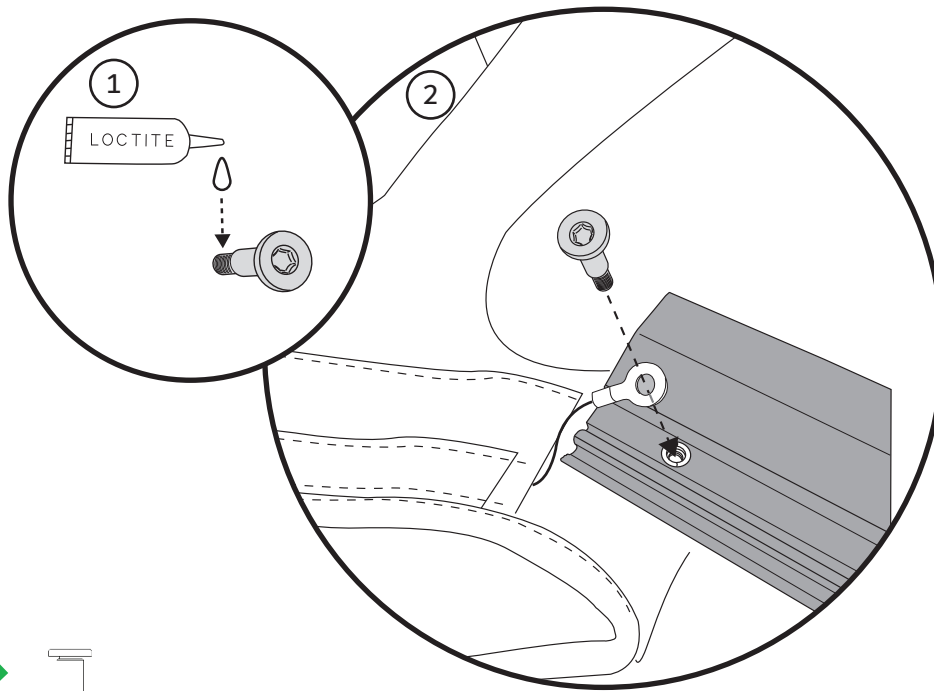

① Place one (1) drop of Loctite to the Shoulder Bolt.

Find the Cable End in the Fabric Assembly.

② Attach it to the Upper Quarter Window Retainers (Part #599.06) for the passenger side and (Part # 599.07) for the driver side using one (1) Shoulder Bolt (Part # 665.42) per side.

Repeat this step on the left side of the vehicle.

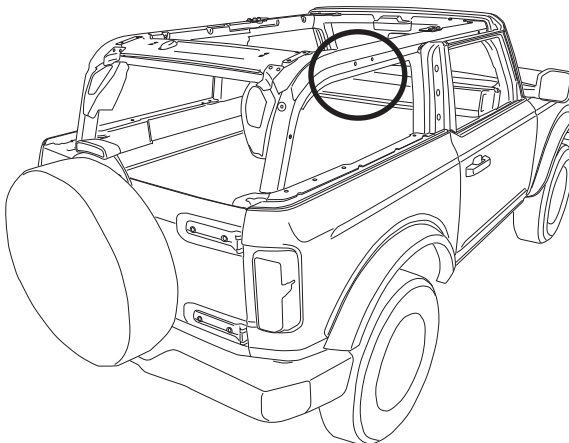

### Tools



### Parts



Retainer, Upper Quarter Window Right  
Part #599.06  
Qty. 1



Retainer, Upper Quarter Window Left  
Part #599.07  
Qty. 1



Loctite Capsule  
Part #309.83  
Qty. 1

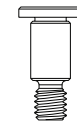

M4 x 8mm Shoulder Bolt  
#665.42  
Qty. 2  
2.5mm Hex Key

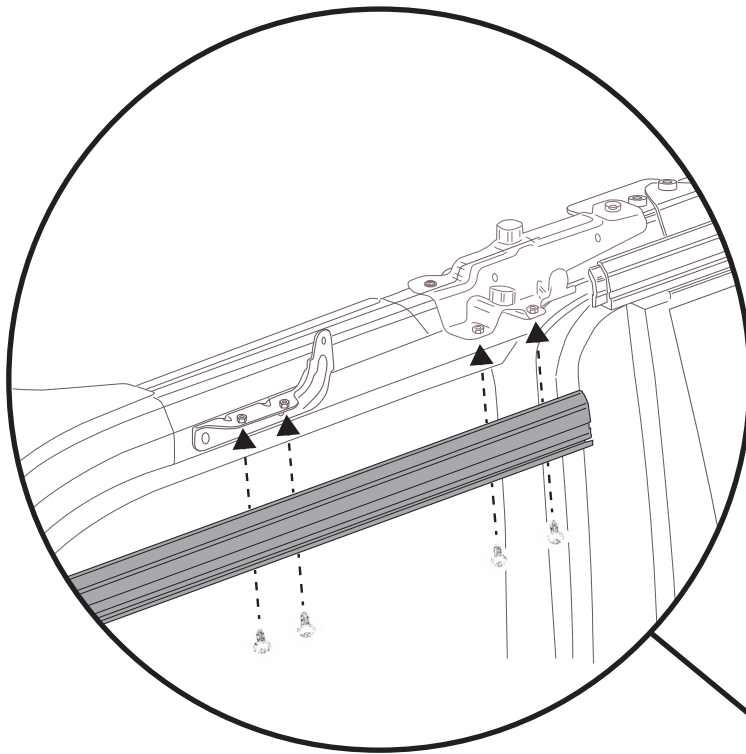

Attach the Upper Quarter Window Retainer Right (Part # 599.06) (#599.07 Left Side) to the Control Linkage Bracket and the Main Pivot Brackets using four (4) M6 x 15mm Screws (Part # 533.61).

Repeat this step on the left side of the vehicle.

## Tools



T30  
Torx Driver

## Parts



Retainer, Upper Quarter  
Window Right  
Part #599.06  
Qty. 1



Retainer, Upper Quarter  
Window Left  
Part #599.07  
Qty. 1

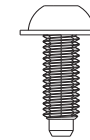

SCREW, M6 X 1.0 X 15mm  
Part #533.61  
Qty. 4  
T-30 Torx

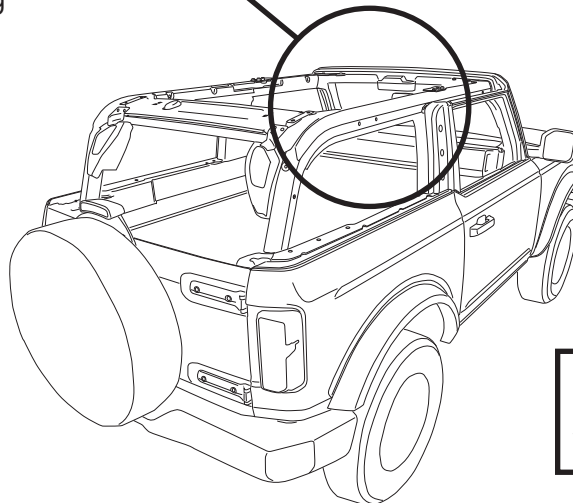

## Congratulations

You have finished installing the hardware.



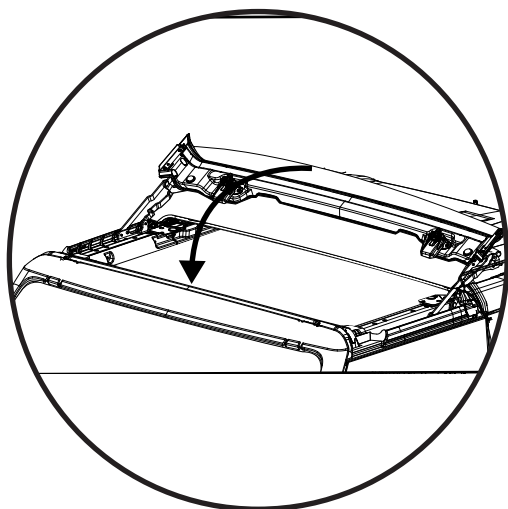

Fold the Sunrider forward.

Secure both latches to the vehicle's windshield header.

- ① Pivot the latch handle down;
- ② Engage the hook;
- ③ Pivot the latch handle back up.

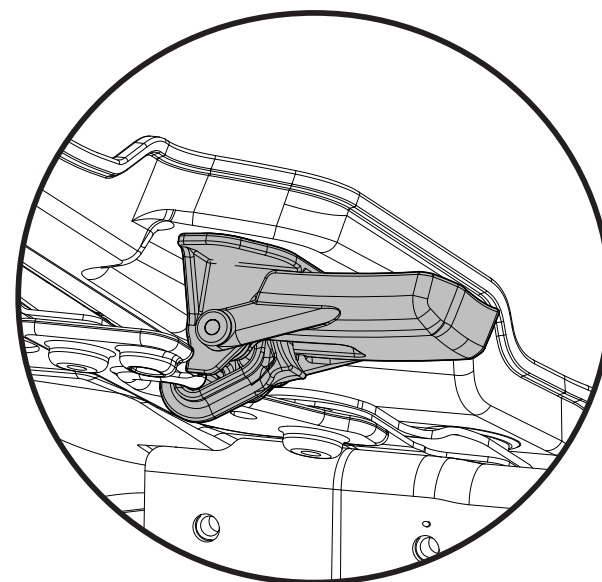
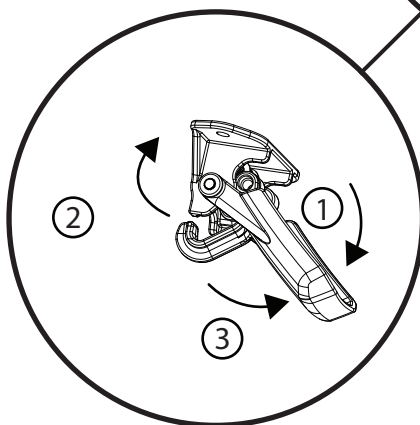
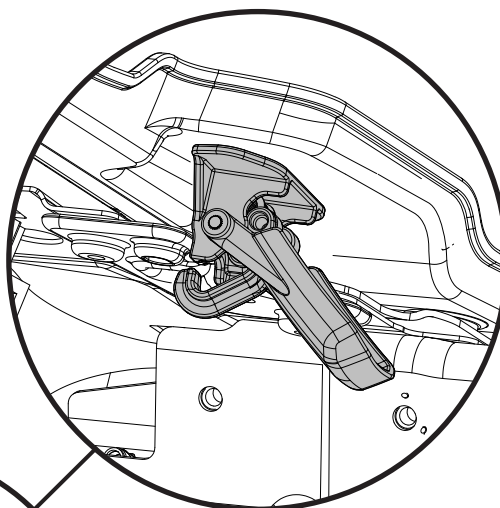

Latch in closed position

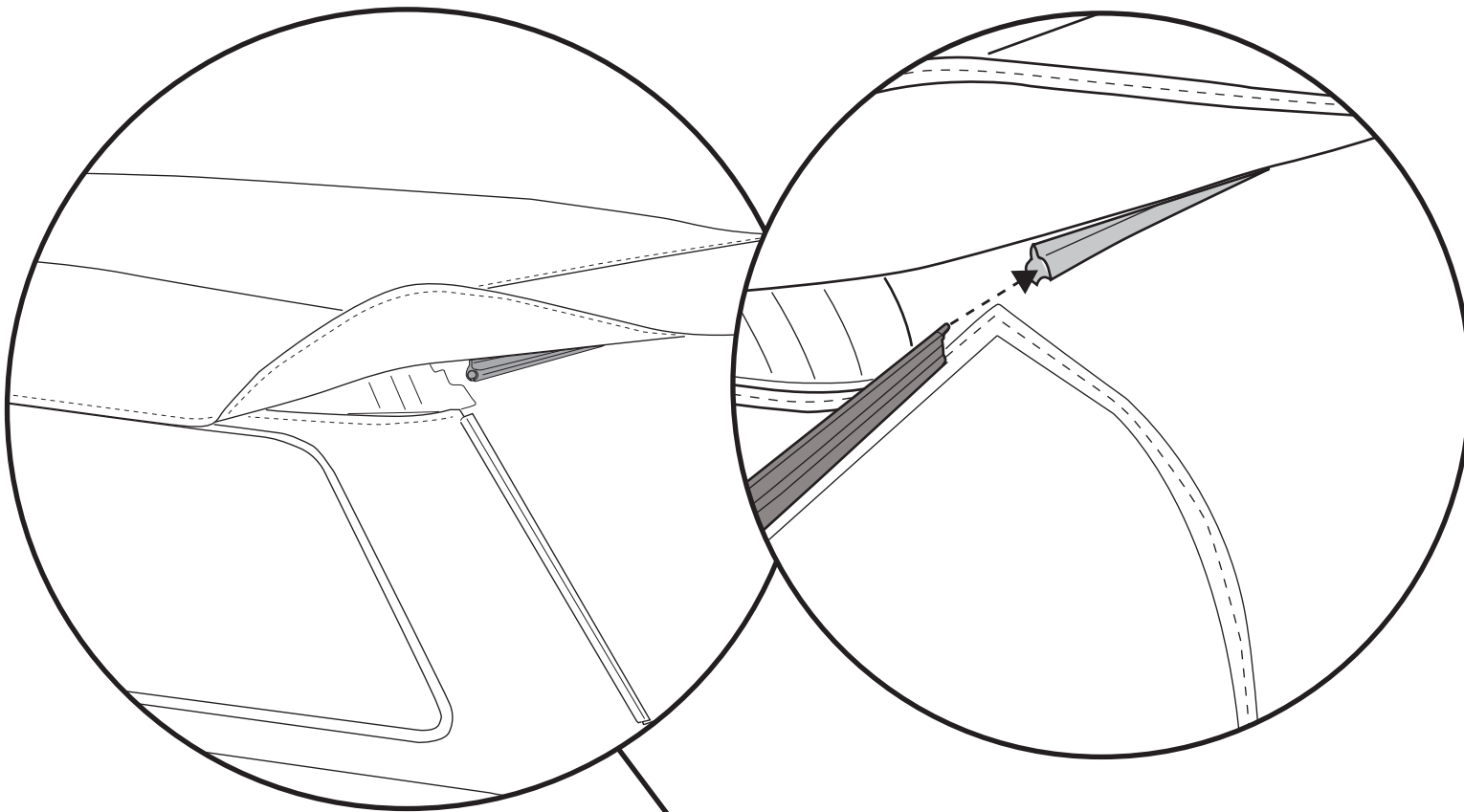

Fold the flap located on the driver side rear of the top back. Feed the plastic retainer strip on the top of the Rear Window into the plastic retainer strip on the rear of the top then slide the window all of the way across the top.

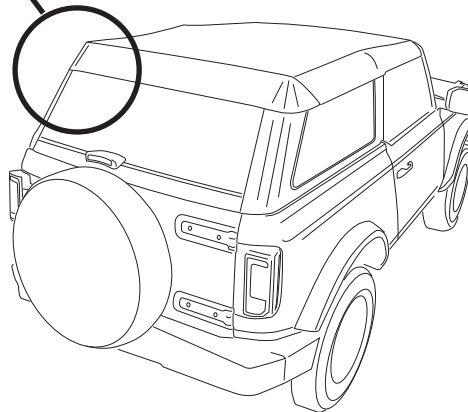

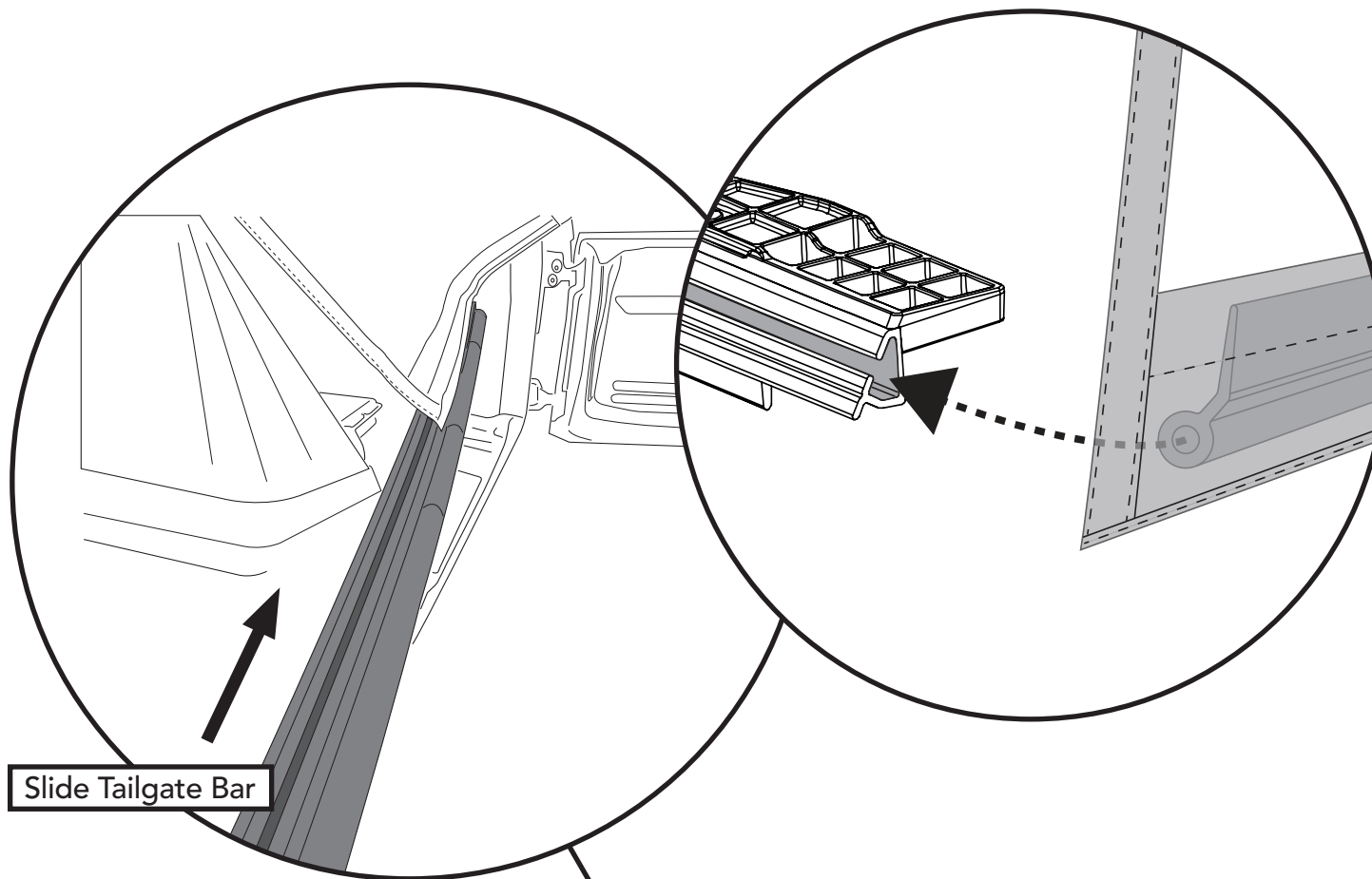

Open the tailgate. From the left side of the vehicle, pull the lower part of the rear window away from the side window. Locate the plastic retainer strip sewn to the bottom of the rear window then slide the channel of the tailgate bar into the plastic retainer strip.

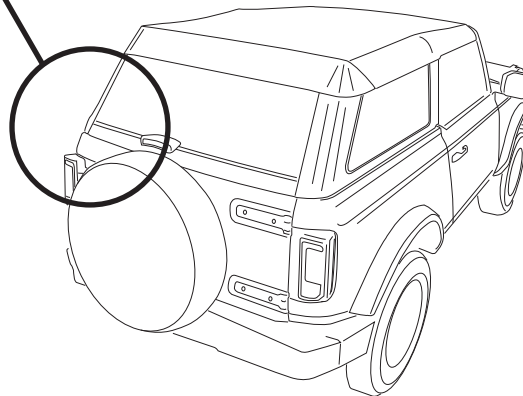
**Parts**

Taigate Retainer  
Part #597.67  
Qty. 1

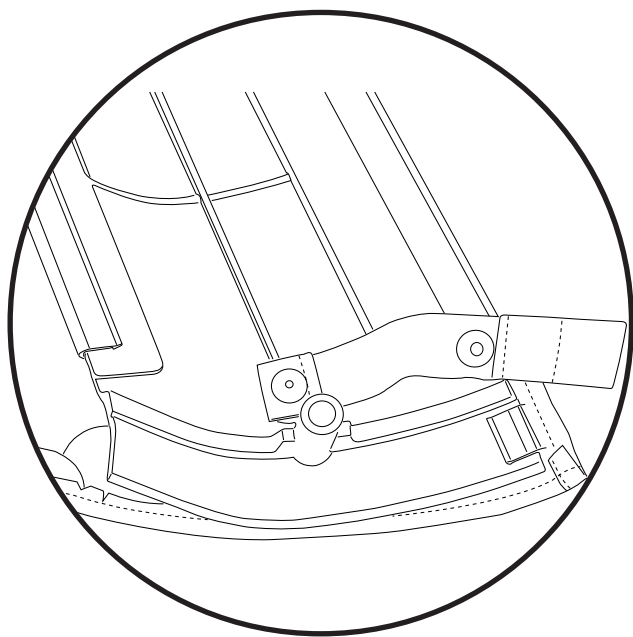

Lay the Side Panel flat with the inside facing up.

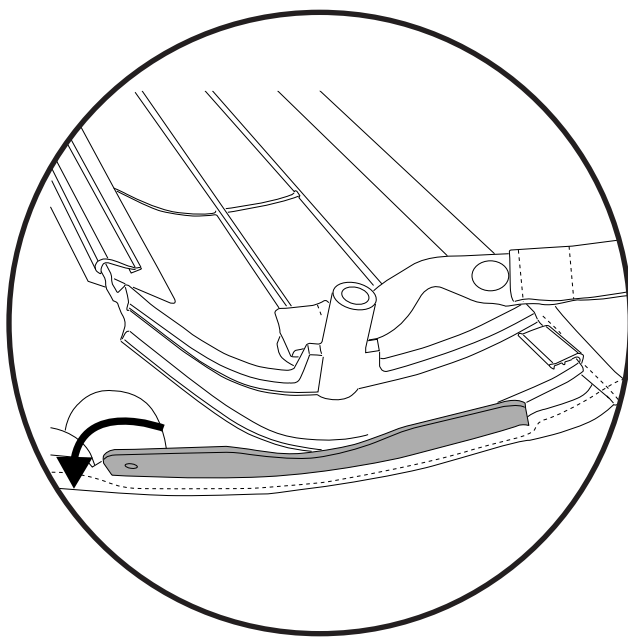

Pull out on the plastic retainer sewn in the bottom corner of the fabric.

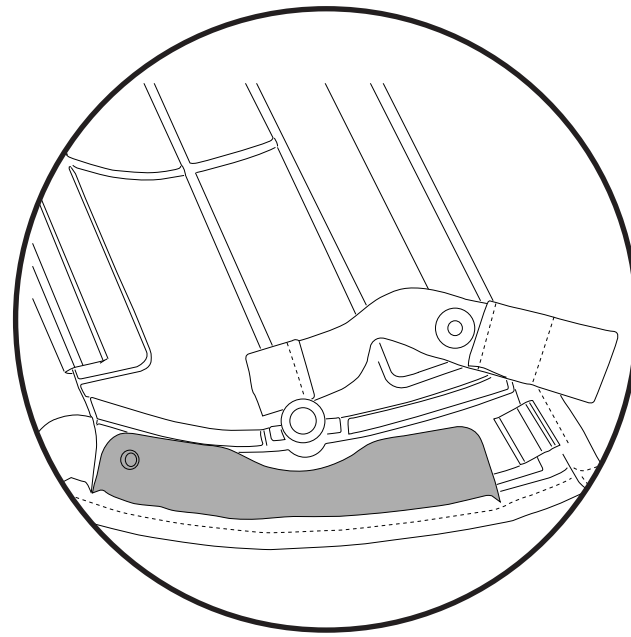

Place the plastic retainer over the molded corner.  
Repeat on the left side panel.

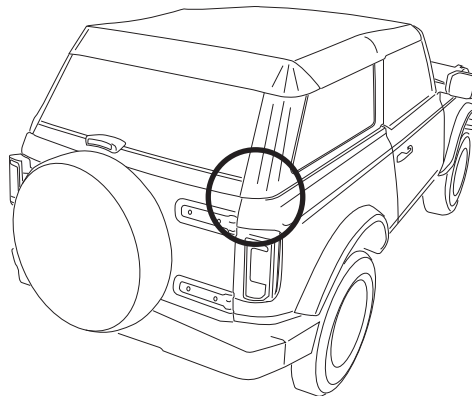

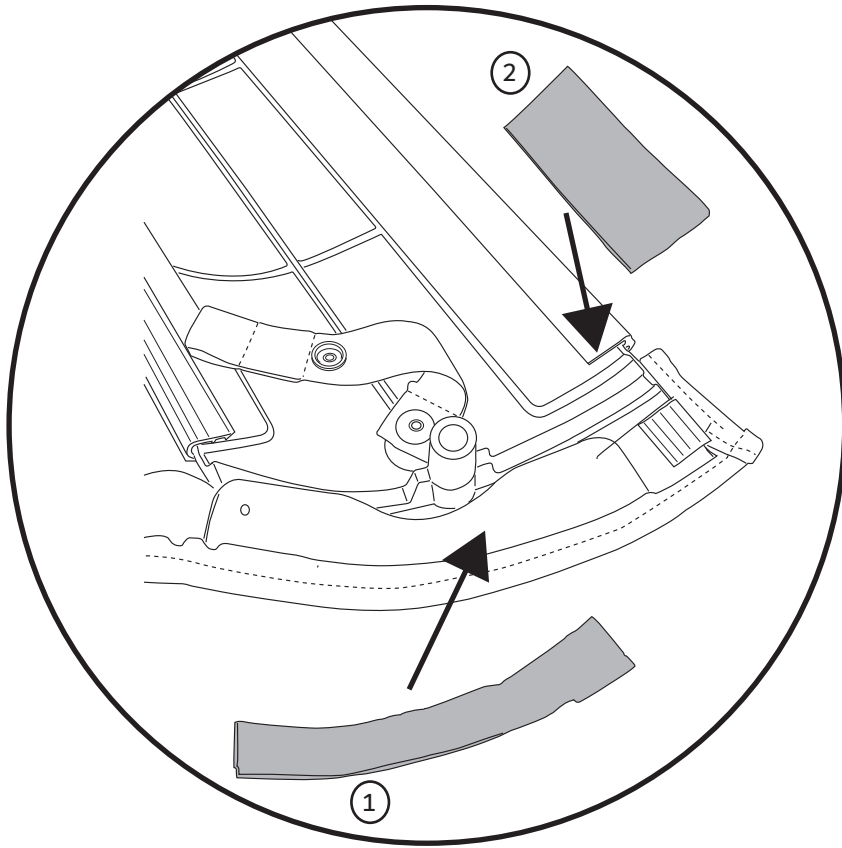

- ① Peel the protective paper from the back of the Quarter Window Retainer Foam Large (Part #615.68) then adhere it to the lower plastic retainer at the bottom corner of the right side panel.

- ② Peel the protective paper from the back of the Quarter Window Retainer Foam Small (Part #615.69) then adhere it vertically on the lower plastic retainer at the bottom corner of the right side panel.

Repeat this step on the Left Side Panel.

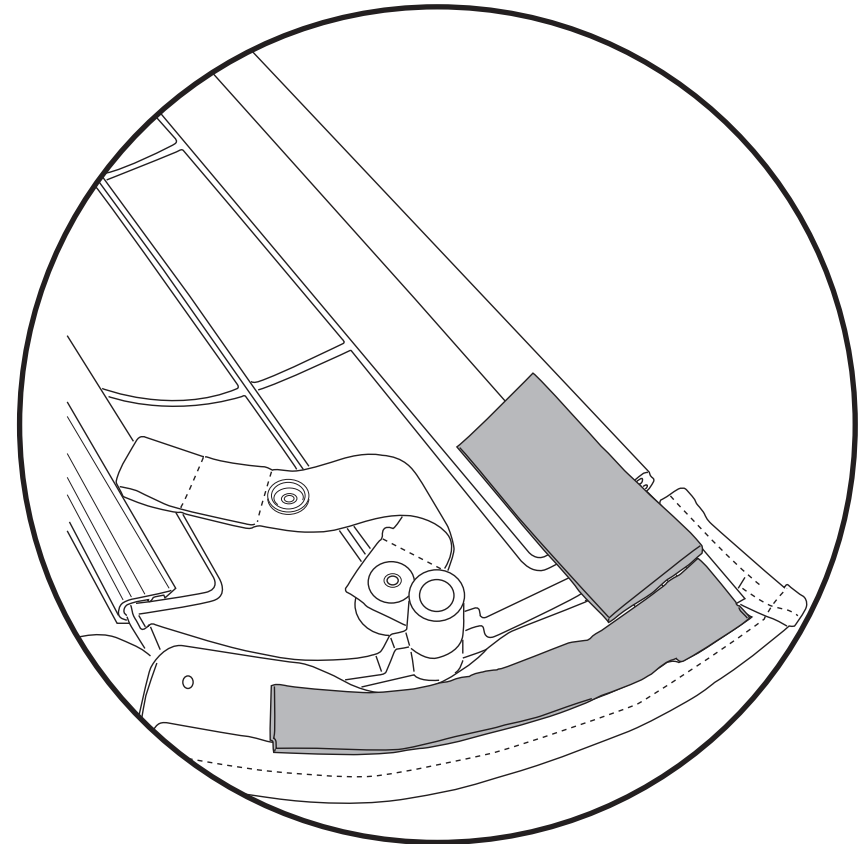
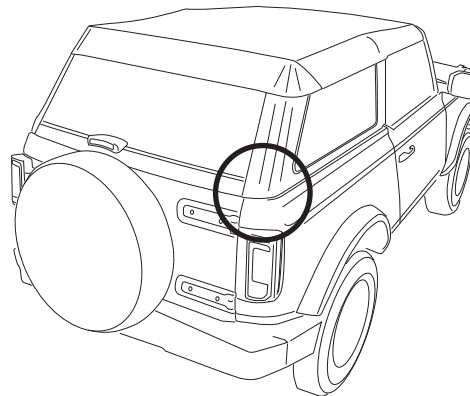

#### Parts



Quarter Window Retainer  
Foam Large  
Part #615.68  
Qty. 2



Quarter Window Retainer  
Foam Small  
Part #615.69  
Qty. 2

Step 1

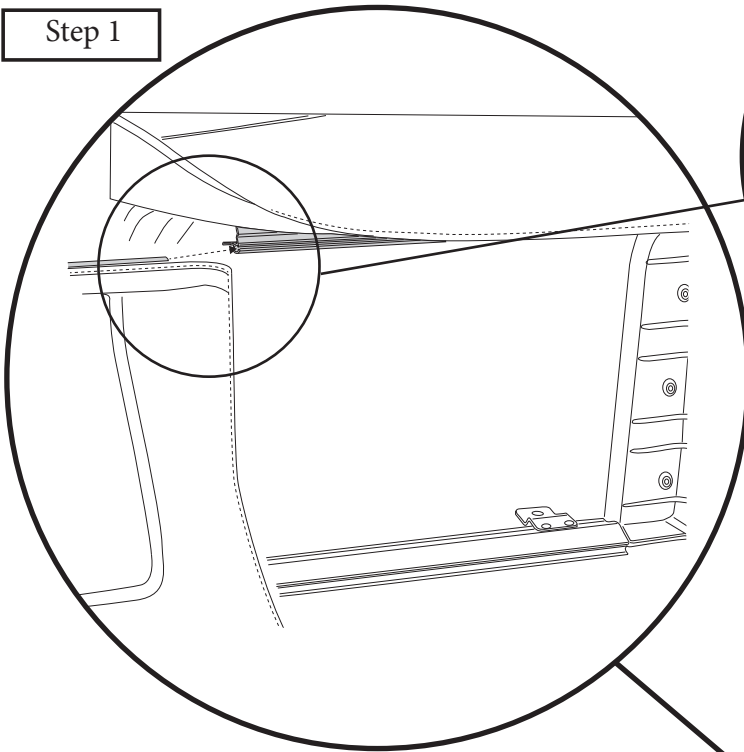

Fold the rear corner of the top then slide the plastic retainer strip on the quarter window into the "C" channel of the Upper Quarter Window Retainer.

Step 2

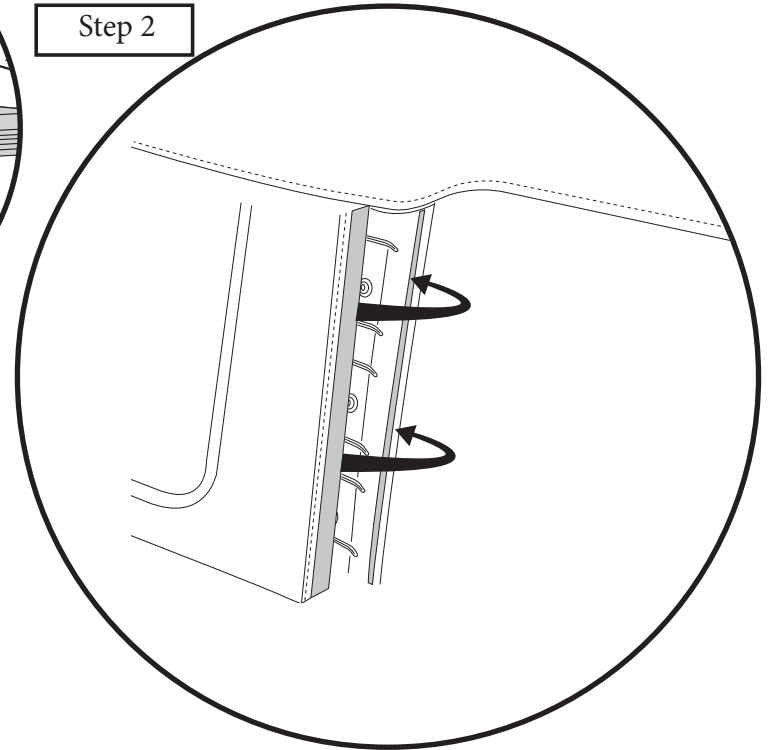

Tuck the plastic retainer into the Vertical window Retainer.

Repeat on the left side of the vehicle.

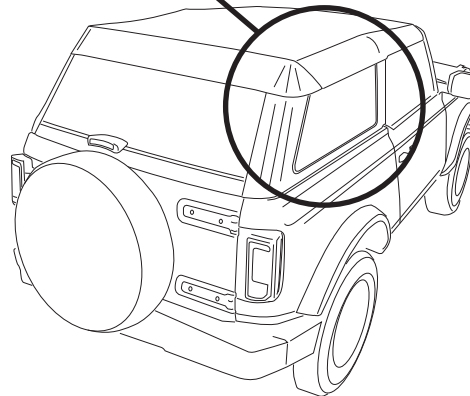

Step 3

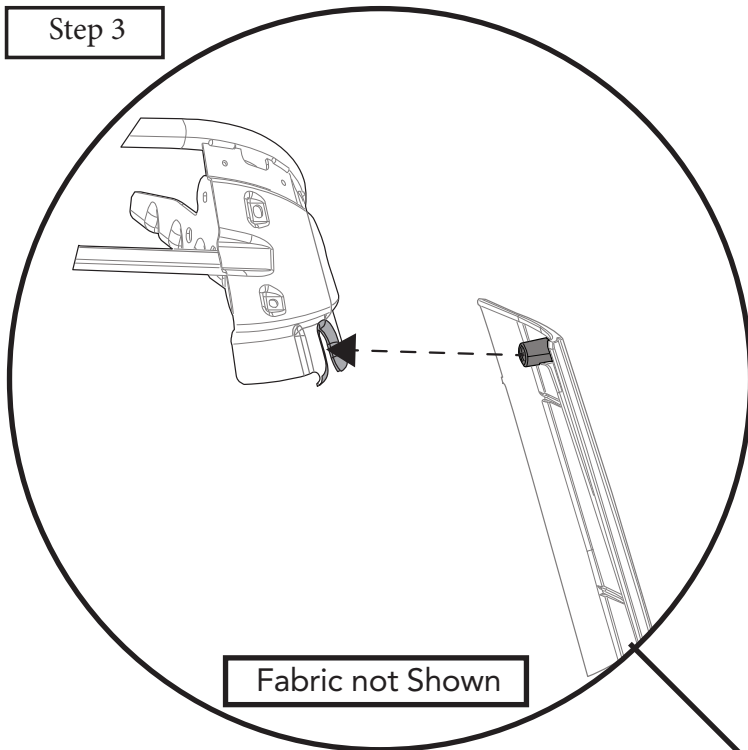

Place the button on the upper rear part of the Side Panel into the slot on the Rear Halo.

Step 4

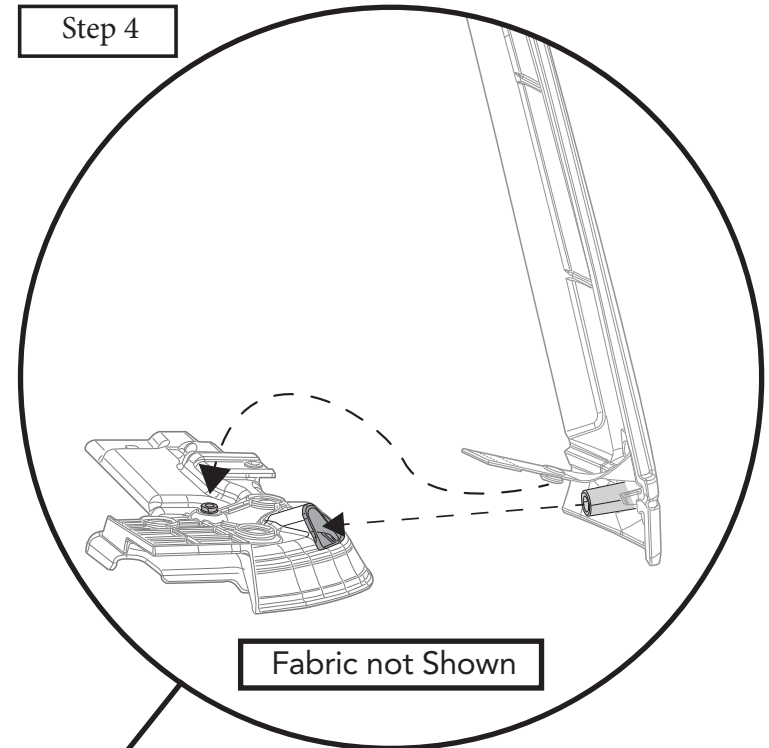

Place the button on the lower rear part of the Side Panel into the slot on the Tailgate Retainer then attach the snap strap.

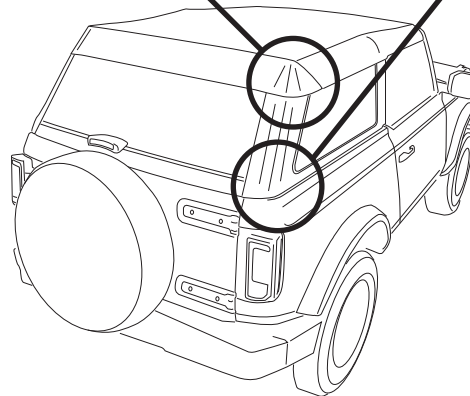

## Step 5

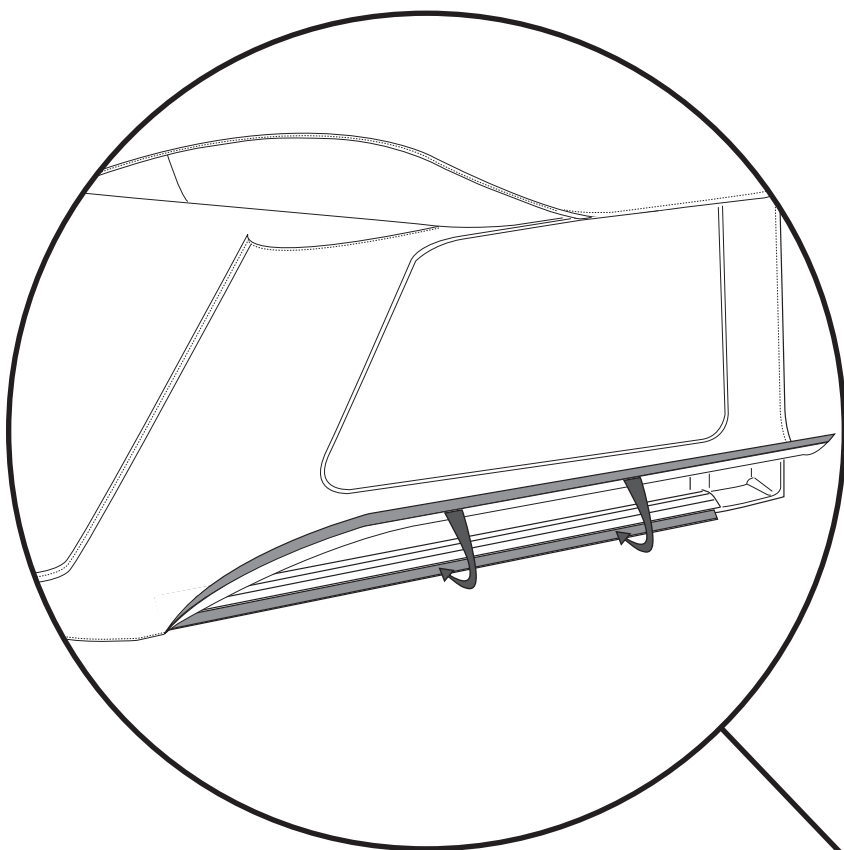

Tuck the plastic retainer along the bottom of the Side Panel into the Belt Rail Retainer.

Repeat steps 1 through 5 on the left side of the vehicle.

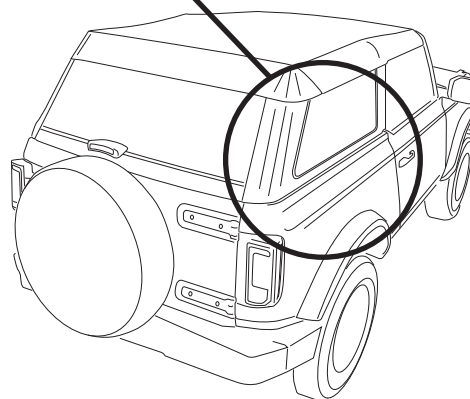



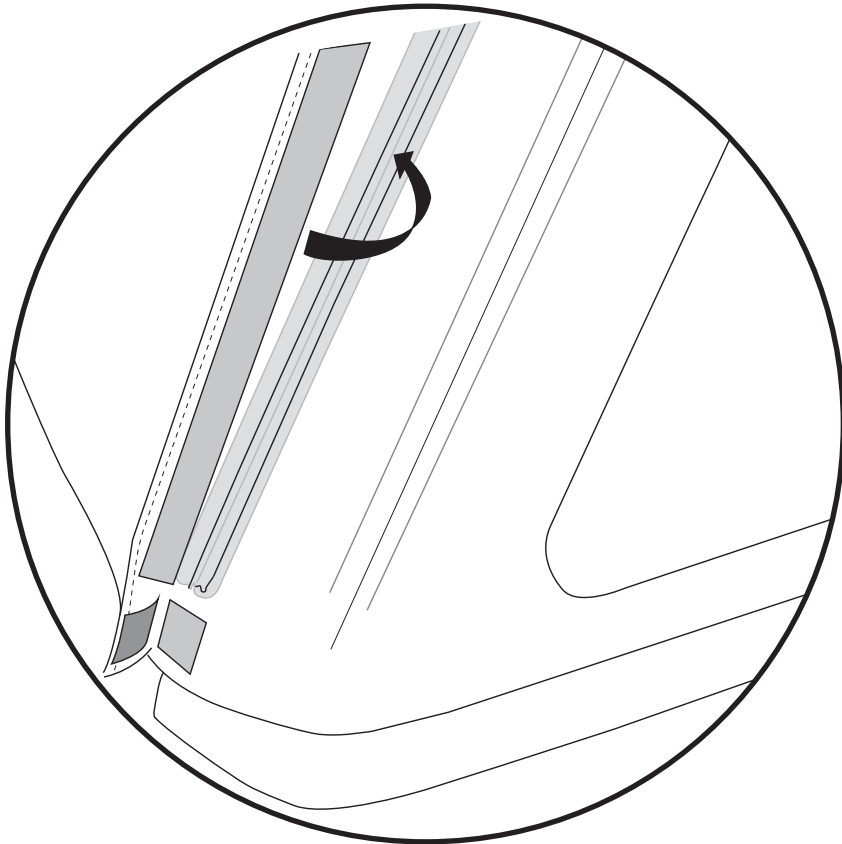

Tuck the plastic retainer along the side of the Rear Window into the plastic retainer that runs along the side of the Side Panel.

Repeat this step on the left side of the Rear Window.

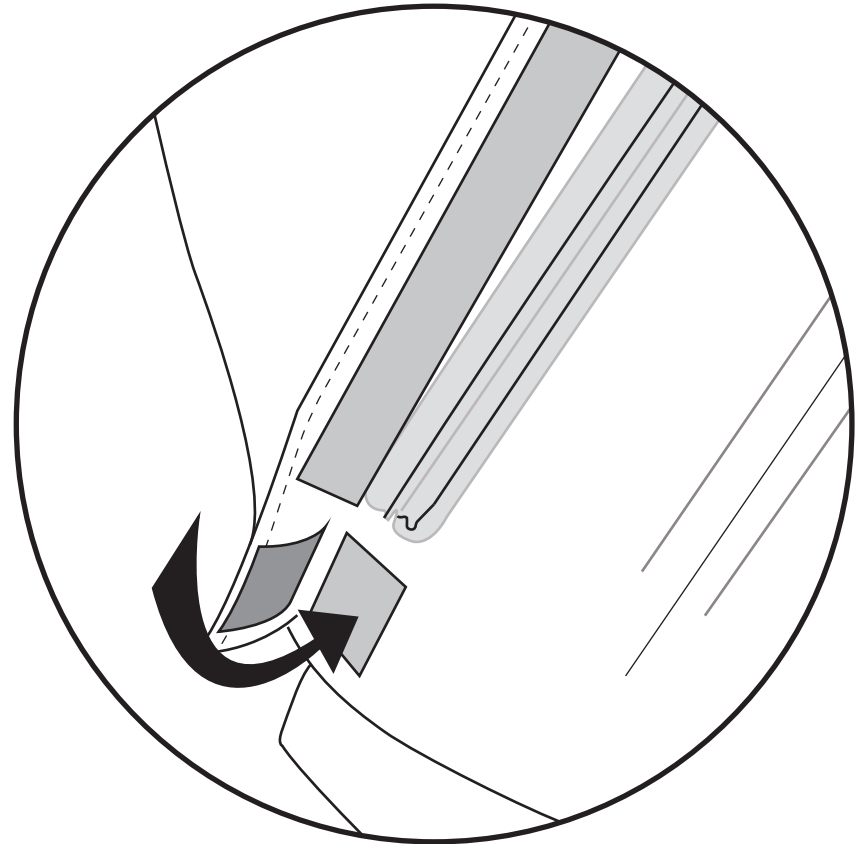

Join the Hook and Loop together at the bottom corners of the Rear Window and the Side Panels then close the tailgate.

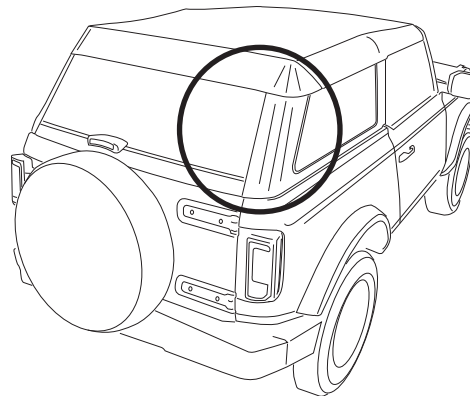

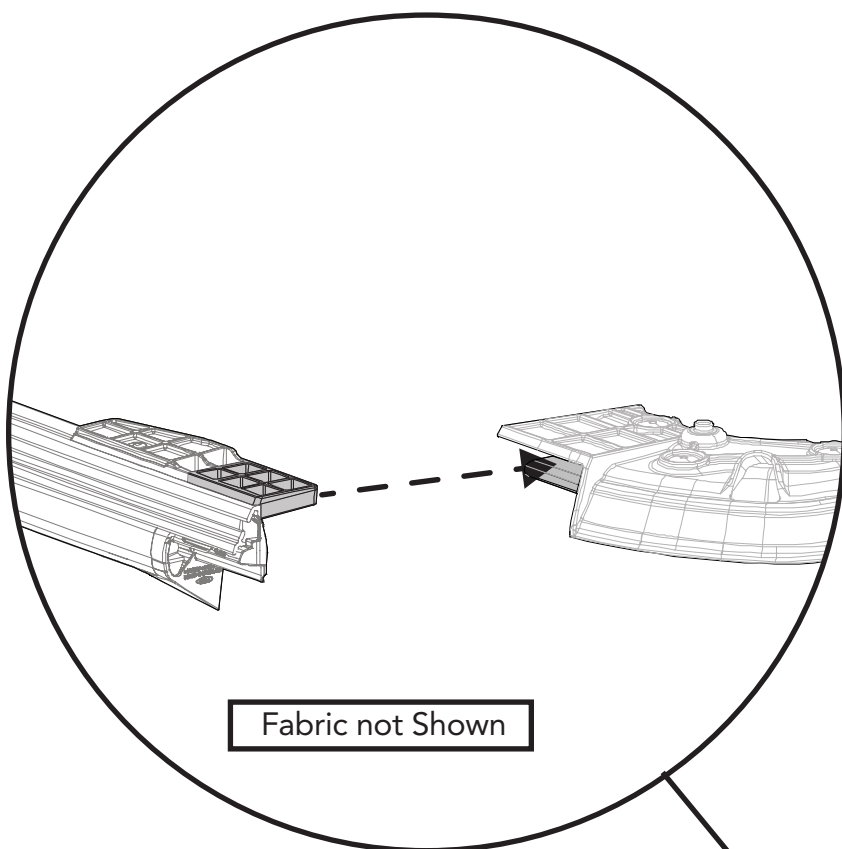

Slide the ends of the Tailgate Bar into the channels on the Tailgate Bar Retainers.

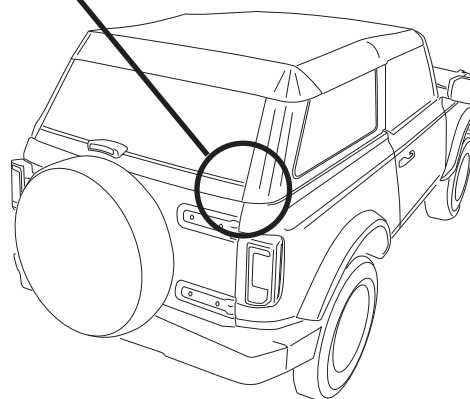

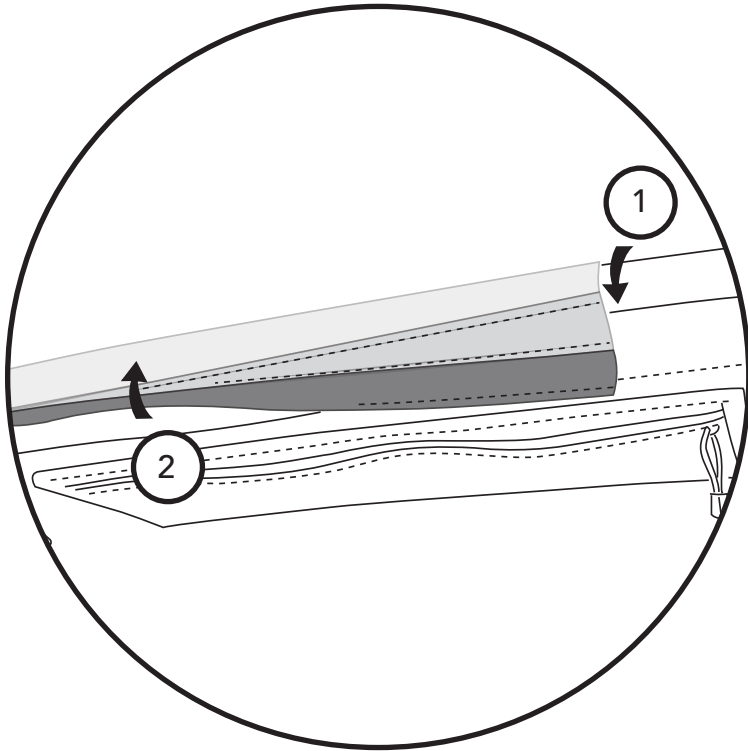

Wrap the flap around the 1.5 Bow as shown in the illustration.

Repeat this step on the #2 Bow.

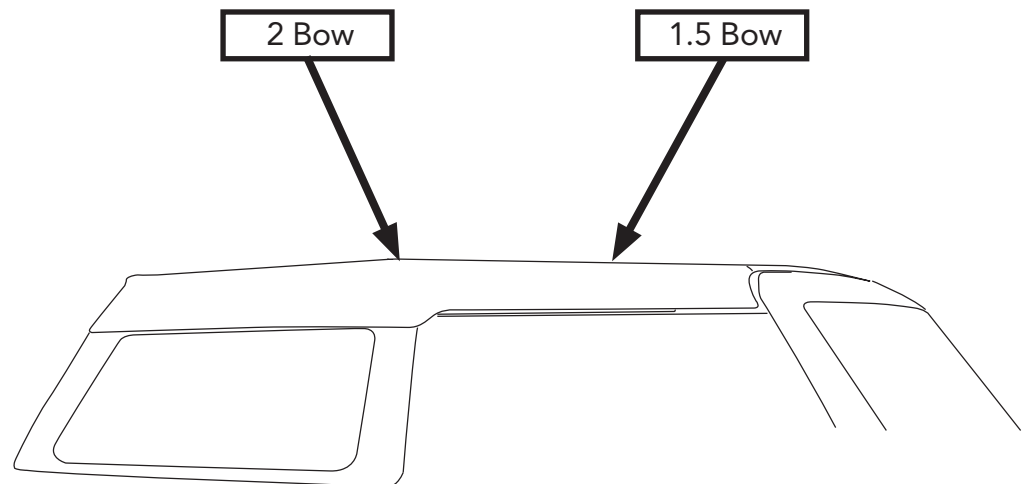

### Tip

Remember to reinstall the antenna.

## Congratulations

You have completed the installation of your Trektop. We hope you enjoy many years of service with your new top.

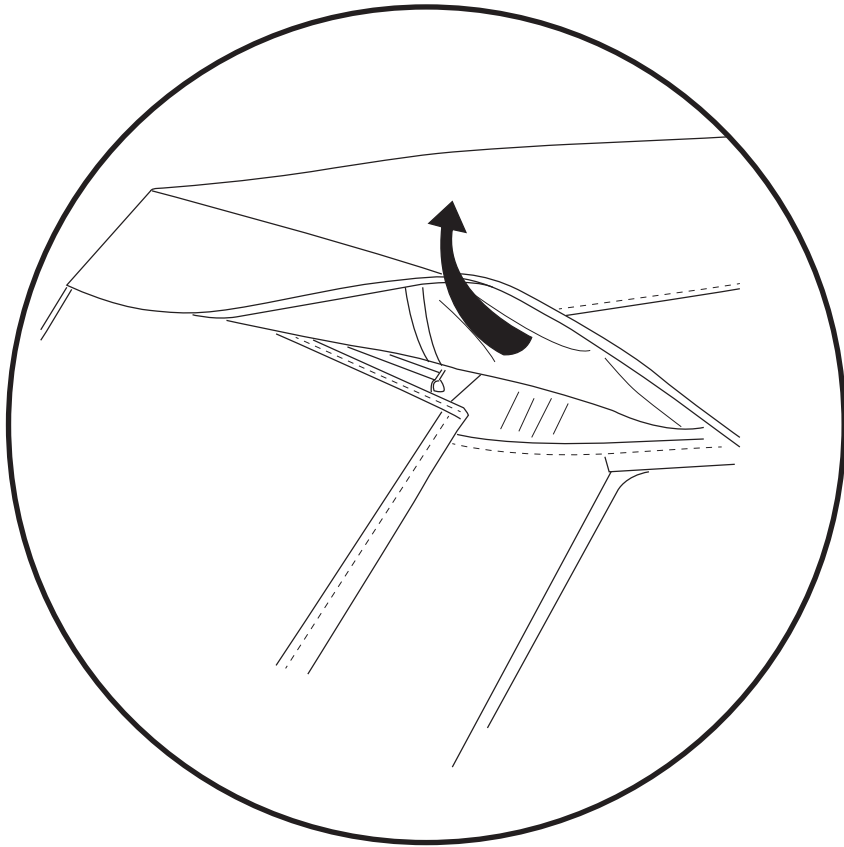

Fold the flap located on the right side rear of the top back.

Repeat this step on the left side of the vehicle.

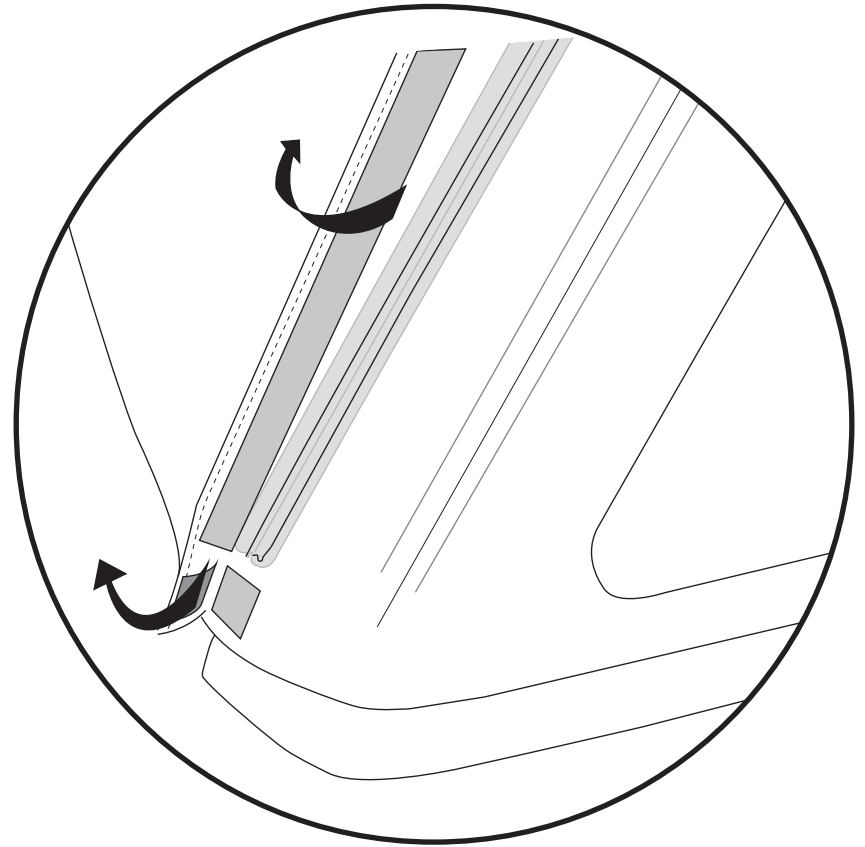

Peel the Hook from the Loop at the bottom corners of the Rear Window then peel the Rear Window vertical retainer from the Passenger Side Panel vertical retainer.

Repeat this step on the left side of the vehicle.

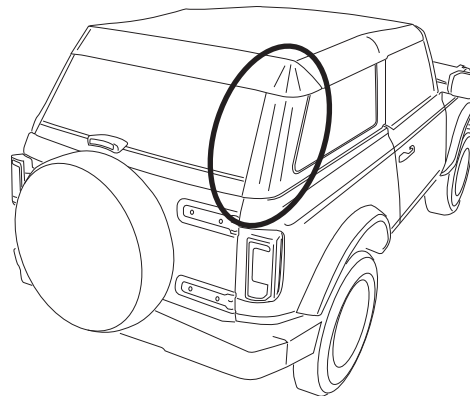



Open the Tailgate then pull back on the Tailgate Bar.

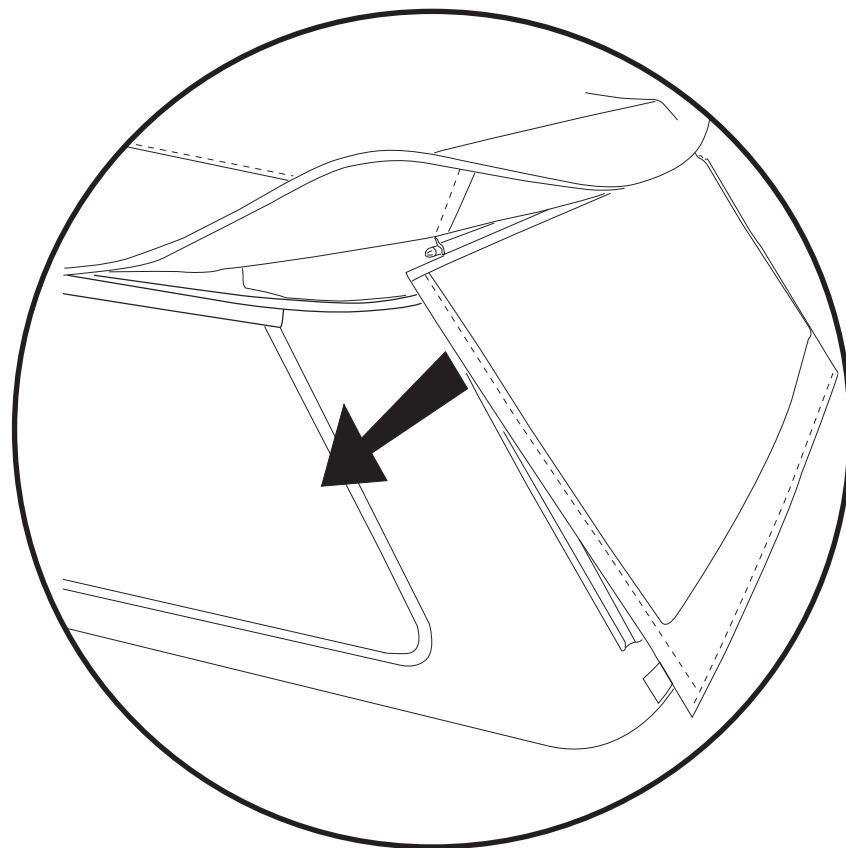

Slide the Rear Window toward the left side of the vehicle.

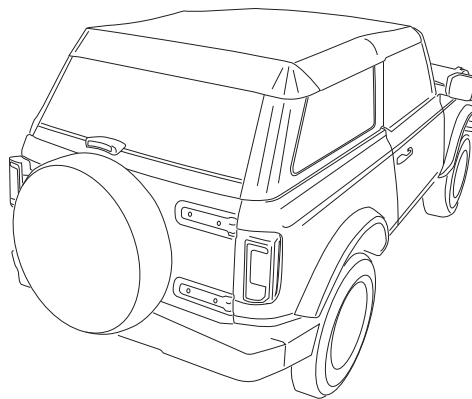

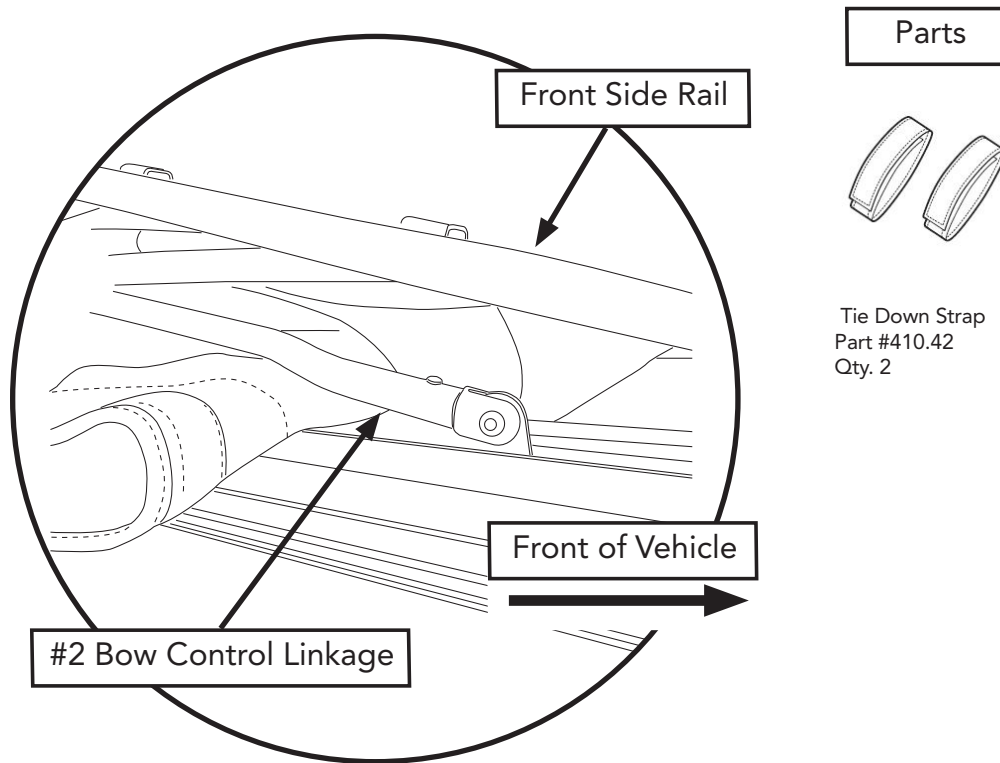

Open the top.

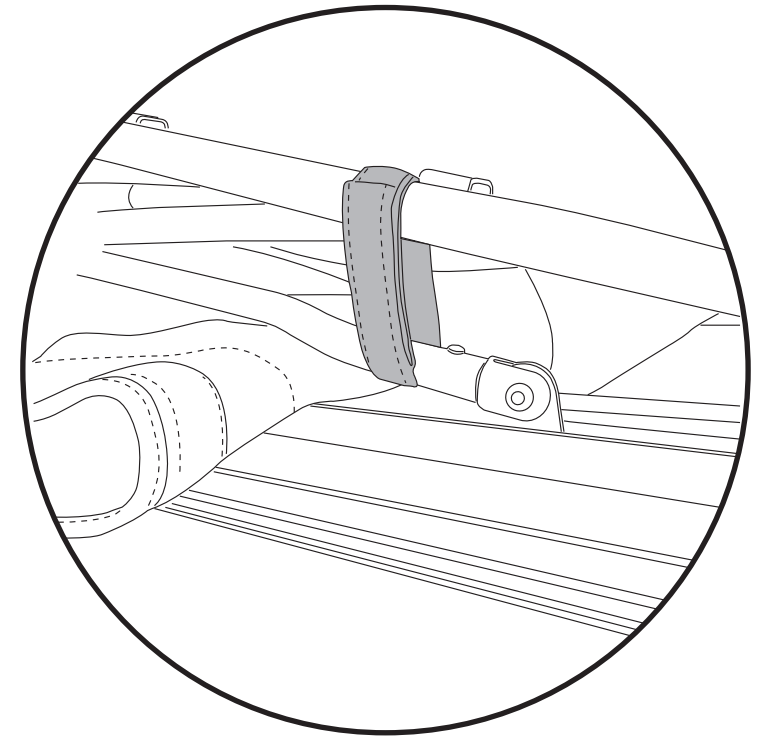

Wrap the Tie Down Strap around the #2 Bow Control Linkage and the Front Side Rail.

Repeat on the driver side of the vehicle.

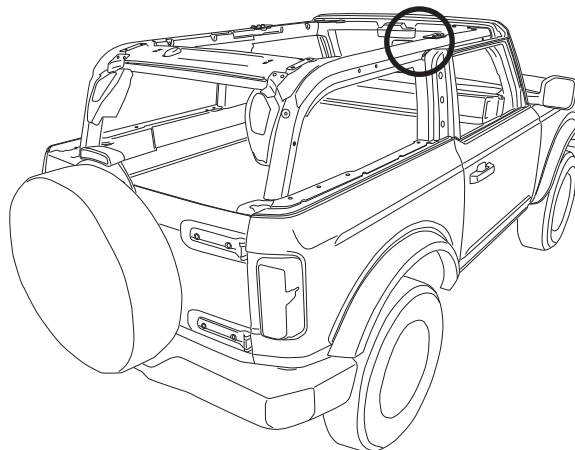



## Care and Maintenance of your Bestop Product

Your Bestop product is made of the finest materials available. To keep it looking new and for the maximum possible wear, it will need periodic cleaning and maintenance.

**Fabric:** The fabric should be washed often using soap, warm water and a soft bristle brush. Rinse with clear water to remove all traces of soap. Bestop recommends using Bestop Cleaner (part no. 11201-00) and Bestop Protectant (part no. 11202-00) for Vinyl fabric and Bestop Twill Protectant (part no. 11207-00) for Twill fabric. Bestop Cleaner and Bestop protectant are specially formulated to provide a total cleaning and protection system. Bestop Cleaner safely removes the toughest stains, will not harm vehicle finishes, is biodegradable and environmentally friendly. Bestop Protectant protects against UV-fading, cracking and hardening, and repels dust, grease, dirt and mildew.

**Windows:** Keep windows clean to avoid scratching. DO NOT use a brush on the windows! Wash with a water-soaked cloth or sponge and a mild dishwashing detergent. Bestop recommends Bestop Vinyl Window Cleaner (part no. 11203-00), which safely cleans and protects vinyl windows and helps prevent UV damage. NEVER WIPE THE WINDOWS WHEN THEY ARE DRY. Be careful when cleaning snow or frost from the vinyl windows since they are easily scratched and may crack at low temperatures. DO NOT roll the sides or rear window in cold weather. The windows become stiff and will crack. Cracks caused by misuse in cold temperatures are not covered under warranty.

**Water:** Seeping through at the seams may be stopped by applying 3-M Scotchgard® on the inside of the seams.

**Snap:** Keep snaps cleaned and lubricated with silicone to help prevent snaps from sticking to the studs. If a snap does become stuck to a stud, use a screwdriver and GENTLY pry apart to prevent permanent damage to the snap or the top fabric.

**Zippers:** Keeping zippers cleaned and lubricated with Bestop's Zipper Cleaner (part no. 11206-00) will help prevent damage and keep the zippers in smooth working condition. If a zipper opens behind the slider, the slider may have been spread apart. This problem can usually be repaired by using an ordinary pair of pliers to bring the sides back into parallel. Return slider to the end of the zipper in the normal Open position. Squeeze lightly at first and test the zipper. If the zipper continues to remain open squeeze more firmly with the pliers and try the zipper again. Repeat this procedure until the zipper operates correctly.

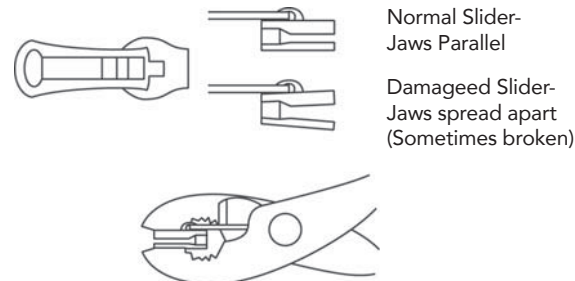

**For Bestop Warranty Information, Please go to;**  
<https://www.bestop.com/help/warranty-information/>

